

减速器和差速器/REDUCTION & DIFFERENTIAL

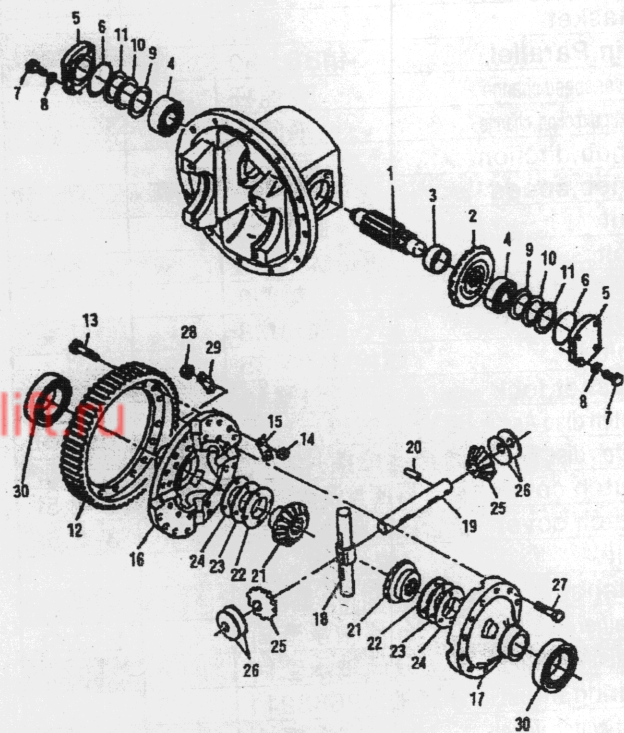

序号 Item No.	图号 Part No.	零部件名称 Description	件数 Q'ty	备注 Remark
01	YDS30.070	Shaft,final pinion gear 终端斜齿轮轴	1	
02	YDS30.071	Gear,spiral wheel 螺旋伞齿轮	1	
03	YDS30.086	Spacer 衬套	1	
04	GB297-64	Bearing,taper roller 圆锥滚子轴承	2	
05	YDS30.087	Cover,bearing 轴承盖	2	
06	GB1235-76	O-ring O形圈75×3.1	2	
07	GB5786-86	Bolt 螺栓M10×1.25×25	8	
08	GB93-87	Washer,spring 弹簧垫圈10	8	
09	YDS30.090	Shim 垫片	2	
10	YDS30.090	Shim 垫片	2	
11	YDS30.090	Shim 垫片	2	
12	YDS30.073	Gear,ring 齿圈	1	
13	YDS30.077	Bolt 螺栓	16	
14	GB6171-86	Nut 螺母M10×1.25	16	
15	YDS30.088	Plate,lock 锁片	8	
16	YDS30.074	Case,cross R.H. 右差速器壳	1	
17	YDS30.075	Case,cross L.H. 左差速器壳	1	
18	YDS30.080	Shaft,pinion 齿轮轴(I)	1	
19	YDS30.081	Shaft,pinion 齿轮轴(II)	1	
20	GB119-76	Pin parallel 圆柱销6d×30	1	
21	YDS30.085	Gear,side 半轴齿轮	2	
22	YDS30.079	Washer 垫圈	2	
23	YDS30.079	Washer 垫圈	2	
24	YDS30.079	Washer 垫圈	2	
25	YDS30.083	Gear,pinion 行星齿轮	4	
26	YDS30.084	Washer,thruet 止推垫片	4	
27	YDS30.076	Bolt 螺栓	12	
28	GB52-76	Nut 螺母M10×1.25	12	
29	YDS30.078	Washer,lock 锁紧垫片	6	
30	GB276-64	Bearing,ball 单列向心球轴承213	2	

