

转向桥/STEERING AXLE

序号 Item No	图号 Part No	零部件名称 Description	件数 Q'ty	备注 Remark
01	M1534301000	Axle ass'y 转向桥体总成	1	
02	M1534302000	Link 连杆	2	
03	M1534303000	Power cylinder ass'y 转向油缸总成	1	
04	M1534301001	Rubber 减震块	2	
05	M3036101201	Bracket 转向固定座	2	
06	M1534301400	Knuckle R.H. ass'y 右转向节总成	1	
07	GB/T301-93	Bearing 推力轴承51208	2	
08	GB290-89	Bearing 滚针轴承943/32	4	
09	M1534301003	Pin,king 转向节主销	2	
10	GB119-86	Pin 销B10×20	2	
11	M1534303004	Shim 调整垫	4	
12	GB9877.1-88	U-ring U型密封圈B85×110×12D	2	
13	M1534301005	Shim 转向节调整垫	2	
14	GB6172-86	Nut 螺母M12	18	
15	M1534301006	Cap 防尘罩	2	
16	GB297-84	Bearing 轴承7211E	2	
17	GB297-84	Bearing 轴承7207E	2	
18	GB6170-86	Nut 螺母M30×2	2	
19	GB97.1-85	Washer 垫圈30	2	
20	GB92-86	Pin 销6.3×55	2	
21	M1534301007	Cap 轮毂盖	2	
22	M1534301008	Hub 轮毂	2	
23	M1534301009	Pin 紧固销	2	
24	GB6171-86	Nut 螺母M10×1.25	2	
25	GB6170-86	Nut 螺母M16	4	
26	M1534301010	Bushing 衬套	2	

FD10,15,18(T)-MW
 FD10,15,18(T)-MG
 FG(L)10,15,18(T)-MG
 FG(L)10,15,18(T)-MW

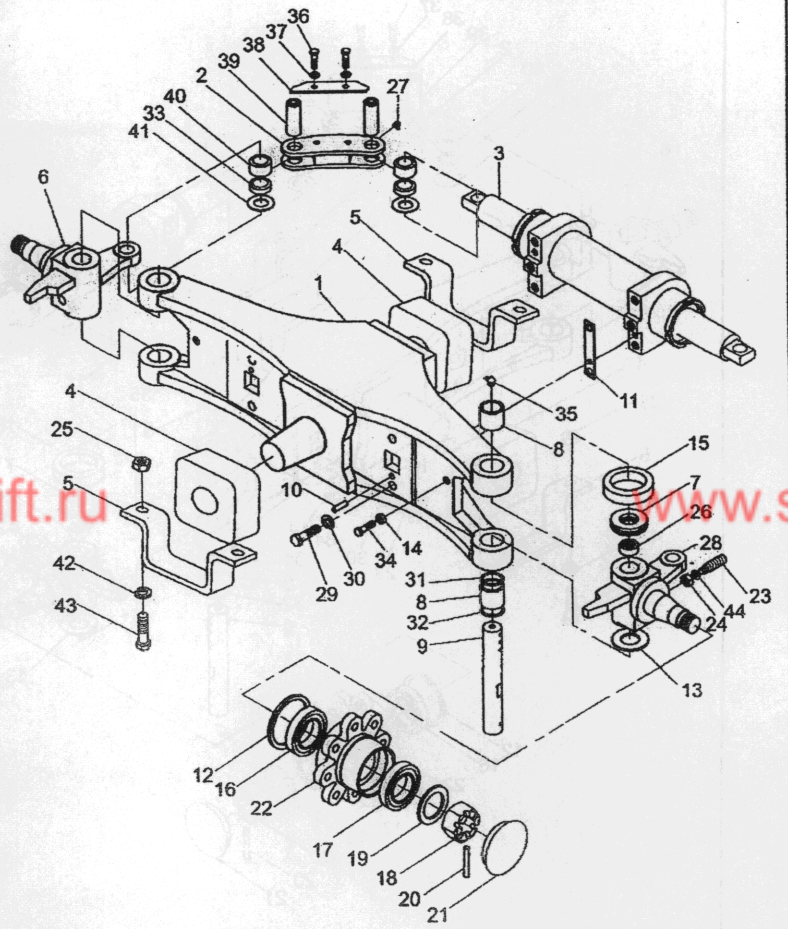

转向桥/STEERING AXLE

FD10,15,18(T)-MW
FD10,15,18(T)-MG
FG(L)10,15,18(T)-MG
FG(L)10,15,18(T)-MW

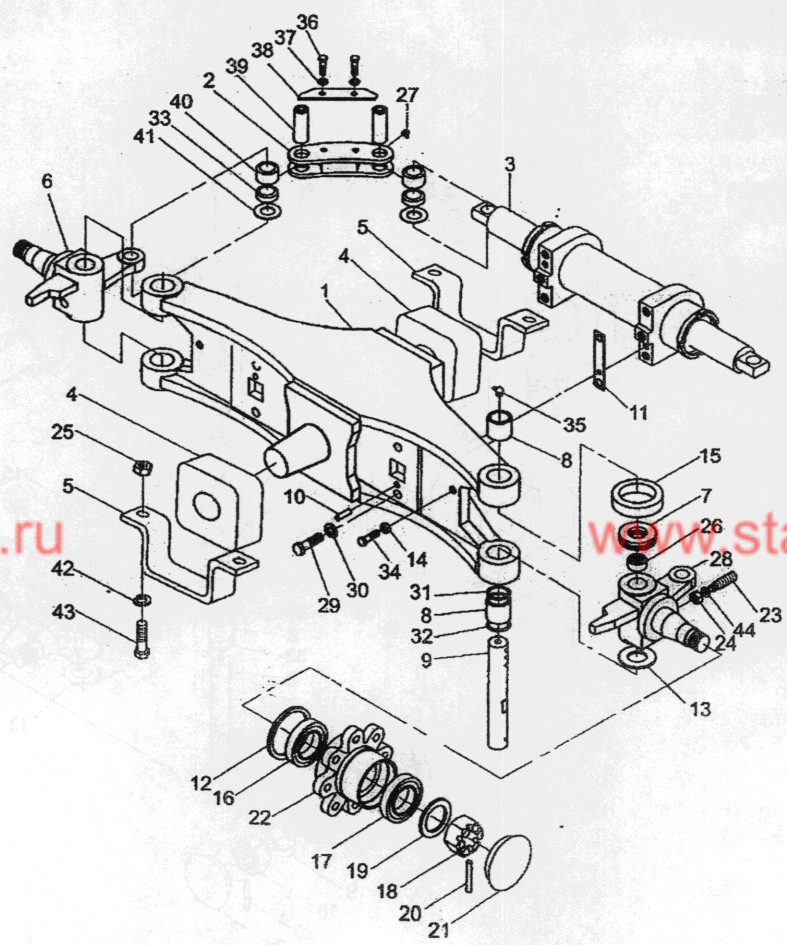

序号 Item No	图号 Part No	零部件名称 Description	件数 Q'ty	备注 Remark
27	ZBT33001.1-88	Fitting grease 直通式滑脂嘴M6	4	
28	M1534305000	Knuckle R.H.ass'y 左转向节总成	1	
29	GB5782-86	Bolt 螺栓M14×45	4	
30	GB93-87	Washer,lock 垫圈14	4	
31	M1534301013	O-ring O形圈	2	
32	M1534301011	Sealo,oil 油封	2	
33	M1534301012	Bushing 衬套	4	
34	GB5782-86	Bolt 螺栓M12×30	2	
35	ZBT33001.2-88	Fitting grease 弯颈式滑脂嘴Z1/8"	2	
36	GB5780-86	Bolt 螺栓M8×18	4	
37	GB93-87	Washer,lock 垫圈8	4	
38	M1534301014	Baffle 挡板	2	
39	M1534301015	Pin 连杆销	4	
40	M1534301017	Bearing ES型向心关节轴承	4	
41	M1534301016	Shim 调整垫	4	
42	GB93-87	Washer,lock 垫圈16	4	
43	GB5782-86	Bolt 螺栓M16×55	4	
44	GB97.1-85	Bolt 垫圈10	2	



转向轮/STEERING WHEEL

序号 Item No	图号 Part No	零部件名称 Description	件数 Q'ty	备注 Remark
01	M1534401000	Rim,inside 内轮辋	2	
02	GB/T2982	Tire 轮胎5.00-8-8PR	2	
03	M1534402000	Rim,outside 外轮辋	2	
04	GB5782-86	Bolt 轮毂螺栓	16	
05	GB6172-86	Nut 轮毂螺母	16	
06	GB5782-86	Bolt 轮辋螺栓	16	
07	GB6172-86	Nut 螺母M12	16	
08	GB93-87	Washer 垫圈12	16	

FD10,15,18(T)-MW
 FD10,15,18(T)-MG
 FG(L)10,15,18(T)-MG
 FG(L)10,15,18(T)-MW

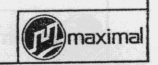
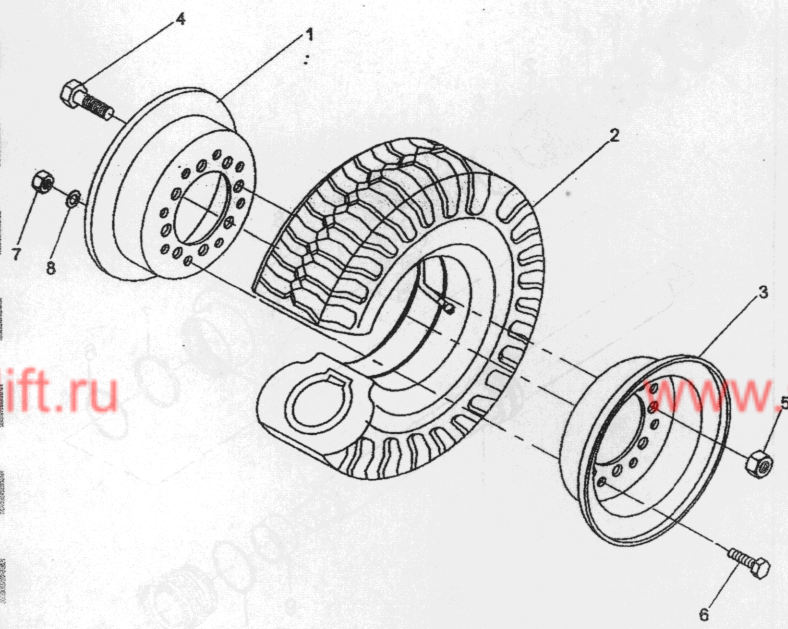

FD10,15,18(T)-MW
 FD10,15,18(T)-MG
 FG(L)10,15,18(T)-MG
 FG(L)10,15,18(T)-MW

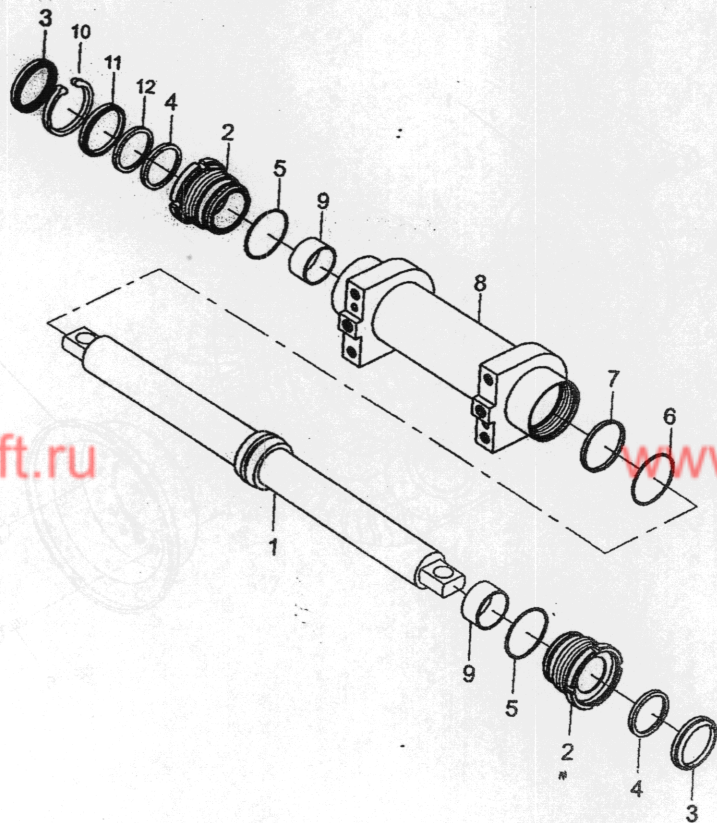

序号 Item No	图号 Part No	零部件名称 Description	件数 Q'ty	备注 Remark
A	M1534303000	Power cylinder	转向油缸总成	1
01	M1534303200	Piston rod ass'y	活塞杆总成	1
02	M1534303201	Cap	缸盖	2
03	M1534303202	Seal,dust	防尘圈	2
04	U-50×60×8	U-ring	U密封圈50×60×8	2
05	GB3452.1-92	O-ring	O形圈63×3.55	2
06	GB3452.1-92	O-ring	O形圈60×3.55	1
07	M1534303203	Seal,slipper	支撑环	1
08	M1534303100	Body,power steering	缸筒总成	1
09	M1534303001	Bearing	钢背轴承5030	2
10	GB893.1-86	Snap ring	挡圈72	2
11	M1534303002	Ring	挡环	2
12	DP-50×60×3	Snap shim	挡片50×60×3	2

