

图 43. 门架管路系统

CPC(D)20,25,30 CPC(D)30A

FIG43. HYDRAULIC SYSTEM MAST (NORMAL MAST KM)



图 43. 门架管路系统

FIG43. HYDRAULIC SYSTEM MAST (NORMAL MAST KM)

序号 Item No	图号 Part No	零部件名称 Description	件数 Q'ty	备注 Remark
A	CKM01-SH015	门架管路系统 Mast hydraulic system	1	
1	HG4-404-82	塑料回油管 $\phi 12 \times L$ Tube	1	见选用表
2	HG4-404-82	vinyl	1	见选用表
3	CKM01-25901	塑料回油管 $\phi 12 \times L$ Tube	1	
4	HG4-404-82	vinyl 回油接头 Three way	1	
		塑料回油管 $\phi 12 \times 1100$ Tube		
5	TG2002-13050	vinyl	1	
6	CKM01-03301	高压胶管 $\phi 13 \times 500$ Hose	1	
7	CKM01-03401	H.P	1	
8	TG2002-13009	限速阀 Flow regulator	1	
9	CKM01-03501	三通接头总成 Three way	1	
10	CKM01-41501	高压胶管 $\phi 13 \times 390$ Hose	4	
11	CKM01-41401	H.P	4	
12	CKM01-41601	切断阀 Valve check	6	
13	GB982-77	卡箍 Clip	1	
		回油管管夹片 Band		
		双钢丝卡箍 10-16 Clip		
		组合垫圈 22 Washer		

图 43 门架管路系统 CPC(D)20,25,30 CPC(D)30A

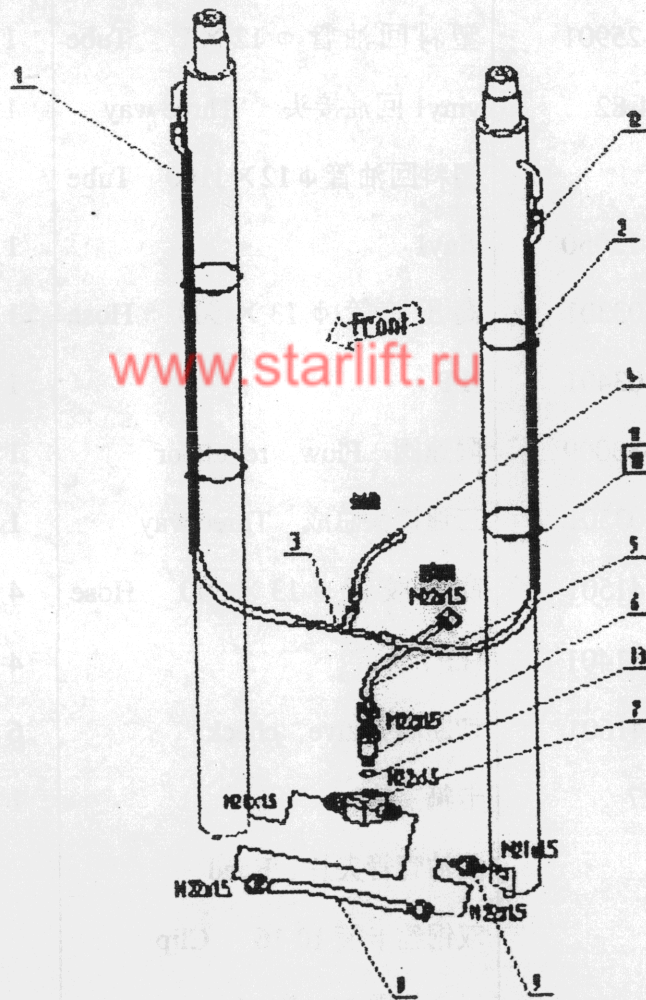
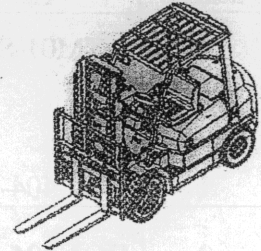
FIG44. HYDRAULIC SYSTEM MAST (NORMAL MAST KM)



图 43 门架管路系统 CPC(D)20,25,30 CPC(D)30A

FIG43. HYDRAULIC SYSTEM MAST (NORMAL MAST KM)

管路系统选用件 Mast Piping Optional Parts					
起升高 度 LIFTING HEIGHT	件 1 塑料回油管长度 PLASTIC HOSE		件 2 塑料回油管长度 PLASTIC HOSE		备注 Remark
	图号	长 度	图号 Part	长 度	
	Part No	LENGTH	No	LENGTH	
KM200	CKM01-13101	900	CKM01-15101	1000	标 准 (STD)
KM250	CKM01-13201	1100	CKM01-15201	1200	
KM270	CKM01-13301	1200	CKM01-15301	1300	
KM300	CKM01-13001	1350	CKM01-15001	2500	
KM330	CKM01-13401	1500	CKM01-15401	1600	
KM350	CKM01-13501	1600	CKM01-15501	1700	
KM370	CKM01-13601	1700	CKM01-15601	1800	
KM400	CKM01-13701	1900	CKM01-15701	2000	
KM425	CKM01-13801	2000	CKM01-15801	2100	
KM450	CKM01-13901	2150	CKM01-15901	2300	
KM475	CKM01-14001	2300	CKM01-16001	2400	
KM500	CKM01-14101	2400	CKM01-16101	2500	
KM550	CKM01-14201	2700	CKM01-16201	2800	
KM600	CKM01-14301	2950	CKM01-16301	3100	

图 44 外门架

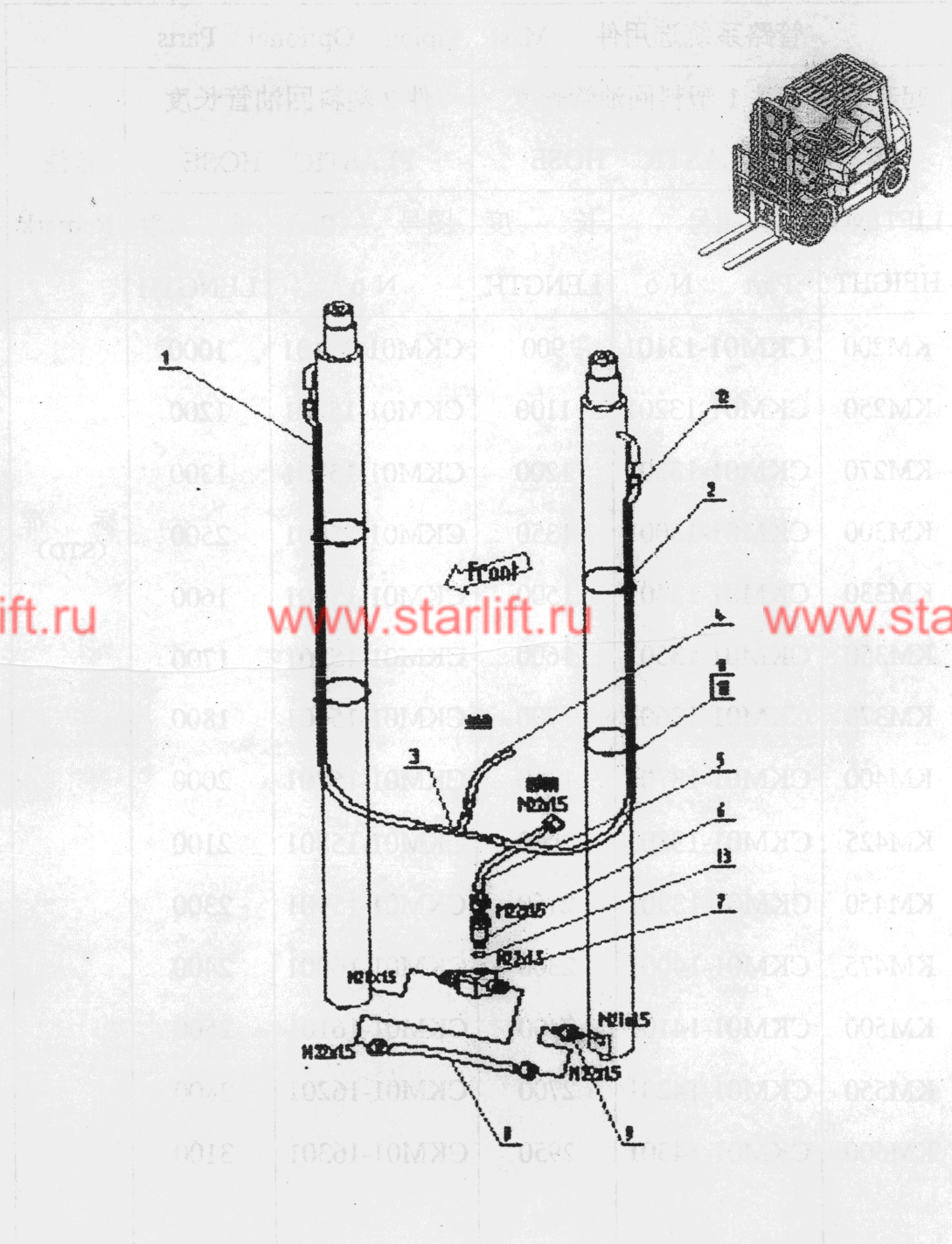
CPC(D)20,25,30 CPC(D)30A

FIG.44. OUTER MAST (NORMAL MAST KM)



图 44 外门架

FIG.44. OUTER MAST (NORMAL MAST KM)

序号 Item No	图号 Part No	零部件名称 Description	件数 Q'ty	备注 Remark
01	CKM01-20101	支座盖 Cap	2	
02	CKM01-20201	轴衬 bushing	4	
03	GB5785-86	螺栓 M16x1.5x70 Bolt	4	
04	GB93-87	垫圈 16 Washer	4	
05	ZBT33001.1-88	弯颈式滑脂嘴 Fitting	2	
06	CKM01-03601	倾斜缸销轴 Pin	2	
07	GB5786-86	螺栓 M10×1.25×20 Bolt	2	
08	GB93-87	垫圈 10 Washer	2	
09	CKM21-SH002	外门架总成 Outer mast	1	3TJ 型槽
	CKM20-SH002	外门架总成 Outer mast	1	2-25TJ 型槽
	CKM29-SH002	外门架总成 Outer mast	1	3T 莱钢槽
	CKM32-SH002	外门架总成 Outer mast	1	2-25T 莱钢槽
10	CKM18-22301	φ 111.3 复合滚轮 Roller	2	
11	CKM18-22001	直滚轮轴 Shaft	2	
12	760311NT-02	侧滚轮组 Shaft, side roller	2	
13	760311NT-03	防尘片 Seal, dust	2	
14	760311NT-06	止松片 Seal, shaky	2	
15	760311NT-07	调节螺丝 Adjust screw	2	
16	CKM18-22501	限位滑块 Slipper	2	
17	CKM01-25001	调整垫片 Shim	2	

图 45 内门架

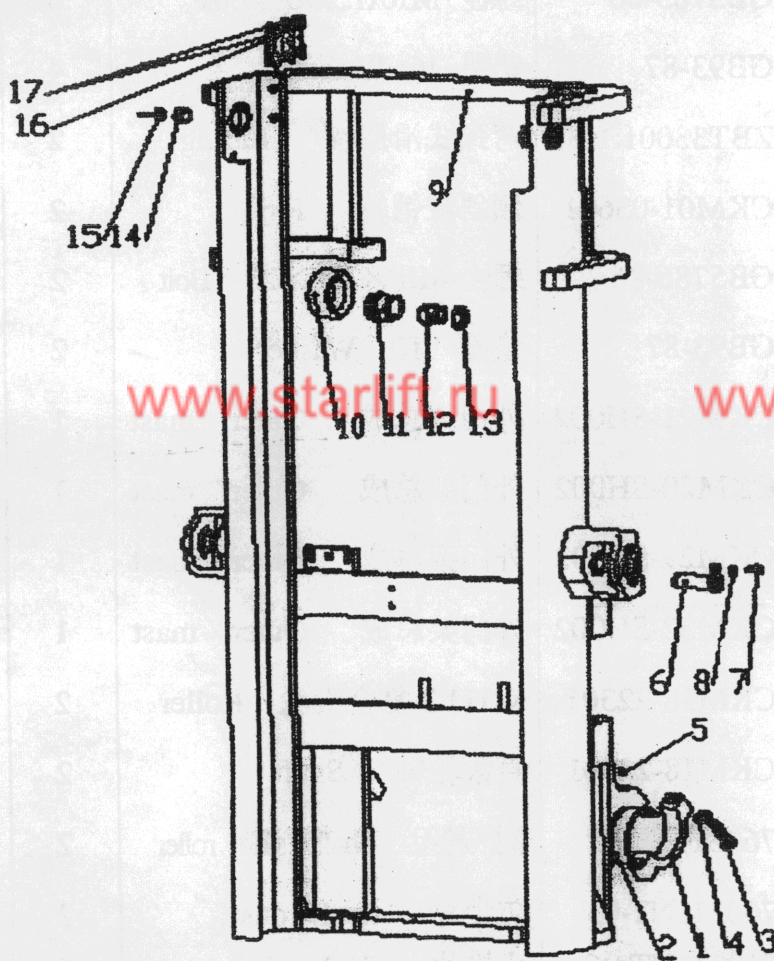
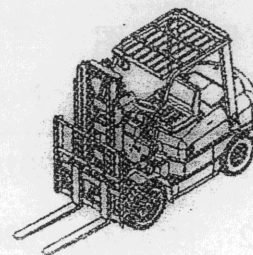
CPC(D)20,25,30 CPC(D)30A

FIG.45. INNER MAST (NORMAL MAST KM)



图 45 内门架

FIG.45. INNER MAST (NORMAL MAST KM)

序号 Item No	图号 Part No	零部件名称 Description	件数 Q'ty	备注 Remark
18	CKM21-SH005	内门架总成 Inner mast	1	3TJ 型钢槽
	CKM20-SH004	内门架总成 Inner mast	1	2-2.5TJ 型钢槽
	CKM29-SH002	内门架总成 Inner mast	1	3T 莱钢槽
	CKM32-SH002	内门架总成 Inner mast	1	2-2.5T 莱钢槽
19	CKM18-22401	φ119.2 复合滚轮 Roller	2	
20	CKM18-22601	滚轮轴 Shaft	2	

图 46 门架

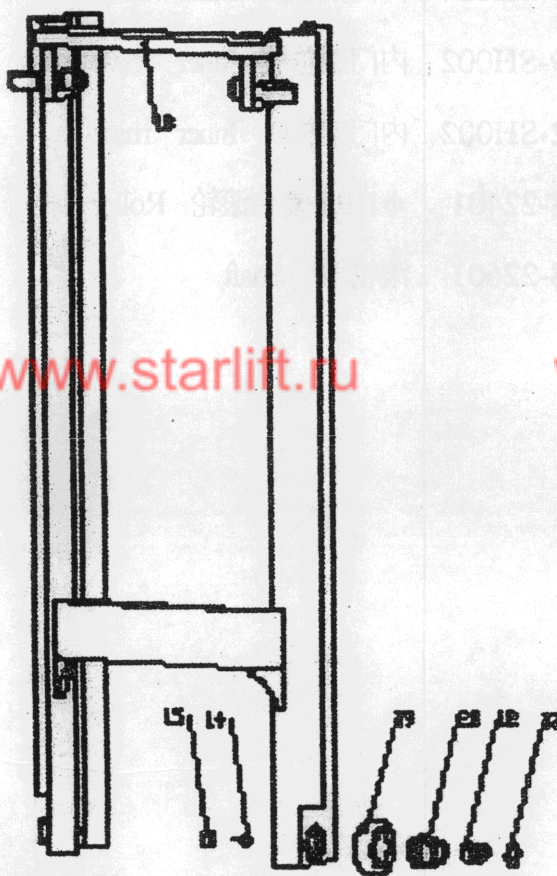
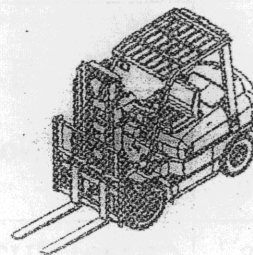
FIG.46. MAST (NORMAL MAST KM)

门架选用件表 Mast Optional Parts					
起升高 度 LIFTING HEIGHT	外门架总成 Outer mast		内门架总成 Inner mast		备注 Rema rk
	图 号 Part N o		图 号 Part N o		
	2T、2.5T		2T、2.5T		
KM200 KM250 KM270 KM300 KM330 KM350 KM370 KM400 KM425 KM450 KM475 KM500 KM550 KM600	CKM20-0610	CKM32-0610	CKM20-0410	CKM32-0410	标 准 STD
	1	1	1	1	
	CKM20-0620	CKM32-0620	CKM20-0420	CKM32-0420	
	1	1	1	1	
	CKM20-0630	CKM32-0630	CKM20-0430	CKM32-0430	
	1	1	1	1	
	CKM20-0600	CKM32-0600	CKM20-0400	CKM32-0400	
	1	1	1	1	
	CKM20-0640	CKM32-0640	CKM20-0440	CKM32-0440	
	1	1	1	1	
	CKM20-0650	CKM32-0650	CKM20-0450	CKM32-0450	
	1	1	1	1	
	CKM20-0660	CKM32-0660	CKM20-0460	CKM32-0460	
	1	1	1	1	
	CKM20-0670	CKM32-0670	CKM20-0470	CKM32-0470	
	1	1	1	1	
	CKM20-0680	CKM32-0680	CKM20-0480	CKM32-0480	
	1	1	1	1	
	CKM20-0690	CKM32-0690	CKM20-0490	CKM32-0490	
	1	1	1	1	
CKM20-0700	CKM32-0700	CKM20-0500	CKM32-0500		
1	1	1	1		
CKM20-0710	CKM32-0710	CKM20-0510	CKM32-0510		
1	1	1	1		
CKM20-0720	CKM32-0720	CKM20-0520	CKM32-0520		

图 46. 门架

FIG.46. MAST (NORMAL MAST KM)

门架选用件表 Mast Optional Parts					
起升高度 LIFTING HEIGHT	外门架总成 Outer mast		内门架总成 Inner mast		备注 Remark
	图 号 Part N o		图 号 Part N o		
	3T		3T		
KM200	CKM21-06101	CKM29-06101	CKM21-04101	CKM29-04101	标 准 (STD)
KM250	CKM21-06201	CKM29-06201	CKM21-04201	CKM29-04201	
KM270	CKM21-06301	CKM29-06301	CKM21-04301	CKM29-04301	
KM300	CKM21-06001	CKM29-06001	CKM21-04001	CKM29-04001	
KM330	CKM21-06401	CKM29-06401	CKM21-04401	CKM29-04401	
KM350	CKM21-06501	CKM29-06501	CKM21-04501	CKM29-04501	
KM370	CKM21-06601	CKM29-06601	CKM21-04601	CKM29-04601	
KM400	CKM21-06701	CKM29-06701	CKM21-04701	CKM29-04701	
KM425	CKM21-06801	CKM29-06801	CKM21-04801	CKM29-04801	
KM450	CKM21-06901	CKM29-06901	CKM21-04901	CKM29-04901	
KM475	CKM21-07001	CKM29-07001	CKM21-05001	CKM29-05001	
KM500	CKM21-07101	CKM29-07101	CKM21-05101	CKM29-05101	
KM550	CKM21-07201	CKM29-07201	CKM21-05201	CKM29-05201	
KM600	CKM21-07301	CKM29-07301	CKM21-05301	CKM29-05301	

图 47 倾斜油缸

CPC(D)20,25,30 CPC(D)30A

FIG47 TILT CYLINDER



图 47. 倾斜油缸

FIG47 TILT CYLINDER

序号 Item No	图号 Part No	零部件名称 Description	件数 Q'ty	备注 Remark
01	CKM01-SH01	耳环 Ear ring	2	
02	6	垫片 Snap Washer	12	
03	GB79-85	塞子 Plug	2	
04	CKM01-51201	螺钉 M10x10 Screw	2	
05	GB/T73-85	调整轴套 Spacer		
06	CKM01-SH01	防尘圈 Seal, dust	2	
07	7	挡圈 52 Snapring	2	
08	DKB3252811	导向套 Guide sleeve	2	
09	CKM01-50101	挡圈 Snap, ring	2	
10	CKM01-51401	挡片 d32 Shim	2	
11	CKM01-50101	U型密封圈 d50 U-ring	2	
12	CKM01-50201	O型密封圈 70x2.65 O-ring	2	
13	USI32426	轴套 Bushing	2	
14	CKM01-51001	活塞体 Body, piston ass'y	2	
15	CKM01-60901	缸体 Tube, cylinder ass'y	2	
16	CKM01-51501	U型密封圈 d70 U-ring	4	
17	CKM01-27101	支撑环 Wearing	2	

图 47. 倾斜油缸

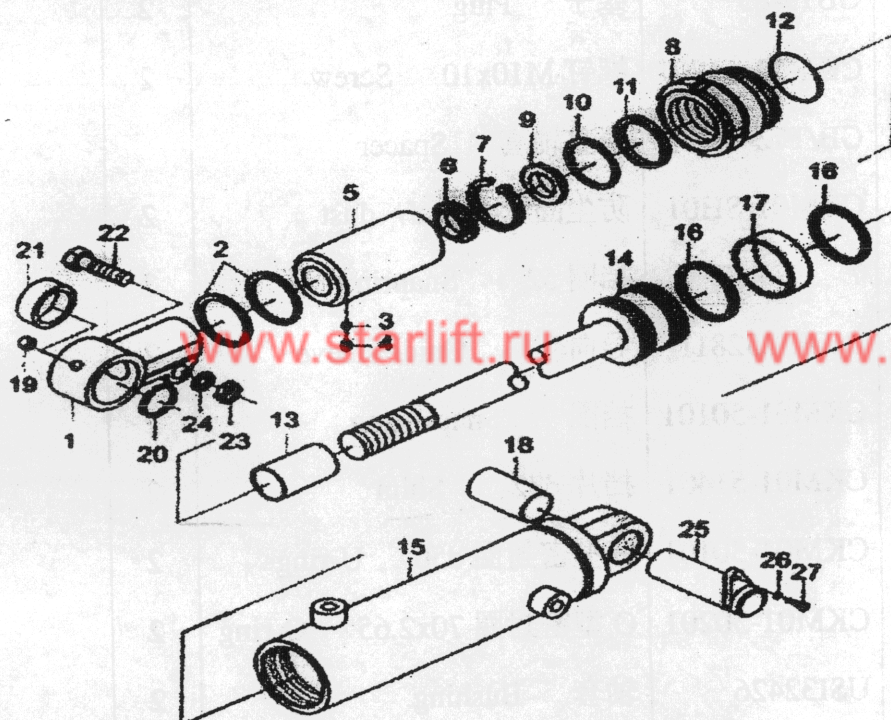
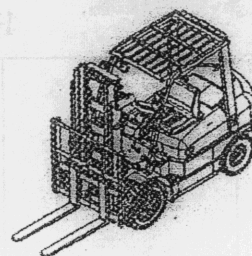
FIG47 TILT CYLINDER

序号 Item No	图号 Part No	零部件名称 Description	件数 Q'ty	备注 Remark
18	OSI7606	轴套 Bushing	2	
19	CKM01-50401	直通式滑脂嘴 Z1/8 Fitting	2	
20	CKM01-61201	grease	2	
21	R033Z1-80000	挡圈 47 Snap, ring	2	
22	GB893.1-86	关节轴承 Bushing	2	
23	GB/T304.1-81	螺栓 M14x55 Bolt	2	
24	CKM01-50801	螺母 M14 Nut	2	
25	CKM01-50701	垫圈 14 Washer, lock	2	
26	CKM01-50901	倾斜缸销轴 Pin	2	
27	CKM01-03601	垫圈 10 Washer, lock	2	
	GB93-87	螺栓 M10x1.25x20 Bolt		
	GB5786-86			

图.47 倾斜油缸

FIG47 TILT CYLINDER

倾斜油缸选用表 TILT CYLINDER OPTION PARTS			
序号 Item No	A		05
前后倾角 Tilt angle	倾斜缸右 Tilt cylinder R. H.	倾斜缸左 Tilt cylinder L.H.	调整轴套 Spacer
6-12	CKM01-10101	CKM01-10001	
6-6	CKM01-10301	CKM01-10201	CKM01-45601
3-6	CKM01-10501	CKM01-10401	CKM01-45601
3-3	CKM01-10701	CKM01-10601	CKM01-45701
6-10	CKM01-10901	CKM01-10801	CKM01-45801

图 48 货叉(附: 汽油机通用) CPC(D)20,25,30 CPC(D)30A

FIG48. FORK



图 48.货叉 (附: 汽油机通用)

FIG48. FORK

序号	图号	零部件名称	件数	备注
Item No	Part No	Description	Q'ty	Remark
1	CKM01-SH009	货叉总成 Fork ass'y	2	2t,2.5t
-	CKM03-SH007	货叉总成 Fork ass'y	2	3t
2	CKM01-39701	定位销 Positioning pin	2	
3	CKM01-39801	弹簧 Spring	2	
4	CKM01-39901	把手 Handle	2	

图 48 货叉(附: 汽油机通用)

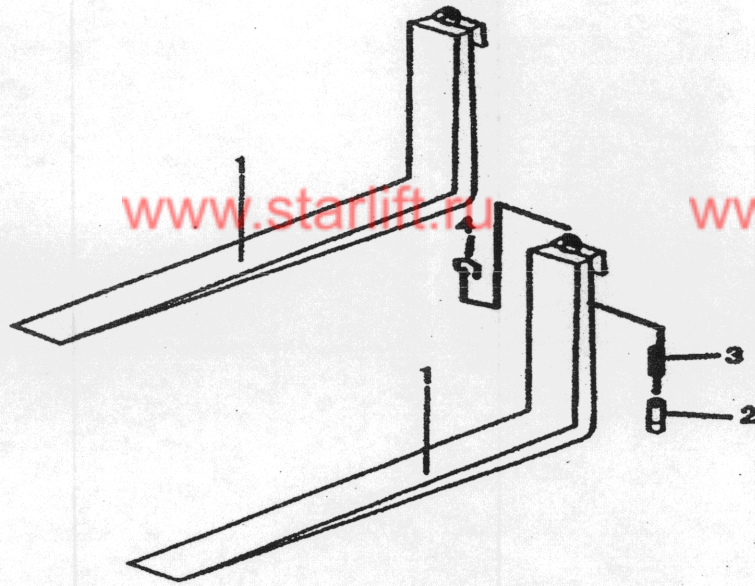
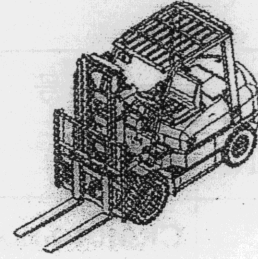
CPC(D)20,25,30 CPC(D)30A

FIG48. FORK



图 48. 货叉(2t,2.5t) (附: 汽油机通用)

FIG48. FORK(2t,2.5t)

货叉选用件表 Fork Optional Parts				
代 号 Part No		长 度 Length		备注 Remark
第一系列 Series I	第二系列 Series II	第一系列 Series I	第二系列 Series II	
HC2T-92A	HC2T-90A	920 ⁺²	900 ⁺²	标准 (SID)
HC2T-107A	HC2T-100A	1070 ⁺³	1000 ⁺³	
HC2T-122A	HC2T-110A	1220 ⁺³	1100 ⁺³	
HC2T-137A	HC2T-120A	1370 ⁺³	1200 ⁺³	
HC2T-152A	HC2T-130A	1520 ⁺⁴	1300 ⁺³	
HC2T-167A	HC2T-140A	1670 ⁺⁴	1400 ⁺⁴	
HC2T-182A	HC2T-150A	1820 ⁺⁴	1500 ⁺⁴	
HC2T-197A	HC2T-160A	1970 ⁺⁴	1600 ⁺⁴	
HC2T-212A	HC2T-170A	2120 ⁺⁴	1700 ⁺⁴	
	HC2T-180A		1800 ⁺⁴	
	HC2T-190A		1900 ⁺⁴	
	HC3T-200A		2000 ⁺⁴	

图 48 货叉(附: 汽油机通用)

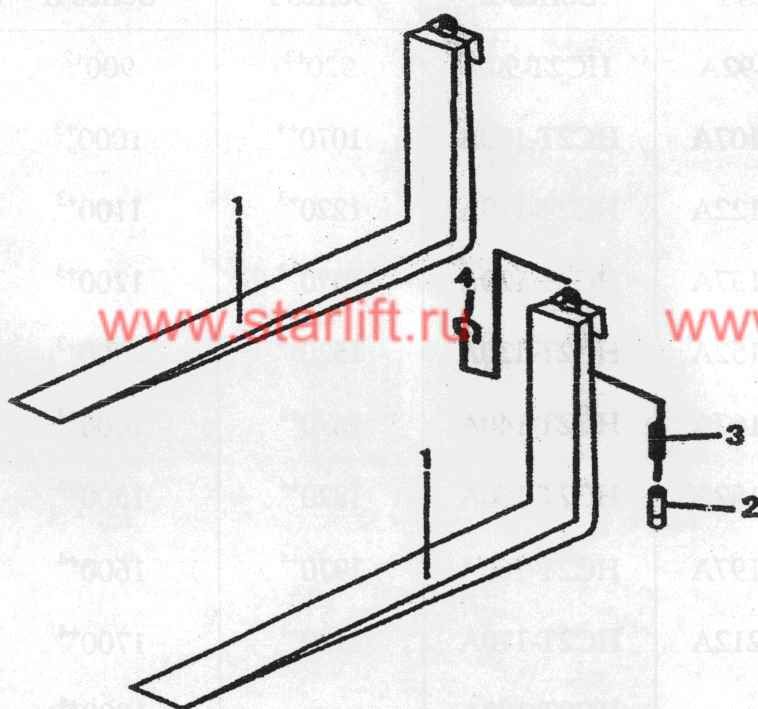
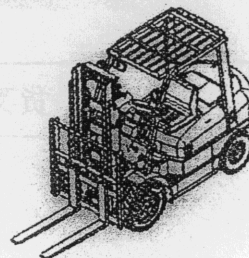
CPC(D)20,25,30 CPC(D)30A

FIG48. FORK

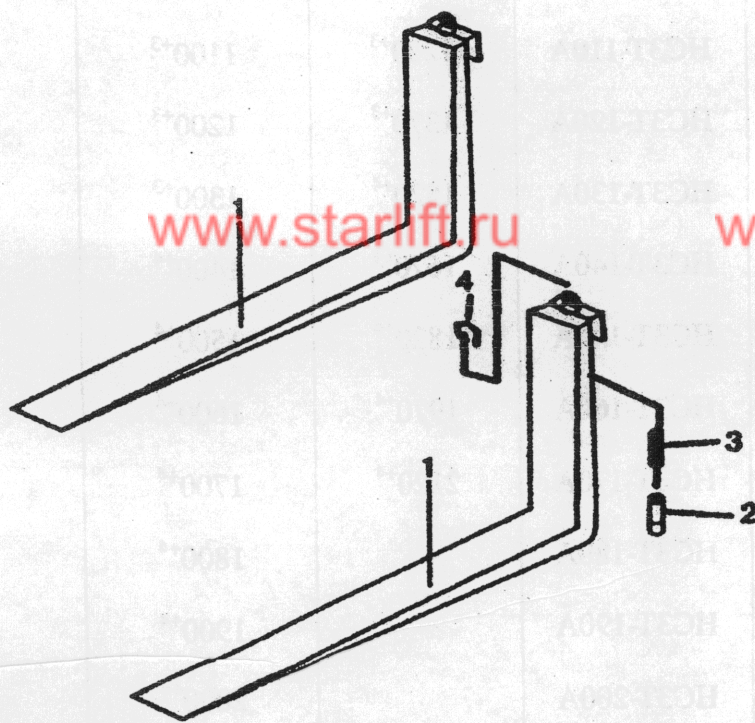
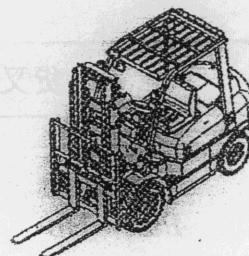

图 48.货叉(3t.) (附: 汽油机通用)

FIG48. FORK(3t.)

货叉选用件表 Fork Optional Parts				
代 号 Part No		长 度 Length		备注 Remark
第一系列 Series I	第二系列 Series II	第一系列 Series I	第二系列 Series II	
HC3T-92A	HC3T-90A	920 ⁺²	900 ⁺²	标准 (SID)
HC3T-107A	HC3T-100A	1070 ⁺³	1000 ⁺³	
HC3T-122A	HC3T-110A	1220 ⁺³	1100 ⁺³	
HC3T-137A	HC3T-120A	1370 ⁺³	1200 ⁺³	
HC3T-152A	HC3T-130A	1520 ⁺⁴	1300 ⁺³	
HC3T-167A	HC3T-140A	1670 ⁺⁴	1400 ⁺⁴	
HC3T-182A	HC3T-150A	1820 ⁺⁴	1500 ⁺⁴	
HC3T-197A	HC3T-160A	1970 ⁺⁴	1600 ⁺⁴	
HC3T-212A	HC3T-170A	2120 ⁺⁴	1700 ⁺⁴	
	HC3T-180A		1800 ⁺⁴	
	HC3T-190A		1900 ⁺⁴	
	HC3T-200A		2000 ⁺⁴	