

图 19 传动装置 (液力式)

CPCD20, 25, 30 CPCD30A

FIG 19. DRIVE UNIT (TOP-CON TYPE)

份
mark



图 19.传动装置 (液力式)

FIG 19.DRIVE UNIT(TOP-CONTYPE)

序号 Item No	图号 Part No	零部件名称 Description	件数 Q'ty	备注 Remark
1	C0C02-22001	变矩器壳体 Case, tor-con	1	
2	C0C02-22101	加油口盖 Cup	1	
3	Q/Z285-4	螺塞 1/2" Plug	4	
4	C0C02-03001	变矩器总成 Tor-con ass'y	1	
5	C0C02-03101	供油泵总成 Charging pump ass'y	1	
6	C0C02-22201	衬垫 Gasket	1	
7	GB894-86	挡圈 35 Snap ring	1	
8	C0C02-03201	滤油器 Strainer	1	
9	GB1235-76	O型圈 28x3.5 O-ring	1	
10	Q/Z285-2	内六角螺塞 1/4" Plug	2	
11	GB1235-76	O型圈 28x3.5 O-ring	1	
12	C0C02-22301	垫片 Gasket	1	
13	GB5785-86	螺栓 M10x1.25x75 Bolt	1	
14	GB5785-86	螺栓 M10x1.25x55 Bolt	3	
15	GB5785-86	螺栓 M10x1.25x50 Bolt	1	
16	GB5785-86	螺栓 M10x1.25x30 Bolt	4	
17	GB93-87	垫圈 10 Washer	9	

图 19.传动装置 (液力式)

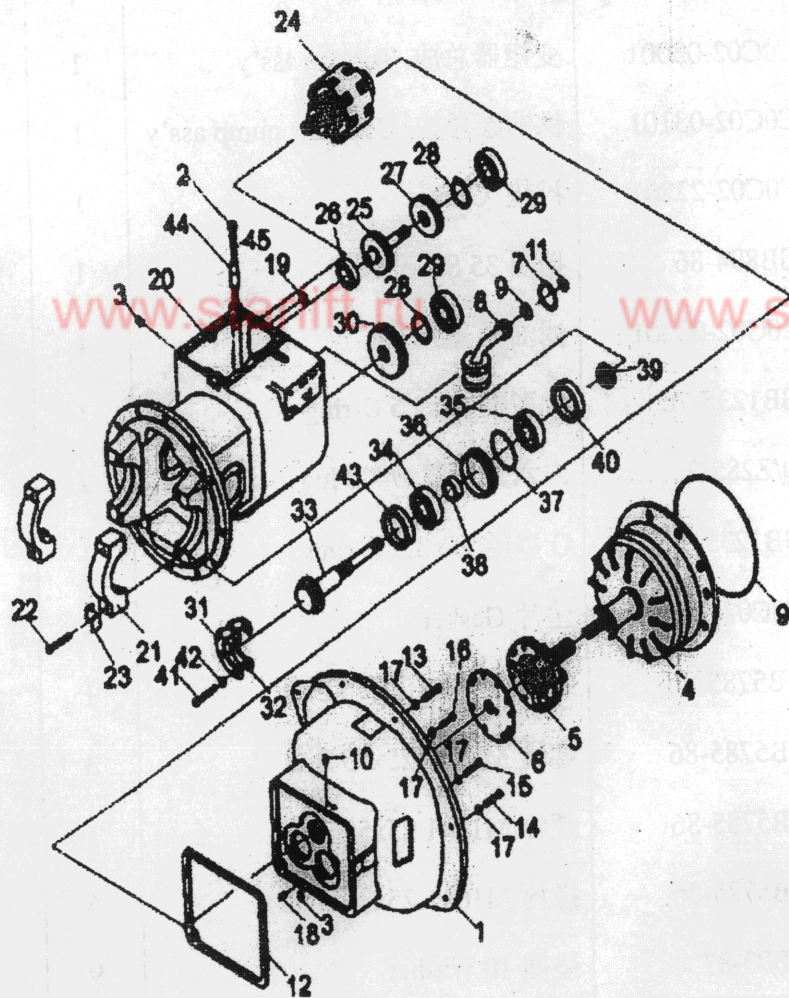
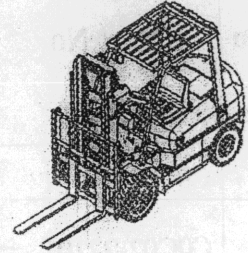
FIG 19.DRIVE UNIT(TOP-CONTYPE)

分 ark	序号 Item No	图号 Part No	零部件名称 Description	件数 Q'ty	备注 Remark
	18	GB119-76	销 B12x20 Pin	2	
	19	GB1235-76	O 型圈 15x2.4 O-ring	1	
	20	C0C02-03301	壳体 Case, mission	1	
	21	C0C02-22401	轴承座 Cap, bearing	2	
	22	C0C02-22501	螺栓 Bolt	4	
	23	C0C02-22601	垫片 Plate, lock	4	
	24	C0C02-03301	离合器总成 Clutch, hydraulic	1	
	25	C0C02-03401	惰轮轴 Shaft, idler	1	
	26	GB276-64	轴承 206 Bearing	1	
	27	C0C02-22701	惰轮 Gear, idler	1	
	28	GB893-86	挡圈 24 Snap ring	2	
	29	GB276-64	轴承 207 Bearing	2	
	30	C0C02-22801	输出齿轮 Gear output	1	
	31	C0C02-22901	支承片 Plate, bearing support	1	
	32	C0C02-23001	垫片 Shim	按需	
		C0C02-23101	垫片 Shim	按需	
		C0C02-23201	垫片 Shim	按需	

图 19.传动装置 (液力式)

FIG 19.DRIVE UNIT(TOP-CONTYPE)

序号 Item No	图号 Part No	零部件名称 Description	件数 Q'ty	备份 Remark
33	C0C02-23301	输出轴 Shaft output	1	
34	Z-7508	轴承 27508 Bearing		
35	Z-7208	轴承 7208 Bearing	1	
36	C0C02-23401	油封保持架 Retainer, oil seal	1	
37	GB1235-76	O 型圈 80x3.1 O-ring	1	
38	C0C02-23501	油封 Seal oil	1	
39	C0C02-23601	螺母 Nut	1	
40	C0C02-23701	垫 Shim	1	
	C0C02-23801	垫 Shim	1	
	C0C02-23901	垫 Shim	1	选用
41	GB5782-86	螺栓 M8x20 Bolt	4	选用
42	GB93-87	垫圈 8 Washer	15	选用
43	C0C02-24001	轴环 Collar	1	
44	C0C02-24101	加油管 Pipe oil fill	1	
45	C0C02-24201	衬垫 Gasket	1	

图 20 传动装置 (盖和微动阀)

CPCD20, 25, 30 CPCD30A

FIG 20. DRIVE UNIT (COVER-INCHING VALVE)

份
mark



图 20.传动装置 (盖和微动阀)

FIG 20.DRIVE UNIT(COVER-INCHING VALVE)

序号 Item No	图号 Part No	零部件名称 Description	件数 Q'ty	备注 Remark
1	C0C02-04001	壳体盖 Cover	1	
2	C0C02-04101	变速臂 Arm, shift	1	
3	GB897-76	销 6x32 Pin, lock	1	
4	C0C02-25001	变矩臂轴 Shaft, shift arm	1	
5	GB1236-76	O 型圈 20x2.4 O-ring	1	
6	GB1099-79	半轴键 5x19	1	
7	C0C02-25101	螺栓 Bolt	1	
8	C0C02-25201	衬垫 Shim	1	
9	C0C02-25301	塞子 Plug	7	
10	C0C02-04201	倒车灯开关 Switch	1	
11	C0C02-25401	垫片 Shim	2	
12	C0C02-04301	管接头 Nipple	2	
13	C0C02-04401	滤油器 Filter, oil	1	
14	GB879-76	弹性圆柱销 4x225 Pin, lock	1	
15	C0C02-04501	活塞 Piston	1	
16	C0C02-25501	弹簧 Piston	1	
17	C0C02-25601	安全阀盖 Cup	1	

图 20.传动装置 (盖和微动阀)

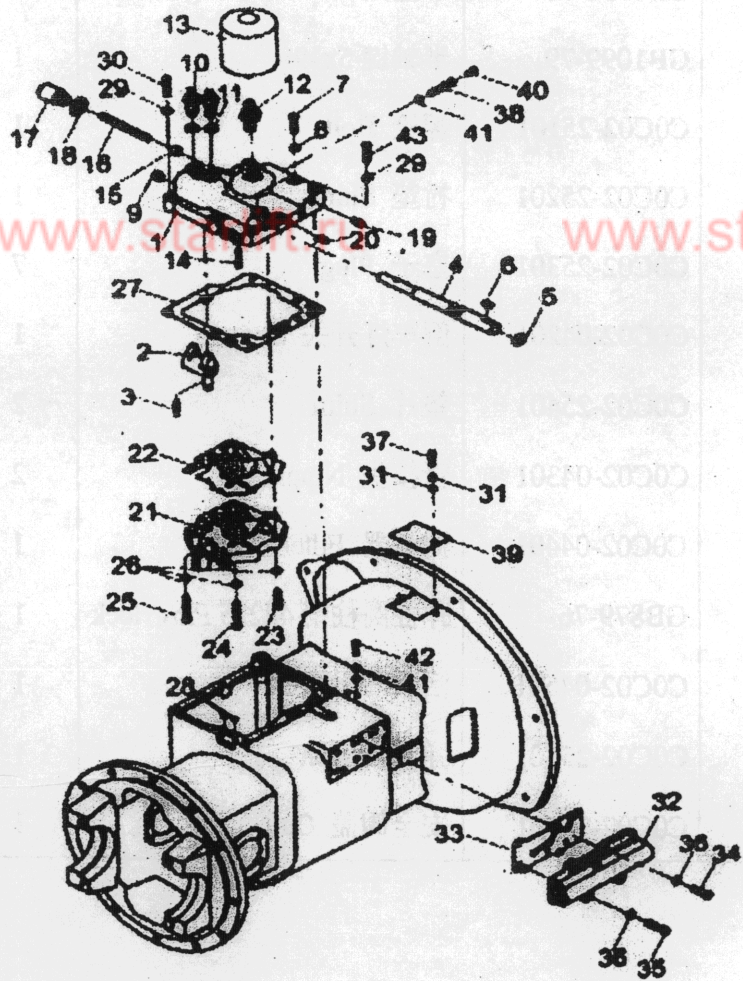
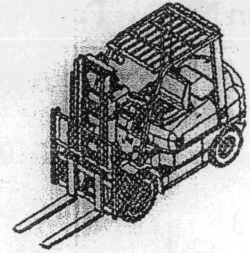
FIG 20.DRIVE UNIT(COVER-INCHING VALVE)

份 mark	序号 Item No	图号 Part No	零部件名称 Description	件数 Q'ty	备注 Remark
	18	C0C02-25701	衬垫 Packing, copper	1	
	19	Q/ZB285-1	螺塞 1/8" Plug	1	
	20	Q/ZB285-2	螺塞 1/4" Plug	6	
	21	C0C02-04601	控制阀总成 Control ass'y	4	
		C0C02-04701	电液控制阀 Electric-Controller	1	
	22	C0C02-25801	垫片 Gasket	1	
	23	GB5782-86	螺栓 M8x35 Bolt	2	
	24	GB5782-86	螺栓 M8x55 Bolt	2	
	25	GB5782-86	螺栓 M8x50 Bolt	2	
	26	GB93-87	垫圈 8 Shim	6	
	27	C0C02-25901	垫片 Gasket	1	
	28	GB1235-76	O型圈 9x1.9 O-ring	2	
	29	GB5782-86	垫圈 10 Shim	8	
	30	GB5782-86	螺栓 M10x1.25x55 Bolt	2	
	31	GB93-87	垫圈 8 Shim	3	
	32	C0C02-04801	微动阀总成 Inching valve	1	

图 20.传动装置 (盖和微动阀)

图 2

FIG 20.DRIVE UNIT(COVER-INCHING VALVE)

FIG

序号 Item No	图号 Part No	零部件名称 Description	件数 Q'ty	备注 Remark
33	C0C02-26001	衬垫 Shim	1	
34	GB5783-86	螺栓 M8x25 Bolt	4	
35	GB5783-86	螺栓 M8x50 Bolt	2	
36	GB93-87	垫圈 8 Shim	5	
37	GB5783-86	螺栓 M8x12 Bolt	2	
38	C0C02-26101	连接螺栓 Bolt	1	
39	C0C02-04901	变矩器盖 Cover, tor-con	1	
40	Q/ZB285-77	螺塞 ZG1/8" Plug	1	
41	C0C02-26201	铜垫 Packing, copper	4	
42	C0C02-26301	连接螺栓 Bolt	1	
43	GB5785-86	螺栓 M10x1.25x40 Bolt	6	

图 21 变矩器

CPCD20, 25, 30 CPCD30A

备份

mark

FIG 21. TORQUE-CONVERTER (TOP-CON TYPE)



图 21.变矩器

图 22

FIG 21.TORQUE-CONVERTER (TOP-CON TYPE)

序号 Item No	图号 Part No	零部件名称 Description	件数 Q'ty	备注 Remark
A	C0C02-08001	变矩器总成 Torque-converter ass'y	1	
1	C0C02-08101	输入板组件 Plate, input	1	
2	GB5785-86	螺栓 M10x1.25x15 Bolt	6	
3	JB97.1-86	垫圈 10 Washer	6	
4	GB145-76	螺栓 M8x1x8 Bolt	2	
5	C0C02-25001	密封垫圈 8	2	

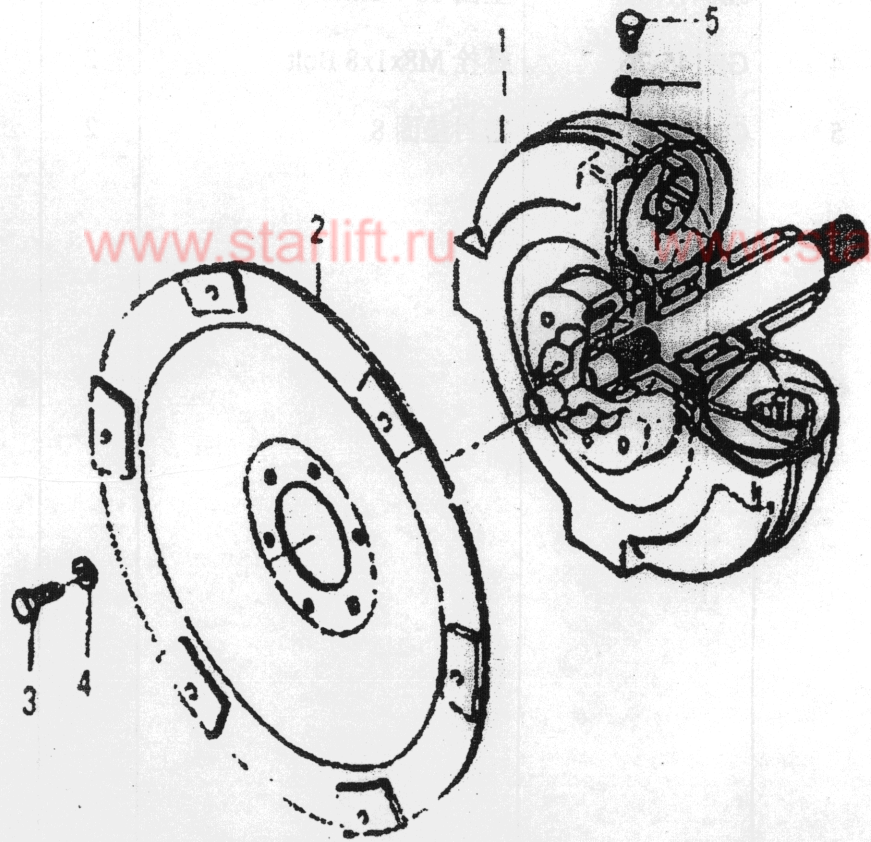
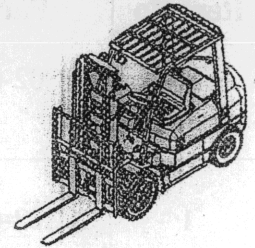
FIG 22

图 22 供油泵 (液力式)

CPCD20, 25, 30 CPCD30A

备份
mark

FIG 22. CHARGING PUMP (TOP-CON TYPE)



图 22.供油泵 (液力式)

图 2

FIG 22.CHARGING PUMP (TOP-CON TYPE)

序号 Item No	图号 Part No	零部件名称 Description	件数 Q'ty	备注 Remark
A	C0C02-05001	供油泵总成 Charging pump ass'y		
1	C0C02-05101	泵体 Case, pump	1	
2	C0C02-27001	衬套 Bushing	1	
3	C0C02-27101	螺塞 ZG1/8" Plug	1	
4	C0C02-27201	油封 Seal, oil	1	
5	C0C02-27301	O 型圈密封圈 Snap O-ring	1	
6	C0C02-27401	定子 Support, starter	1	
7	GB119-86	圆柱销 6x16 Pin	1	
8	C0C02-27501	主动齿轮 Gear driven	2	
9	C0C02-27601	衬套 Bushing	1	
10	C0C02-27701	被动齿轮 Gear drive	1	
11	GB5783-86	螺栓 M8x45 Bolt	1	
12	GB5782-86	螺栓 M8x25 Bolt	4	
	GB5783-86	螺栓 M8x35 Bolt	1	
13	C0C02-27801	衬垫 Washer	3	
			2	

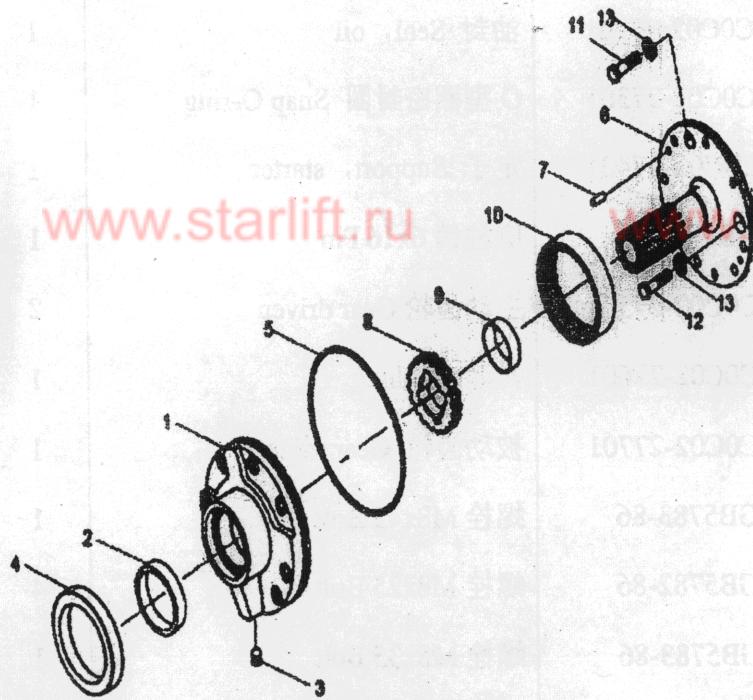
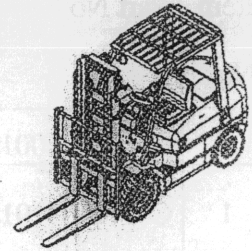
图 23 液力离合器 (液力式)

CPCD20, 25, 30 CPCD30A

FIG 23. HYDRAULIC CLUTCH (TOP-CON TYPE)

备份
emark



图 23.液力离合器 (液力式)

图 2

FIG 23.HYDRAULIC CLUTCH (TOP-CON TYPE)

序号 Item No	图号 Part No	零部件名称 Description	件数 Q'ty	备注 Remark
A	C0C02-06001	离合器总成 Clutch, hydraulic	1	
1	C0C02-06101	输入轴总成 Shift, input	1	
2	C0C02-28001	倒车档齿轮 Gear, reverse	1	
3	C0C02-28101	前进档齿轮 Gear, forward	1	
4	C0C02-28201	端板 Plate, end	2	
5	C0C02-28301	回程弹簧 Spring, return	2	
6	C0C02-28401	弹簧座 Seat, spring	2	
7	C0C02-28501	止推环 A Ring, seal	2	
8	C0C02-28601	止推环 B Ring, seal	2	
9	C0C02-06201	活塞 Piston	1	
10	C0C02-28701	塞 Plug	1	
11	GB307-77	钢球 1/8" Ball, steel	1	
12	C0C02-28801	摩擦片 Plate, friction	8	
13	C0C02-28901	隔片 Plate, separator	8	
14	C0C02-29001	密封环 A Ring seal	4	
15	C0C02-29101	密封环 B Ring seal	2	
16	GB1235-76	O 型圈 O-ring	2	
17	C0C02-29201	卡环 Snap, ring	2	
18	GB276-82	轴承 206 Bearing	2	
19	C0C02-29301	滚珠轴承 Bearing needle	2	
20	GB894-86	挡圈 40 Snap, ring	2	
21	GB78-85	螺钉 M8x8 Plug	2	

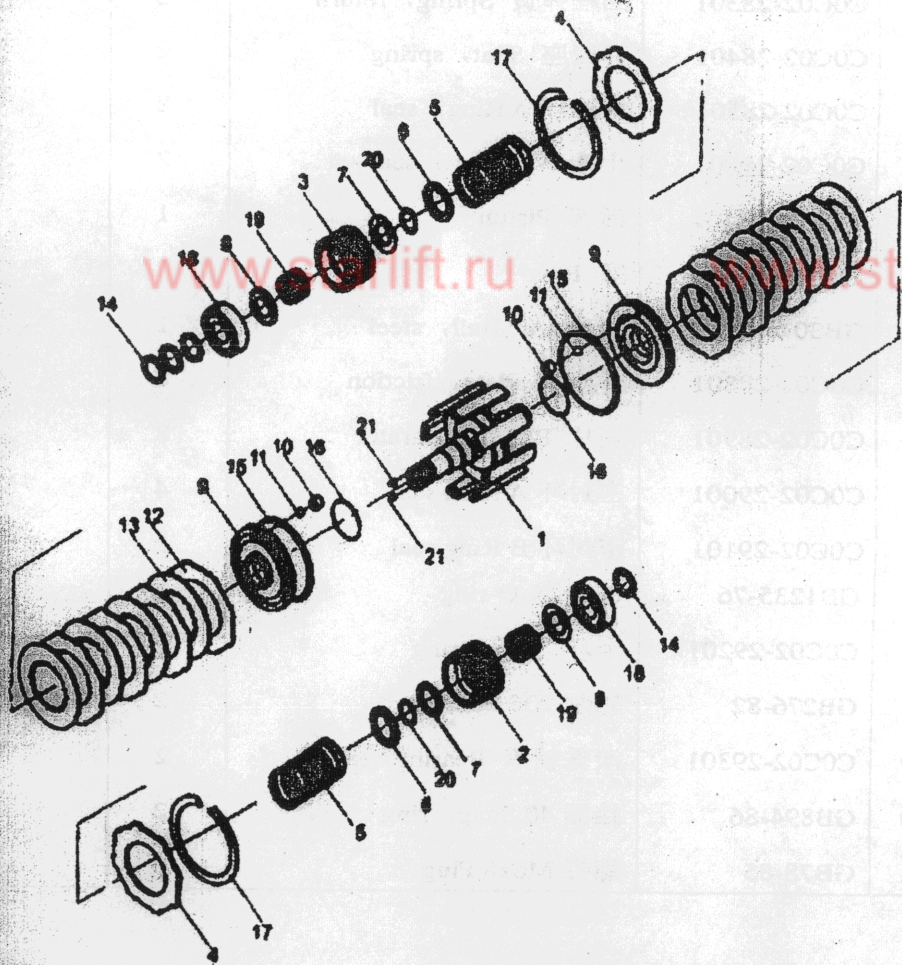
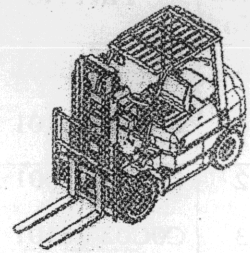
FIG

图 24 控制阀 (液力式)

CPCD20, 25, 30 CPCD30A

零件
mark

FIG 24. CONTROL VALVE(TOP-CON TYPE)



图 24.控制阀 (液力式)

图

FIG 24.CONTROL VALVE(TOP-CON TYPE)

F1

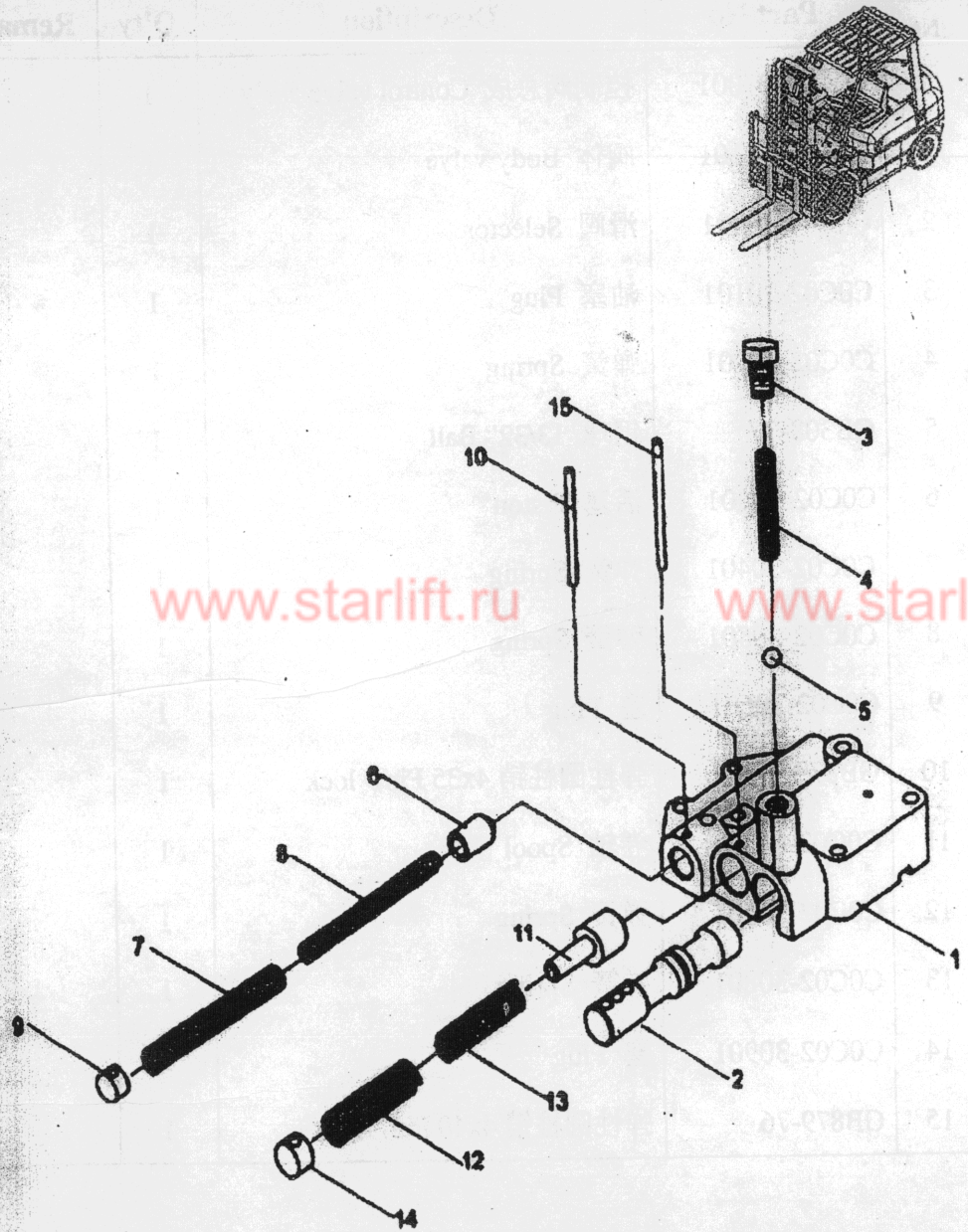
序号 Item No	图号 Part No	零部件名称 Description	件数 Q'ty	备注 Remark
A	C0C02-07001	控制阀总成 Control valve ass'y	1	
1	C0C02-07101	阀体 Body valve	1	
2	C0C02-30001	滑阀 Selector	1	
3	C0C02-30101	油塞 Plug	1	
4	C0C02-30201	弹簧 Spring	1	
5	GB308-77	钢球 13/32" Ball	1	
6	C0C02-30301	活塞 Piston	1	
7	C0C02-30401	弹簧 Spring	1	
8	C0C02-30501	弹簧 Spring	1	
9	C0C02-30601	塞 Plug	1	
10	GB879-76	弹性圆柱销 4x35 Pin, lock	1	
11	C0C02-07201	卷轴 Spool	1	
12	C0C02-30701	弹簧 Spring	1	
13	C0C02-30801	弹簧 Spring	1	
14	C0C02-30901	塞 Plug	1	
15	GB879-76	弹性圆柱销 4x40 Pin, lock	1	

图 25 微动阀 (液力式)

CPCD20, 25, 30 CPCD30A

备份

emark

FIG 25. INCHING VALVE (TOP-CON TYPE)

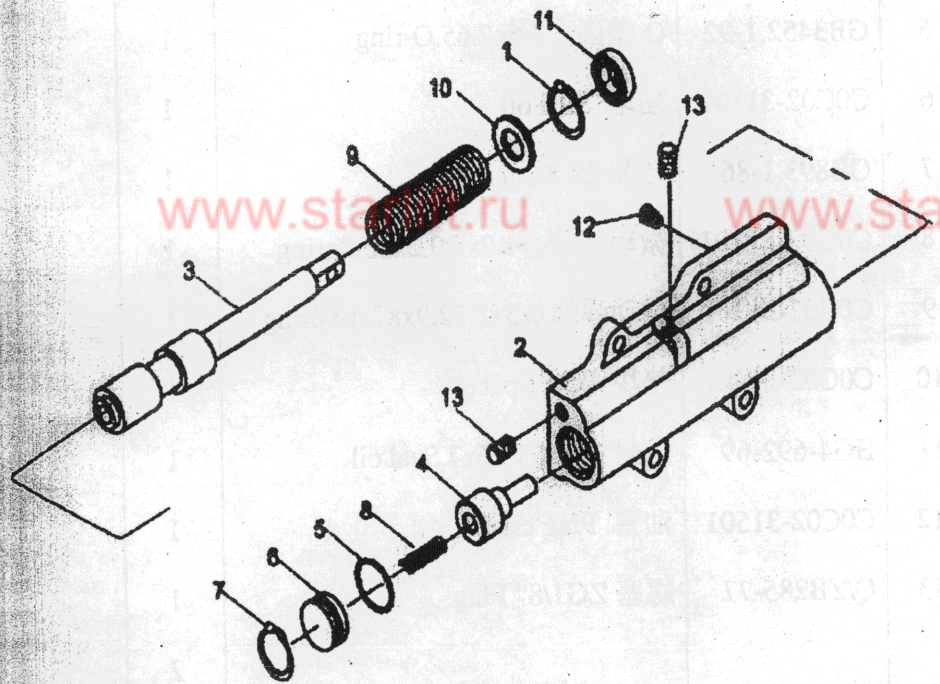
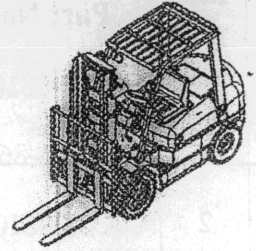

图 25.微动阀 (液力式)

FIG 25.INCHING VALVE (TOP-CON TYPE)

序号 Item No	图号 Part No	零部件名称 Description	件数 Q'ty	备份 Remark
A	C0C02-08101	微动阀总成 Iching valve ass'y		
1	GB893.1-861	挡圈 30 Snap ring	1	
2	C0C02-08101	阀体 Body valve	1	
3	C0C02-31001	卷杆 Spool	1	
4	C0C02-08201	滑阀 Plunger	1	
5	GB3452.1-92	O 型圈 23.6x2.65 O-ring	1	
6	C0C02-31101	油堵 Seal oil	1	
7	GB893.1-86	挡圈 28 Snap ring	1	
8	C0C02-31201	微动弹簧 $\phi 1.2 \times D9.2 \times 30$ Spring	1	
9	C0C02-31301	微动弹簧 $\phi 3 \times D22.9 \times 87.4$ Spring	1	
10	C0C02-31401	垫块 4x35 Spacer	1	
11	HG4-692-69	油封 $\phi 30 \times \phi 16 \times 7$ Seal oil	1	
12	C0C02-31501	油塞 Plug choke	1	
13	Q/ZB285-77	螺塞 ZG1/8" Plug	1	
			2	