

序号 Item No	图号 Part No	零部件名称 Description	件数 Qty	备注 Remark	CPQ, CPQD20, 25, 30 CPC, CPCD20, 25, 30
01	22018-30064	Cap	2	支座盖	
02	D20B8-02001	Bushing	4	轴衬	
03	B0430-16065	Bolt	4	螺栓M16x1.5x65	GB5785-86
04	B5050-00016	Washer	2	垫圈16	GB93-87
05	Q701B45	Fitting	2	弯颈式滑脂嘴45°	ZBT33001.2-88 21.2.5t
-	Q700B01	Fitting	2	直通式滑脂嘴	ZBT33001.1-88 3t
06	HRH22A8309 H22A8-00201L	Pin	2	倾斜缸销轴	
07	B0530-10020	Bolt	2	螺栓M10x1.25x20	GB5786-86
08	B5050-00010	Washer	2	垫圈10	GB93-87
09	HRD24C8301A	Outer mast	1	外门架总成	21.2.5t
-	HRD24N8301A	Outer mast	1	外门架总成	3t
10	HRD24C8303A	Inner mast	1	内门架总成	21.2.5t
-	HRD24N8303A	Inner mast	1	内门架总成	3t
11	23458-32051	Shaft	4	侧滚轮组II	
12	22548-34051	Shim	选用	调整垫圈	
13	23818-30071	Spacer	8	垫块	
14	B0330-12040	Bolt	8	螺栓M12x40	GB5783-86
15	B5050-00012	Washer, lock	8	垫圈12	GB93-87
16	23658-33001	Roller	2	滚轮2 $\varnothing$ 109.7	
17	B6152-00040	Snap ring	2	挡圈40	GB894.1-86
18	980811N-00	Roller	2	主滚轮 $\varnothing$ 119.2X55-34	
19	22548-34061	Shim	8	调整垫圈	
20	20028-32001*G	Slipper	2	限位滑块	
21	20029-43231*1	Shim	AR	调整垫片0.5	
-	20029-43231*2	Shim	AR	调整垫片1.0	
22	B4116-00010	Nut	2	螺母M10	GB6170-86
23	D24C8-62001	Shaft	2	限位轴	
24	B8030-10040	Screw	2	螺钉M10X40	GB70-85
25	B6152-00055	Snap ring	2	挡圈55	GB894.1-86

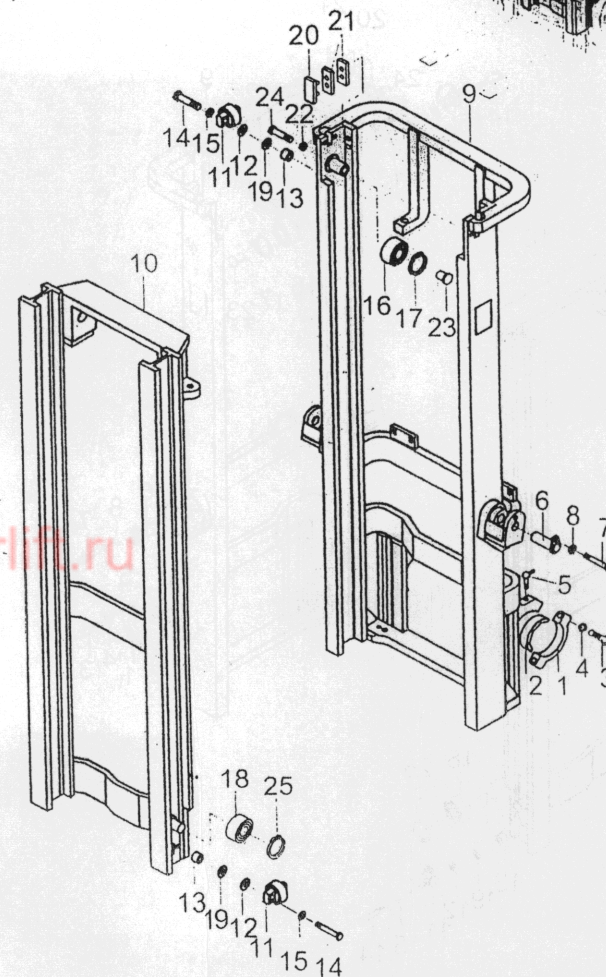



CPQ, CPQD20, 25, 30  
CPC, PCPD20, 25, 30

门架选用件表 Mast Optional Parts

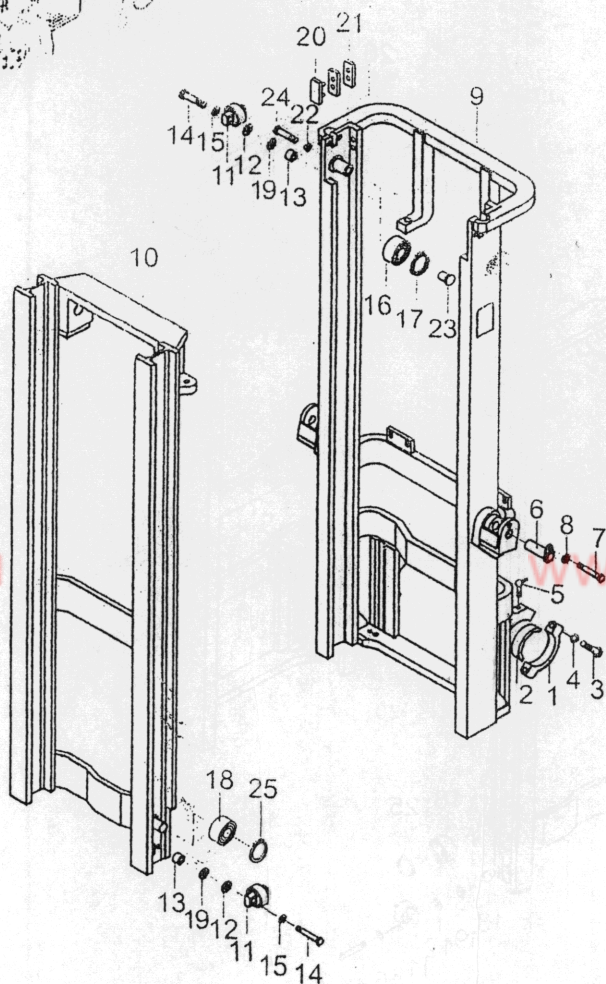
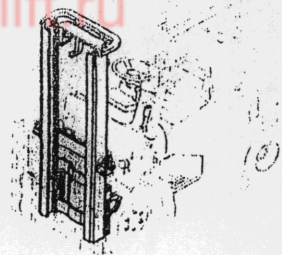

起升高度 LIFTING HEIGHT	外门架总成 OUTER MAST		内门架总成 INNER MAST		备注 REMARK
	2t, 2.5t	3t	2t, 2.5t	3t	
KM200	D24C8-30212	D24N8-30212	D24C8-30412	D24N8-30412	
250	-30222	-30222	-30422	-30422	
270	-30232	-30232	-30432	-30432	
300	-30202	-30202	-30402	-30402	标准 STD
330	-30242	-30242	-30442	-30442	
350	-30252	-30252	-30452	-30452	
370	-30262	-30262	-30462	-30462	
400	-30272	-30272	-30472	-30472	
425	-30282	-30282	-30482	-30482	
450	-30292	-30292	-30492	-30492	
475	-30312	-30312	-30512	-30512	
500	-30322	-30322	-30522	-30522	
550	-30332	-30332	-30532	-30532	
600	-30342	-30342	-30542	-30542	

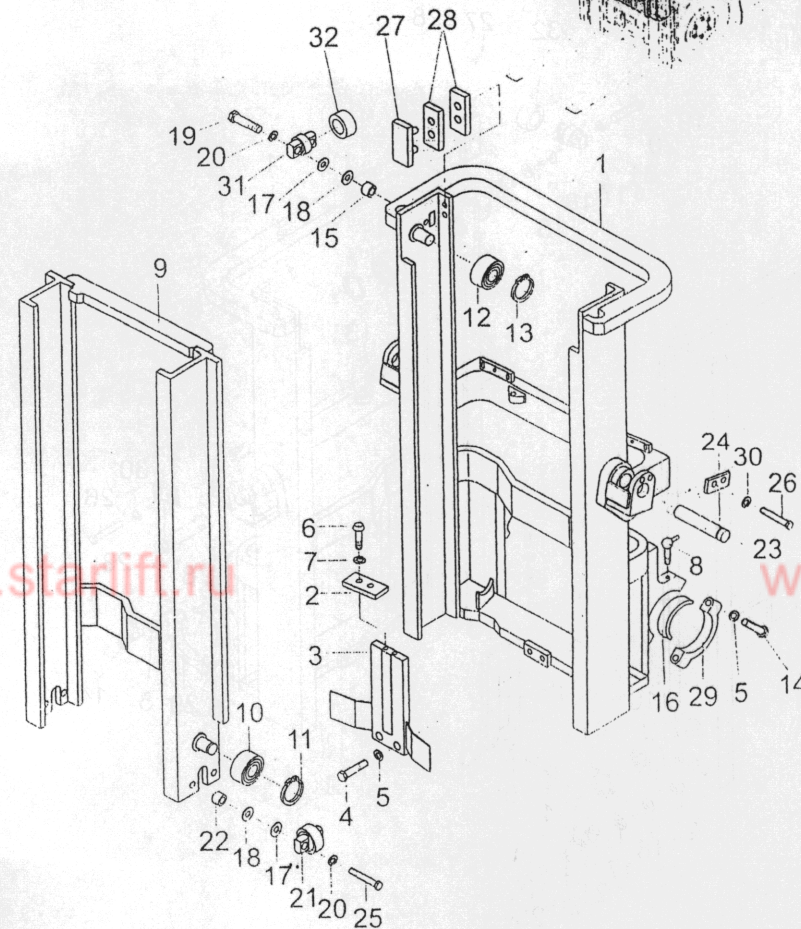

序号 Item No	图号 Part No	零部件名称 Description	件数 Q'ty	备注 Remark
01	HRD30A8301A	Mast ass'y,outer 外门架总成	1	见选用件表 See op.parts
02	27419-43321	Rubber,cushion 缓冲垫	1	
03	D20B8-31201	Bracket,cushion 缓冲支架	1	
04	B0530-16035	Bolt 螺栓M16X1.5X35	2	GB5786-86
05	B5050-00016	Washer,lock 垫圈16	6	GB93-87
06	B1210-06010	Screw 螺钉M6X10	2	GB818-85
07	B5310-00006	Washer 垫圈6	2	GB97.1-85
08	Q700B01	Grease port 直通式滑脂嘴	2	ZBT33001.1-88
09	HRD30A8304A	Mast ass'y,inner 内门架总成	1	见选用件表 See op.parts
10	980811N-00	End roller 主滚轮 $\phi 119.2 \times 55-34$	2	
11	B6150-00055	Snap ring 挡圈55	2	GB894.1-86
12	23658-33001	Roller 滚轮2	2	
13	B6150-00040	Snap ring 挡圈40	2	GB894.1-86
14	B0430-16065	Bolt 螺栓M16X1.5X65	4	GB5785-86
15	20028-34071	Spacer 垫块	4	
16	D20B8-02001	Bushing 轴衬	2	
17	22548-34051	Shim 调整垫圈	AR	
18	22548-34061	Shim 调整垫圈	AR	
19	B0530-12035	Bolt 螺栓M12X1.25X35	4	GB5786-86
20	B5050-00012	Washer,lock 垫圈12	8	GB93-87
21	23458-32051	Side roller 侧滚轮组11	2	
22	23818-30071	Spacer 垫块	4	
23	D20B8-02021	Pin axle 销轴	2	
24	23648-50161	Plate,stopper 卡板	2	
25	B0530-12040	Bolt 螺栓M12X1.25X40	4	GB5786-86
26	B0530-10020	Bolt 螺栓M10X1.25X20	4	GB5786-86
27	20028-32001*G	Slipper 限位滑块	2	
28	20029-43231*1	Shim 调整垫片0.5	AR	
-	20029-43231*2	Shim 调整垫片1.0	AR	
29	22018-30064	Cap 支座盖	2	GB93-87

CPQ,CPQD35  
CPC,CPCD35

h2000



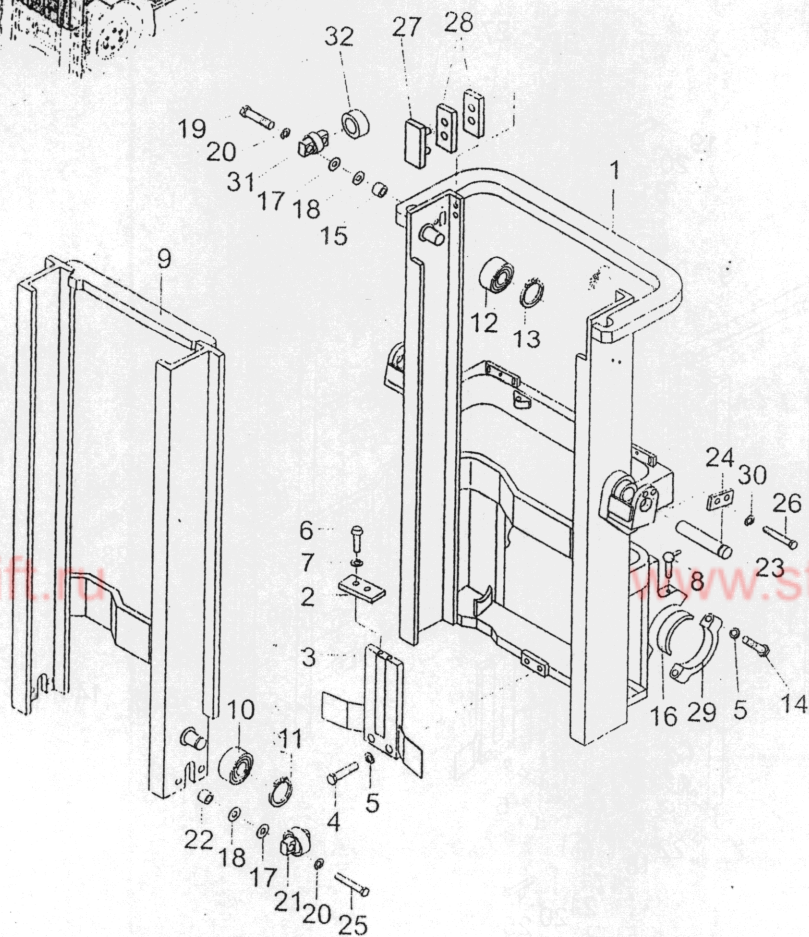
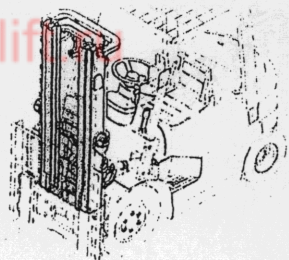

CPQ,CPQD35  
CPC,PCD35

序号  
Item  
No

图号  
Part No

零部件名称  
Description

件数  
Q'ty

备注  
Remark

30	B5050-00010	Washer,lock	垫圈10	4	
A	22548-30601	Side roller(Inc.31,32)	侧滚轮组1Ø80	2	
31	22548-34021	Shaft	轴	2	
32	22578-22401	Roller	限位滚轮	2	



门架选用件表 Mast Optional Parts

起升高度 IFTING HEIGHT	外门架总成 OUTER MAST	内门架总成 INNER MAST	备注 REMARK
M200	D30A8-30212	H30A8-30412	
250	-30222	-30422	
270	-30232	-30432	
300	-30202	-30402	标准 STD
330	-30242	-30442	
350	-30252	-30452	
370	-30262	-30462	
400	-30272	-30472	
425	-30282	-30482	
450	-30292	-30492	
475	-30312	-30512	
500	-30322	-30522	
550	-30332	-30532	
600	-30342	-30542	

CPQ,CPQD35  
CPC,CPCD35

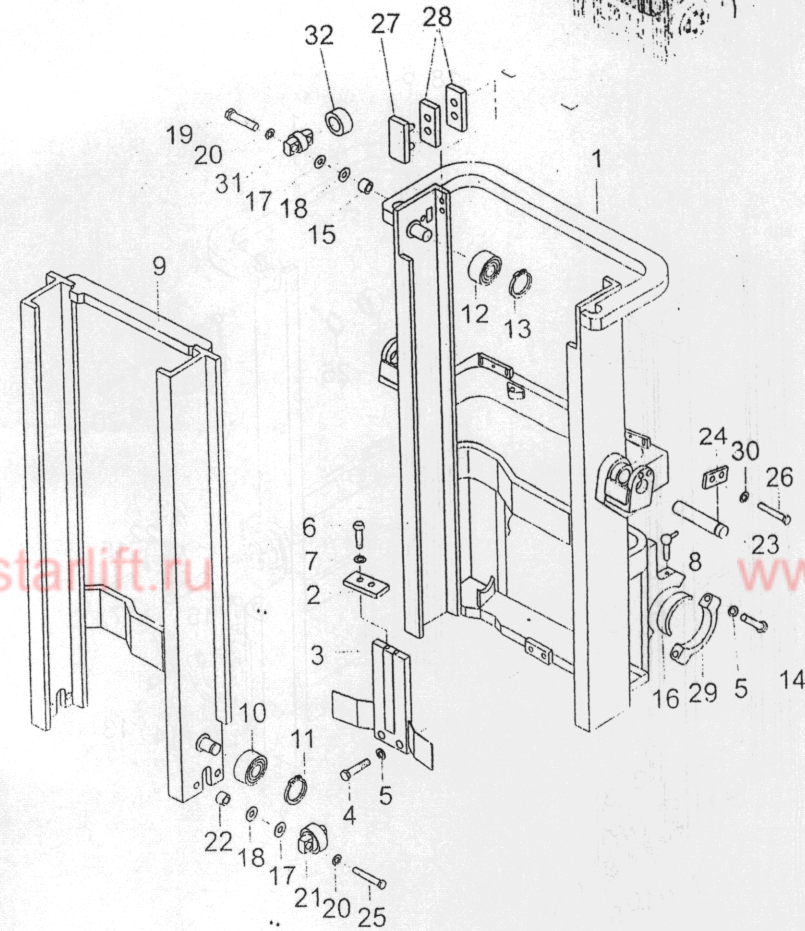



H9

门架(二级全自由)/MAST(FULL FREE 2-STAGE MAST ZM)

图128/FIG128

CPQ,CPQD20,25  
CPC,PCPD20,25

序号 Item No	图号 Part No	零部件名称 Description	件数 Q'ty	备注 Remark
01	HRD20L0401A	Mast ass'y,outer 外门架总成	1	
02	980811N-00	End roller 主滚轮 $\phi 119.2 \times 55-34$	2	
03	B6150-00055	Snap ring 挡圈55	2	GB894.1-86
04	HRD20L0402A	Mast ass'y,inner 内门架总成	1	
05	23458-32051	Side roller 侧滚轮组II $\phi 58$	2	
06	20029-43231*1	Shim 调整垫片0.5	AR	
	- 20029-43231*2	Shim 调整垫片1.0	AR	
07	23818-30071	Spacer 垫块	4	
08	22548-34061	Shim 调整垫圈	4	
09	B5050-00012	Washer,lock 垫圈12	8	GB93-87
10	22548-34051	Shim 调整垫圈	4	
11	22018-30064	Cap 支座盖	2	
12	D20B8-02001	Bushing 轴衬	2	
13	B0430-16065	Bolt 螺栓M16X1.5X65	4	GB5785-86
14	B5050-00016	Washer,lock 垫圈16	4	GB93-87
15	B0530-10020	Bolt 螺栓M10X1.25X20	4	GB5786-86
16	Q701B45	Grease port 弯颈式滑脂嘴	2	ZBT33001.2-88
17	D20B8-02021	Pin axle 销轴	2	
18	20028-32001*G	Slipper 限位滑块	2	
19	B0330-12040	Bolt 螺栓M12X40	4	GB5783-86
20	B0530-12035	Bolt 螺栓M12X1.25X35	4	GB5786-86
21	D20B8-31211	Side roller 侧滚轮组I	2	
22	B5050-00010	Washer,lock 垫圈10	4	GB93-87
23	23648-50161	Plate,stopper 卡板	2	
24	23658-33001	Roller 滚轮2 $\phi 109.7$	2	
25	B6150-00040	Snap ring 挡圈40	2	GB894.1-86

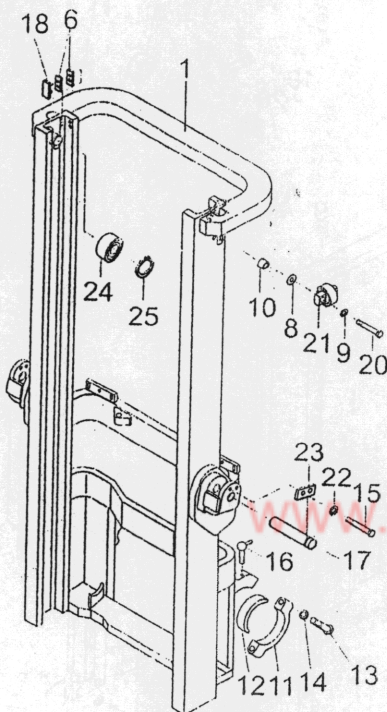
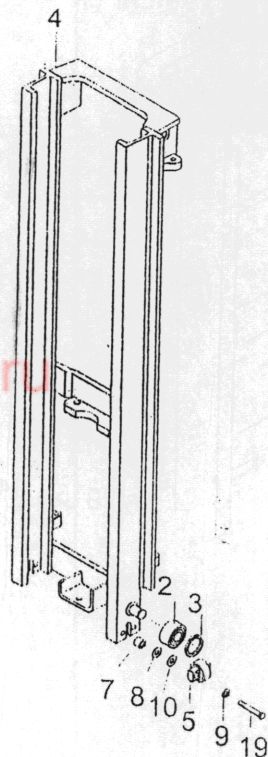
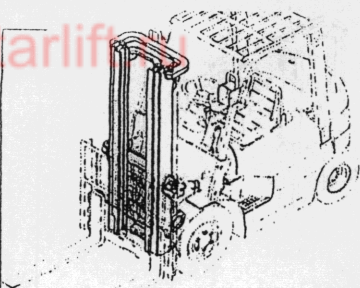



门架选用件表 MAST OPTIONAL PARTS

CPQ, CPQD20, 25  
CPC, CPCD20, 25

起升高度 LIFTING HEIGHT	外门架总成 OUTER MAST	内门架总成 INNER MAST	备注 REMARK
ZM200	HRD20L0401A D20L0-40212	HRD20L0402A D20L0-40512	
225	-40222	-40522	
250	-40232	-40532	
275	-40242	-40542	
270	-40252	-40552	
300	-40202	-40502	标准(STD)
325	-40262	-40662	
330	-40272	-40772	
350	-40282	-40882	
366	-40292	-40792	
370	-40312	-40812	
375	-40322	-40822	
400	-40332	-40832	
425	-40342	-40842	
450	-40352	-40852	
475	-40362	-40862	
500	-40372	-40872	
550	-40382	-40682	
600	-40392	-40892	

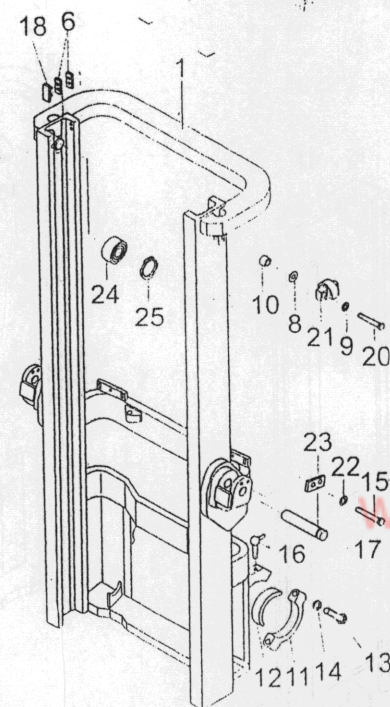
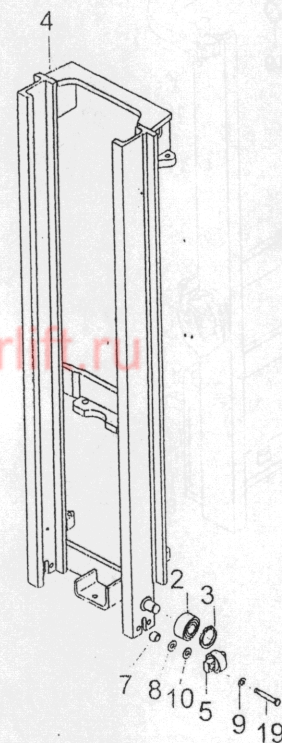



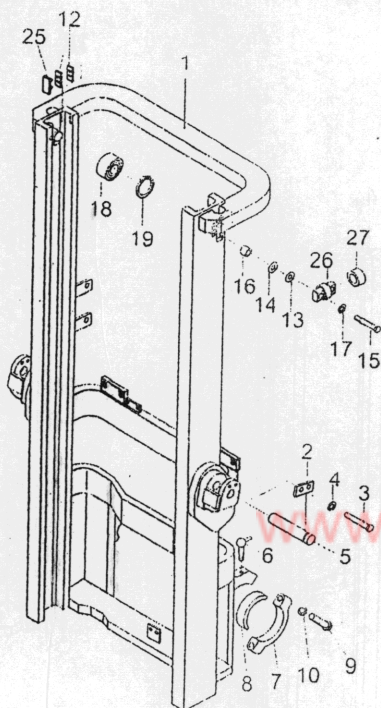
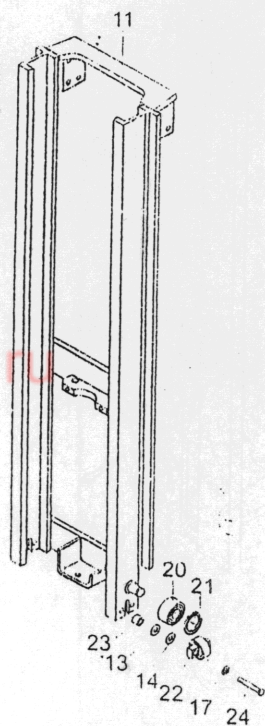
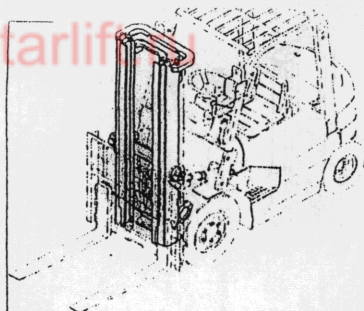

\*CPC,CPCD30  
CPQ,CPQD30

序号 Item No	图号 Part No	零部件名称 Description	件数 Q'ty	备注 Remark
01	HRD28L0401A	Outer mast	1	外门架总成
02	23648-50161	Plate,stopper	2	卡板
03	B0530-10020	Bolt	4	螺栓M10X1.25X20
04	B5050-00010	Washer,lock	4	垫圈10
05	D20B8-02021	Pin	2	销轴
06	Q700B01	Fitting	2	直通式滑脂嘴
07	22018-30064	Cap	2	支座盖
08	D20B8-02001	Bushing	2	轴衬
09	B0430-16070	Bolt	4	螺栓M16X1.5X70
10	B5050-00016	Washer,lock	6	垫圈16
11	HRD28L0402A	Inner mast	1	内门架总成
12	20029-43231*1	Shim	AR	调整垫片0.5
-	20029-43231*2	Shim	AR	调整垫片1.0
13	22548-34051	Shim	10	调整垫圈
14	22548-34061	Shim	14	调整垫圈
15	B0530-12035	Bolt	4	螺栓M12X1.25X35
16	20028-34071	Spacer	4	垫块
17	B5050-00012	Washer,lock	8	垫圈12
18	23658-33001	Roller	2	滚轮Ø109.5
19	B6152-00040	Snap ring	2	挡圈40
20	980811N-00	Roller	2	滚轮Ø119.2X55-34
21	B6150-00055	Snap ring	2	挡圈55
22	23458-32051	Side roller	2	侧滚轮组Ø58
23	23818-30071	Spacer	4	垫块
24	B0330-12040	Bolt	4	螺栓M12X40
25	20028-32001	Slipper	2	限位滑块
A	22548-30601	Side roller(Inc.26.27)	2	侧滚轮组1Ø80
26	22548-34021	Shaft	2	轴
27	22578-22401	Roller	2	限位滚轮



门架选用件表 MAST OPTIONAL PARTS

CPC, CPCD30  
CPQ, CPQD30

起升高度 LIFTING HEIGHT	外门架总成 OUTER MAST	内门架总成 INNER MAST	备注 REMARK
ZM200	HRD28L0401A D28L0-40212	HRD28L0402A D28L0-40512	
225	-40222	-40522	
250	-40232	-40532	
270	-40242	-40542	
275	-40252	-40552	
300	-40202	-40502	
325	-40262	-40662	
330	-40272	-40772	
350	-40282	-40882	
366	-40292	-40792	
370	-40312	-40812	
375	-40322	-40822	
400	-40332	-40832	
425	-40342	-40842	
450	-40352	-40852	
475	-40362	-40862	
500	-40372	-40872	
550	-40382	-40902	
600	-40392	-40892	

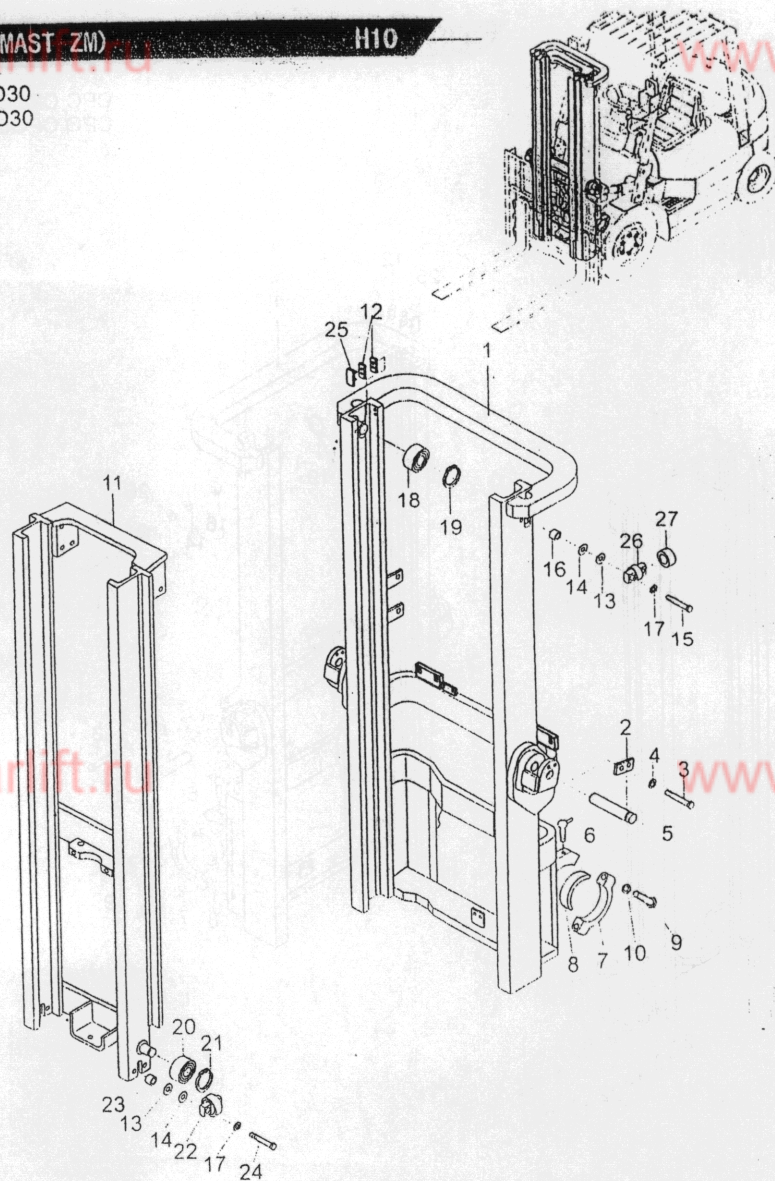

h2000



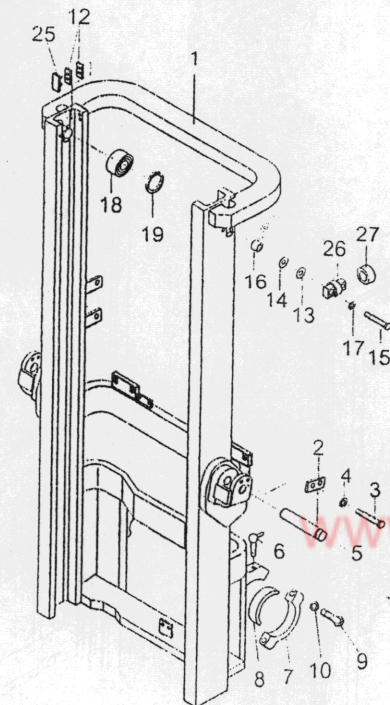
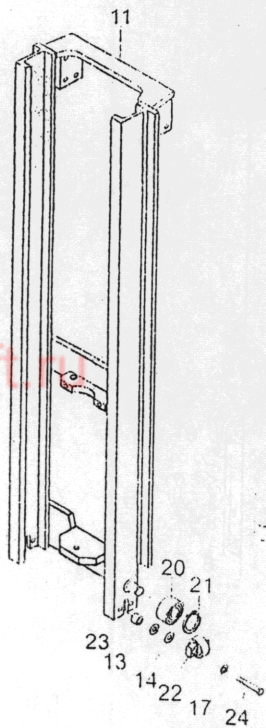
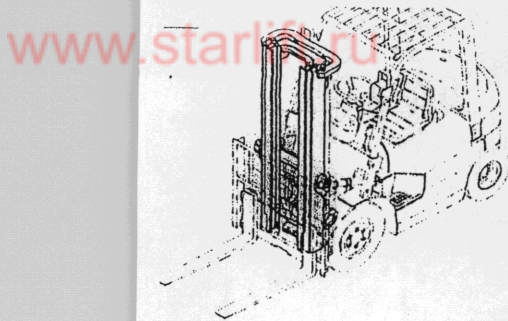

H11

门架(二级全自由)/MAST(FULL FREE 2-STAGE MAST ZM)

图130/F1G130

CPC,CPD35  
CPQ,CPQD35

序号  
Item  
No

图号  
Part No

零部件名称  
Description

件数  
Q'ty

备注  
Remark

01	HRD30K0402A	Outer mast	外门架总成	1	见选用件表 See Op. Parts
02	23648-50161	Plate,stopper	卡板	2	
03	B0530-10020	Bolt	螺栓M10X1.25X20	4	GB5786-86
04	B5050-00010	Washer,lock	垫圈10	4	GB93-87
05	D20B8-02021	Pin	销轴	2	
06	Q700B01	Fitting	直通式滑脂嘴	2	GB1152-76
07	22018-30064	Cap	支座盖	2	
08	D20B8-02001	Bushing	轴衬	2	
09	B0430-16065	Bolt	螺栓M16X1.5X65	4	GB5785-86
10	B5050-00016	Washer,lock	垫圈16	6	GB93-87
11	HRD30K0403A	Inner mast	内门架总成	1	见选用件表 See Op. Parts
12	20029-43231*1	Shim	调整垫片0.5	AR	
-	20029-43231*2	Shim	调整垫片1.0	AR	
13	22548-34051	Shim	调整垫圈	10	
14	22548-34061	Shim	调整垫圈	14	
15	B0530-12035	Bolt	螺栓M12X1.25X35	4	GB5786-86
16	20028-34071	Spacer	垫块	4	
17	B5050-00012	Washer,lock	垫圈12	8	GB93-87
18	23658-33001	Roller	滚轮Ø109.5	2	
19	B6150-00040	Snap ring	挡圈40	2	GB894.1-86
20	980811N-00	Roller	滚轮Ø119.2X55-34	2	
21	B6150-00055	Snap ring	挡圈55	2	GB894.1-86
22	23458-32051	Side roller	侧滚轮组Ø58	2	
23	23818-30071	Spacer	垫块	4	
24	B0530-12040	Bolt	螺栓M12X1.25X40	4	GB5786-86
25	20028-32001*G	Slipper	限位滑块	2	
A	22548-30601	Side roller(Inc.26,27)	侧滚轮组1Ø80	2	
26	22548-34021	Shaft	轴	2	
27	22578-22401	Roller	限位滚轮	2	

0

HELI



门架选用件表 MAST OPTIONAL PARTS

CPC, CPCD35  
CPQ, CPQD35

起升高度 LIFTING HEIGHT	外门架总成 OUTER MAST	内门架总成 INNER MAST	备注 REMARK
KM200	HRD30K0402A D30K0-30212	HRD30K0403A D30K0-30412	
250	-30222	-30422	
270	-30232	-30432	
300	-30202	-30402	标准 (STD)
330	-30242	-30442	
350	-30252	-30452	
370	-30262	-30462	
400	-30272	-30472	
425	-30282	-30482	
450	-30292	-30492	
475	-30312	-30512	
500	-30322	-30522	
550	-30332	-30532	
600	-30342	-30542	

