

56/FIG. 56

图号 Part No	零部件名称 Description	件数 Q'ty	备注 Remark
22018-30064	Cap	2	支座盖
D20B8-02001	Bushing	4	轴衬
B0430-16065	Bolt	4	螺栓M16x1.5x65 GB5785-86
B5050-00016	Washer	2	垫圈16 GB93-87
Q701B45	Fitting	2	弯颈式滑脂嘴45° ZBT33001.2-88 21.2.5t
Q700B01	Fitting	2	直通式滑脂嘴 ZBT33001.1-88 3t
HRH22A8309 H22A8-00201L	Pin	2	倾斜缸销轴
B0530-10020	Bolt	2	螺栓M10x1.25x20 GB5786-86
B5050-00010	Washer	2	垫圈10 GB93-87
HRD24C8301A	Outer mast	1	外门架总成 2t, 2.5t
HRD24N8301A	Outer mast	1	外门架总成 3t
HRD24C8303A	Inner mast	1	内门架总成 2t, 2.5t
HRD24N8303A	Inner mast	1	内门架总成 3t
23458-32051	Shaft	4	侧滚轮组II
22548-34051	Shim	选用	调整垫圈
23818-30071	Spacer	8	垫块
B0330-12040	Bolt	8	螺栓M12x40 GB5783-86
B5050-00012	Washer, lock	8	垫圈12 GB93-87
23658-33001	Roller	2	滚轮2Ø109.7
B6152-00040	Snap ring	2	挡圈40 GB894.1-86
980811N-00	Roller	2	主滚轮Ø119.2X55-34
22548-34061	Shim	8	调整垫圈
20028-32001*G	Slipper	2	限位滑块
20029-43231*1	Shim	AR	调整垫片0.5
20029-43231*2	Shim	AR	调整垫片1.0
B4116-00010	Nut	2	螺母M10 GB6170-86
D24C8-62001	Shaft	2	限位轴
B8030-10040	Screw	2	螺钉M10X40 GB70-85
B6152-00055	Snap ring	2	挡圈55 GB894.1-86

CPC, CPCD20, 25, 30



图56/FIG. 56

门架 (基本型 2-3t) / MAST (NORMAL MAST M)

门架选用件表 Mast Optional Parts

GPC,CPCD20,25,30

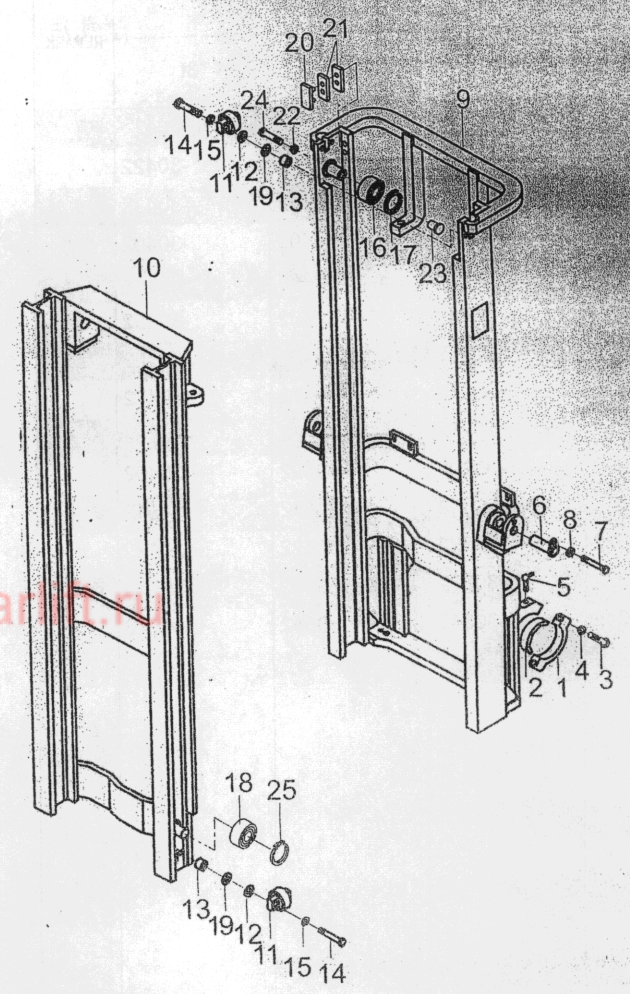
起升高度 IFTING HEIGHT	外门架总成 OUTER MAST		内门架总成 INNER MAST		备注 REMARK
	2t,2.5t	3t	2t,2.5t	3t	
KM200	D24C8-30212	D24N8-30212	D24C8-30412	D24N8-30412	
250	-30222	-30222	-30422	-30422	
270	-30232	-30232	-30432	-30432	
300	-30202	-30202	-30402	-30402	标准 STD
330	-30242	-30242	-30442	-30442	
350	-30252	-30252	-30452	-30452	
370	-30262	-30262	-30462	-30462	
400	-30272	-30272	-30472	-30472	
425	-30282	-30282	-30482	-30482	
450	-30292	-30292	-30492	-30492	
475	-30312	-30312	-30512	-30512	
500	-30322	-30322	-30522	-30522	
550	-30332	-30332	-30532	-30532	
600	-30342	-30342	-30542	-30542	

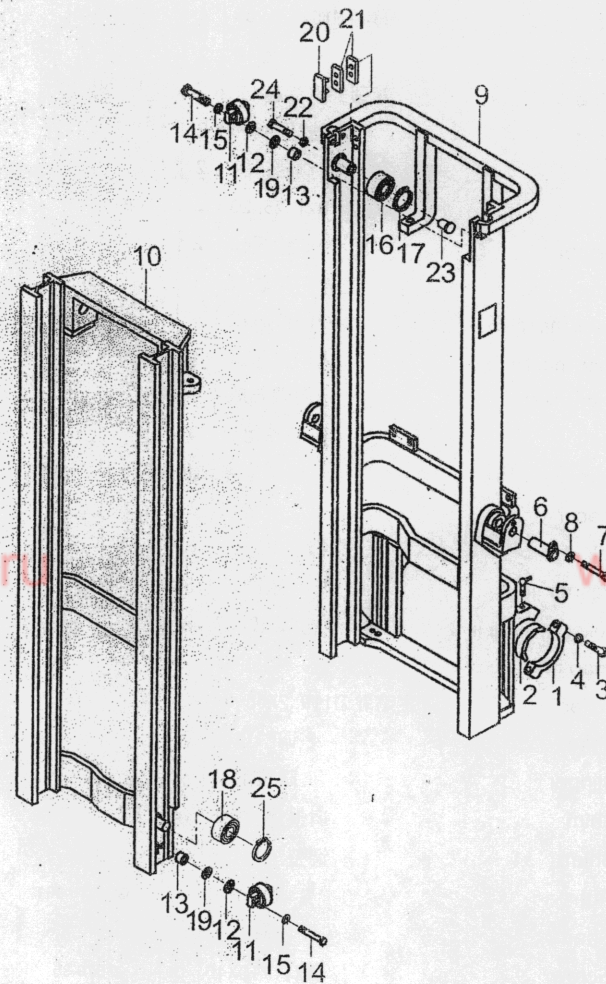

序号 Item No	图号 Part No	零部件名称 Description	件数 Q'ty	备注 Remark
01	HRD30A8301A	Mast ass'y,outer 外门架总成	1	见选用件表 See op.parts
02	27419-43321	Rubber,cushion 缓冲垫	1	
03	D20B8-31201	Bracket,cushion 缓冲支架	1	
04	B0530-16035	Bolt 螺栓M16X1.5X35	2	GB5786-86
05	B5050-00016	Washer,lock 垫圈16	6	GB93-87
06	B1210-06010	Screw 螺钉M6X10	2	GB818-85
07	B5310-00006	Washer 垫圈6	2	GB97.1-85
08	Q700B01	Grease port 直通式滑脂嘴	2	ZBT33001.1-88
09	HRD30A8304A	Mast ass'y,inner 内门架总成	1	见选用件表 See op.parts
10	980811N-00	End roller 主滚轮 ϕ 119.2X55-34	2	
11	B6150-00055	Snap ring 挡圈55	2	GB894.1-86
12	23658-33001	Roller 滚轮2	2	
13	B6150-00040	Snap ring 挡圈40	2	GB894.1-86
14	B0430-16065	Bolt 螺栓M16X1.5X65	4	GB5785-86
15	20028-34071	Spacer 垫块	4	
16	D20B8-02001	Bushing 轴衬	2	
17	22548-34051	Shim 调整垫圈	AR	
18	22548-34061	Shim 调整垫圈	AR	
19	B0530-12035	Bolt 螺栓M12X1.25X35	4	GB5786-86
20	B5050-00012	Washer,lock 垫圈12	8	GB93-87
21	23458-32051	Side roller 侧滚轮组II	2	
22	23818-30071	Spacer 垫块	4	
23	D20B8-02021	Pin axle 销轴	2	
24	23648-50161	Plate,stopper 卡板	2	
25	B0530-12040	Bolt 螺栓M12X1.25X40	4	GB5786-86
26	B0530-10020	Bolt 螺栓M10X1.25X20	4	GB5786-86
27	20028-32001*G	Slipper 限位滑块	2	
28	20029-43231*1	Shim 调整垫片0.5	AR	
-	20029-43231*2	Shim 调整垫片1.0	AR	
29	22018-30064	Cap 支座盖	2	GB93-87

CPC,CPCD35

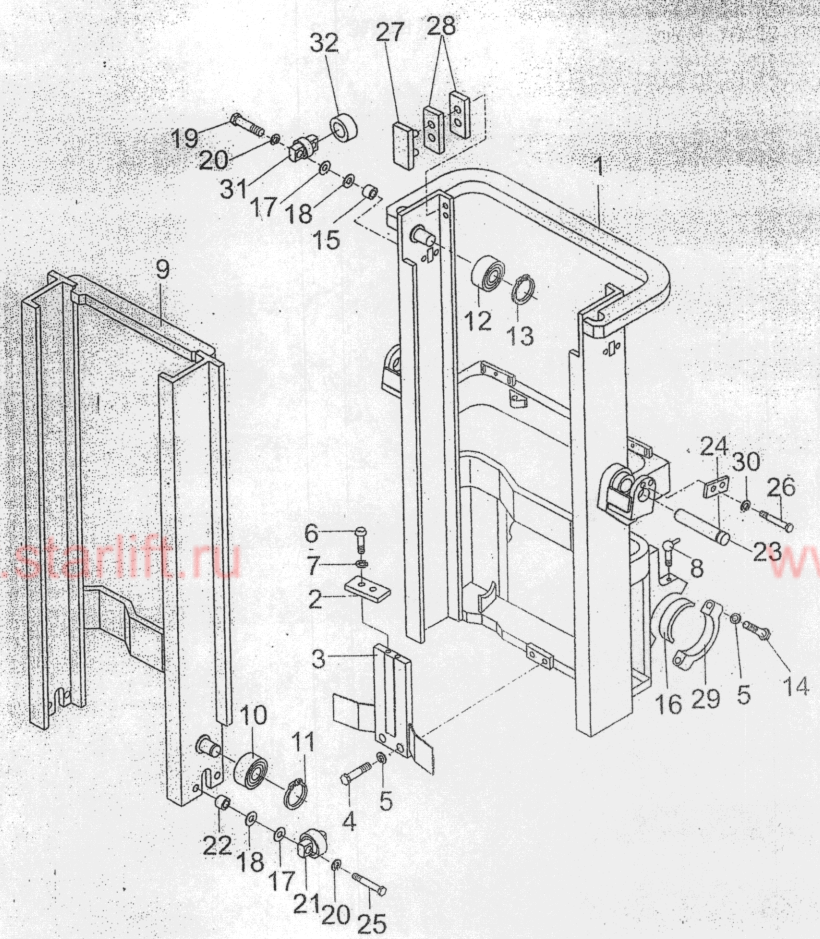

序号 Item No	图号 Part No	零部件名称 Description	件数 Q'ty	备注 Remark
30	B5050-00010	Washer,lock 垫圈10	4	
B	22548-30601	Side roller(Inc.31,32) 侧滚轮组1Ø80	2	
31	22548-34021	Shaft 轴	2	
32	22578-22401	Roller 限位滚轮	2	



图57/FIG. 57

门架(基本型 3.5t)/MAST (NORMAL MAST 'M)

门架选用件表 Mit Optional Parts

提升高度 LIFTING HEIGHT	外门架总成 OUTER MAST	内门架总成 INNER MAST	备注 REMARK
M200	D30A8-30212	H30A8-30412	
250	-30222	-30422	
270	-30232	-30432	
300	-30202	-30402	标准 STD
330	-30242	-30442	
350	-30252	-30452	
370	-30262	-30462	
400	-30272	-30472	
425	-30282	-30482	
450	-30292	-30492	
475	-30312	-30512	
500	-30322	-30522	
550	-30332	-30532	
600	-30342	-30542	

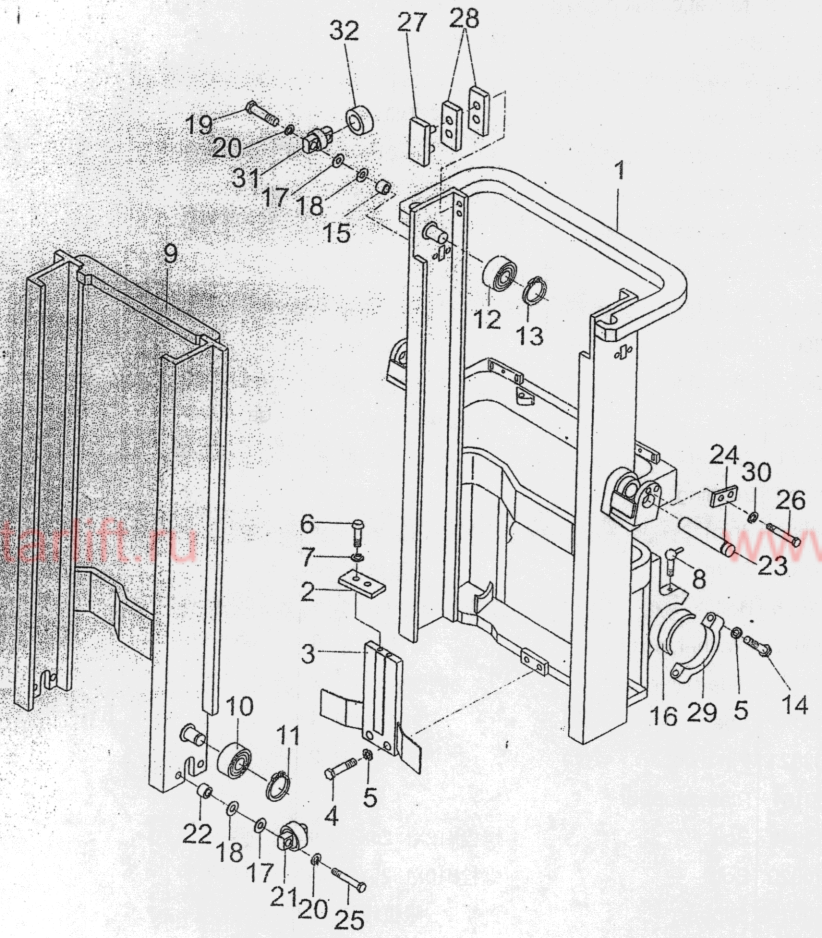
CPC,CPCD35



图58/FIG. 58

门架 (二级全自由 2t, 2.5t) / MAST (FULL FREE 2-STAGE MAST 2M)

序号 Item No	图号 Part No	零部件名称 Description	件数 Q'ty	备注 Remark	CPC, CPCD20, 25
01	HRD20L0401A	Mast ass'y, outer 外门架总成	1		
02	980811N-00	End roller 主滚轮 $\phi 119$. 2X55-34	2		
03	B6150-00055	Snap ring 挡圈 $\phi 55$	2	GB894.1-86	
04	HRD20L0402A	Mast ass'y, inner 内门架总成	1		
05	23458-32051	Side roller 侧滚轮组II $\phi 58$	2		
06	20029-43231*1	Shim 调整垫片0.5	AR		
	20029-43231*2	Shim 调整垫片1.0	AR		
07	23818-30071	Spacer 垫块	4		
08	22548-34061	Shim 调整垫圈	4		
09	B5050-00012	Washer, lock 垫圈12	8	GB93-87	
10	22548-34051	Shim 调整垫圈	4		
11	22018-30064	Cap 支座盖	2		
12	D20B8-02001	Bushing 轴衬	2		
13	B0430-16065	Bolt 螺栓M16X1.5X65	4	GB5785-86	
14	B5050-00016	Washer, lock 垫圈16	4	GB93-87	
15	B0530-10020	Bolt 螺栓M10X1.25X20	4	GB5786-86	
16	Q701B45	Grease port 弯颈式滑脂嘴	2	ZB133001.2-88	
17	D20B8-02021	Pin axle 销轴	2		
18	20028-32001*G	Slipper 限位滑块	2		
19	B0330-12040	Bolt 螺栓M12X40	4	GB5783-86	
20	B0530-12035	Bolt 螺栓M12X1.25X35	4	GB5786-86	
21	D20B8-31211	Side roller 侧滚轮组I	2		
22	B5050-00010	Washer, lock 垫圈10	4	GB93-87	
23	23648-50161	Plate, stopper 卡板	2		
24	23658-33001	Roller 滚轮 $2\phi 109.7$	2		
25	B6150-00040	Snap ring 挡圈 $\phi 40$	2	GB894.1-86	

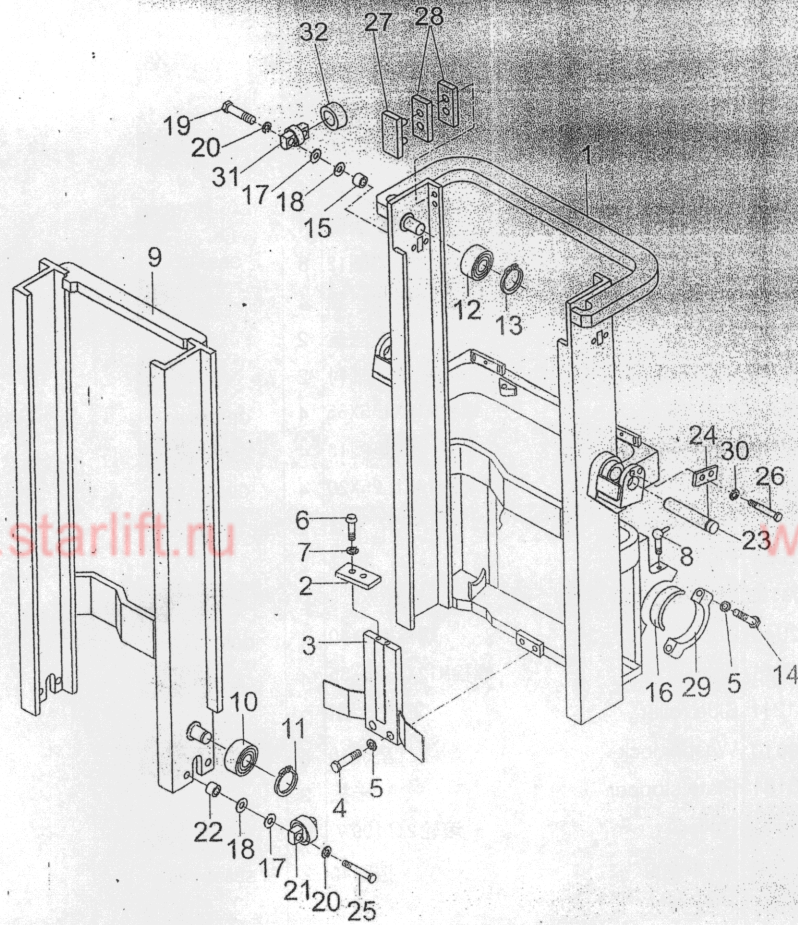
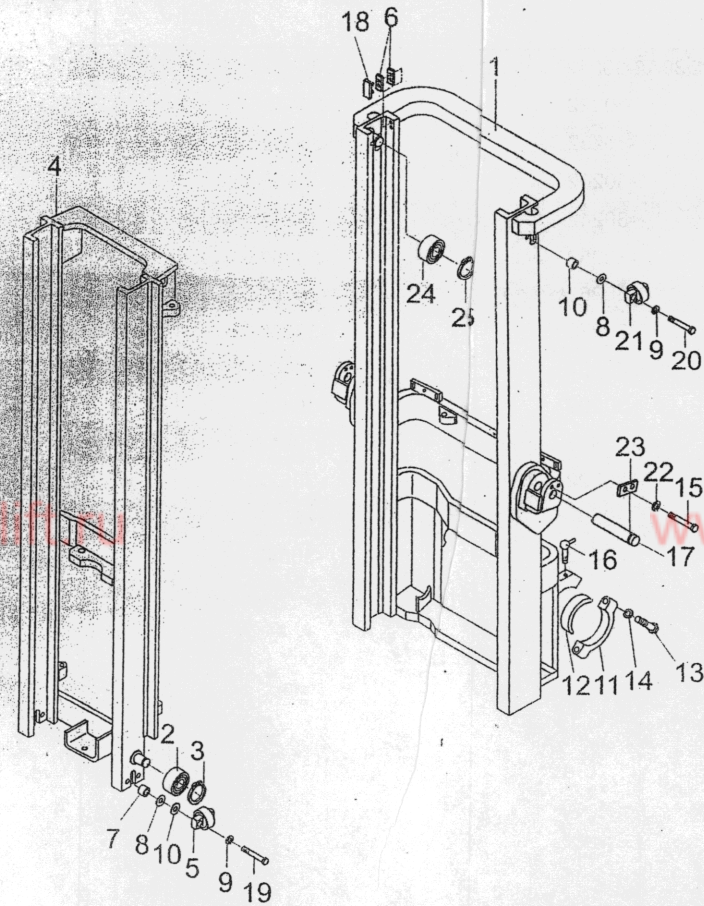

门架选用件表 MAST OPTIONAL PARTS

CPC,CPCD20,25

起升高度 LIFTING HEIGHT	外门架总成 OUTER MAST	内门架总成 INNER MAST	备注 REMARK
ZM200	HRD20L0401A D20L0-40212	HRD20L0402A D20L0-40512	
225	-40222	-40522	
250	-40232	-40532	
275	-40242	-40542	
270	-40252	-40552	
300	-40202	-40502	标准 (STD)
325	-40262	-40662	
330	-40272	-40772	
350	-40282	-40882	
366	-40292	-40792	
370	-40312	-40812	
375	-40322	-40822	
400	-40332	-40832	
425	-40342	-40842	
460	-40352	-40852	
475	-40362	-40862	
500	-40372	-40872	
550	-40382	-40682	
600	-40392	-40892	

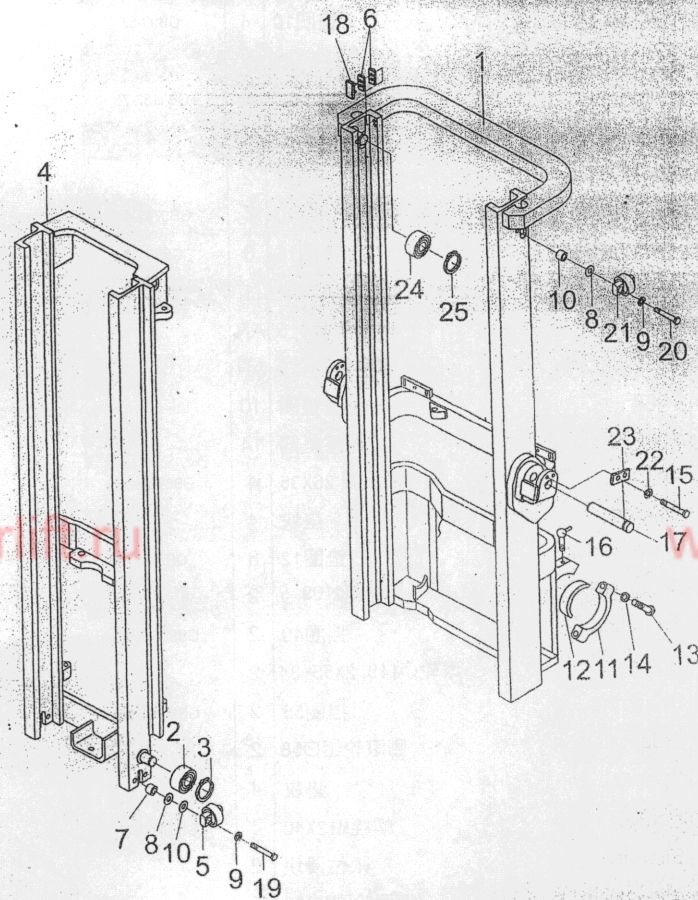

序号 Item No	图号 Part No	零部件名称 Description	件数 Q'ty	备注 Remark
01	HRD28L0401A	Outer mast 外门架总成	1	见选用件表 See Op. Parts
02	23648-50161	Plate, stopper 卡板	2	
03	B0530-10020	Bolt 螺栓M10X1.25X20	4	GB5786-86
04	B5050-00010	Washer, lock 垫圈10	4	GB93-87
05	D20B8-02021	Pin 销轴	2	
06	Q700B01	Fitting 直通式滑脂嘴	2	GB1152-76
07	22018-30064	Cap 支座盖	2	
08	D20B8-02001	Bushing 轴衬	2	
09	B0430-16070	Bolt 螺栓M16X1.5X70	4	GB5785-86
10	B5050-00016	Washer, lock 垫圈16	6	GB93-87
11	HRD28L0402A	Inner mast 内门架总成	1	见选用件表 See Op. Parts
12	20029-43231*1	Shim 调整垫片0.5	AR	
-	20029-43231*2	Shim 调整垫片1.0	AR	
13	22548-34051	Shim 调整垫圈	10	
14	22548-34061	Shim 调整垫圈	14	
15	B0530-12035	Bolt 螺栓M12X1.25X35	4	GB5786-86
16	20028-34071	Spacer 垫块	4	
17	B5050-00012	Washer, lock 垫圈12	8	GB93-87
18	23658-33001	Roller 滚轮 $\phi 109.5$	2	
19	B6152-00040	Snap ring 挡圈40	2	GB894.1-86
20	980811N-00	Roller 滚轮 $\phi 119.2 \times 55-34$	2	
21	B6150-00055	Snap ring 挡圈55	2	GB894.1-86
22	23458-32051	Side roller 侧滚轮组 $\phi 58$	2	
23	23818-30071	Spacer 垫块	4	
24	B0330-12040	Bolt 螺栓M12X40	4	GB5783-86
25	20028-32001	Slipper 限位滑块	2	
A	22548-30601	Side roller (Inc. 26, 27) 侧滚轮组 $\phi 80$	2	
26	22548-34021	Shaft 轴	2	
27	22578-22401	Roller 限位滚轮	2	

CPC, CPCD30

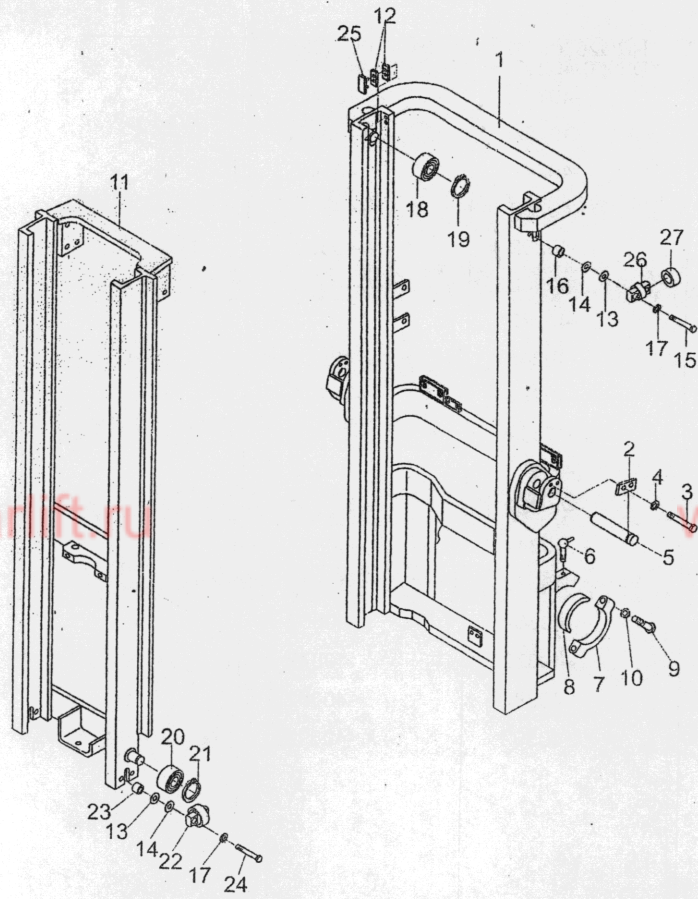

门架选用件表 MAST OPTIONAL PARTS

CPC, GPCD30

起升高度 LIFTING HEIGHT	外门架总成 OUTER MAST	内门架总成 INNER MAST	备注 REMARK
ZM200	HRD28L0401A D28L0-40212	HRD28L0402A D28L0-40512	
225	-40222	-40522	
250	-40232	-40532	
270	-40242	-40542	
275	-40252	-40552	
300	-40202	-40502	
325	-40262	-40662	
330	-40272	-40772	
350	-40282	-40882	
366	-40292	-40792	
370	-40312	-40812	
375	-40322	-40822	
400	-40332	-40832	
425	-40342	-40842	
450	-40352	-40852	
475	-40362	-40862	
500	-40372	-40872	
550	-40382	-40902	
600	-40392	-40892	

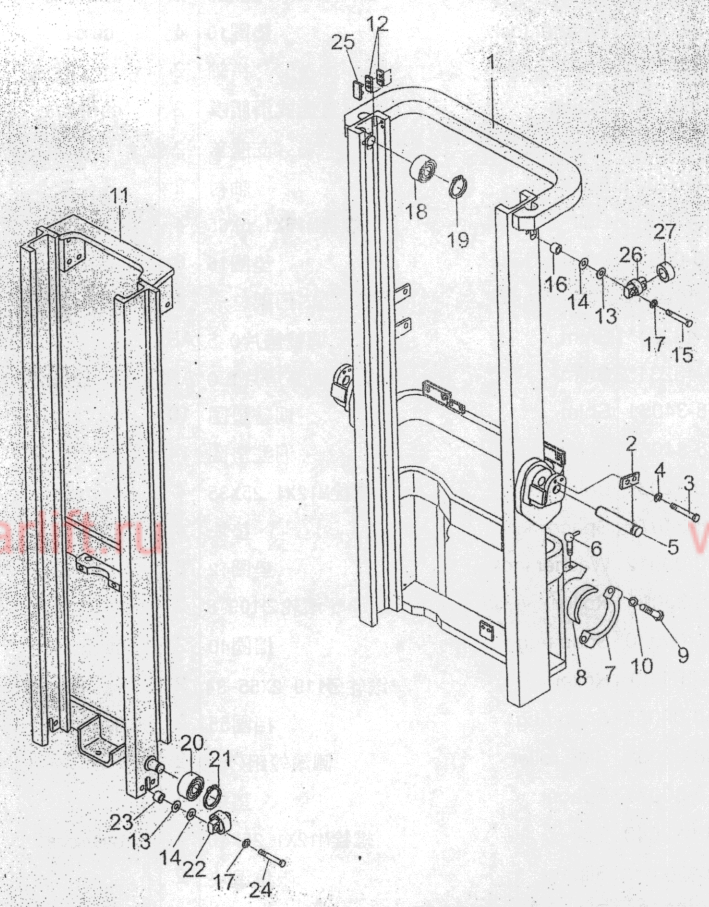

序号 Item No	图号 Part No	零部件名称 Description	件数 Q'ty	备注 Remark
01	HRD30K0402A	Outer mast 外门架总成	1	见选用件表 See Op. Parts
02	23648-50161	Plate, stopper 卡板	2	
03	B0530-10020	Bolt 螺栓M10X1.25X20	4	GB5786-86
04	B5050-00010	Washer, lock 垫圈10	4	GB93-87
05	D20B8-02021	Pin 销轴	2	
06	Q700B01	Fitting 直通式滑脂嘴	2	GB1152-76
07	22018-30064	Cap 支座盖	2	
08	D20B8-02001	Bushing 轴衬	2	
09	B0430-16065	Bolt 螺栓M16X1.5X65	4	GB5785-86
10	B5050-00016	Washer, lock 垫圈16	6	GB93-87
11	HRD30K0403A	Inner mast 内门架总成	1	见选用件表 See Op. Parts
12	20029-43231*1	Shim 调整垫片0.5	AR	
	20029-43231*2	Shim 调整垫片1.0	AR	
13	22548-34051	Shim 调整垫圈	10	
14	22548-34061	Shim 调整垫圈	14	
15	B0530-12035	Bolt 螺栓M12X1.25X35	4	GB5786-86
16	20028-34071	Spacer 垫块	4	
17	B5050-00012	Washer, lock 垫圈12	8	GB93-87
18	23658-33001	Roller 滚轮 $\varnothing 109$	2	
19	B6150-00040	Snap ring 挡圈40	2	GB894.1-86
20	980811N-00	Roller 滚轮 $\varnothing 119$: 2X55-34	2	
21	B6150-00055	Snap ring 挡圈55	2	GB894.1-86
22	23458-32051	Side roller 侧滚轮组 $\varnothing 58$	2	
23	23818-30071	Spacer 垫块	4	
24	B0530-12040	Bolt 螺栓M12X1.25X40	4	GB5786-86
25	20028-32001*G	Slipper 限位滑块	2	
A	22548-30601	Side roller (Inc. 26, 27) 侧滚轮组 $\varnothing 80$	2	
26	22548-34021	Shaft 轴	2	
27	22578-22401	Roller 限位滚轮	2	

CPC, CPCD35

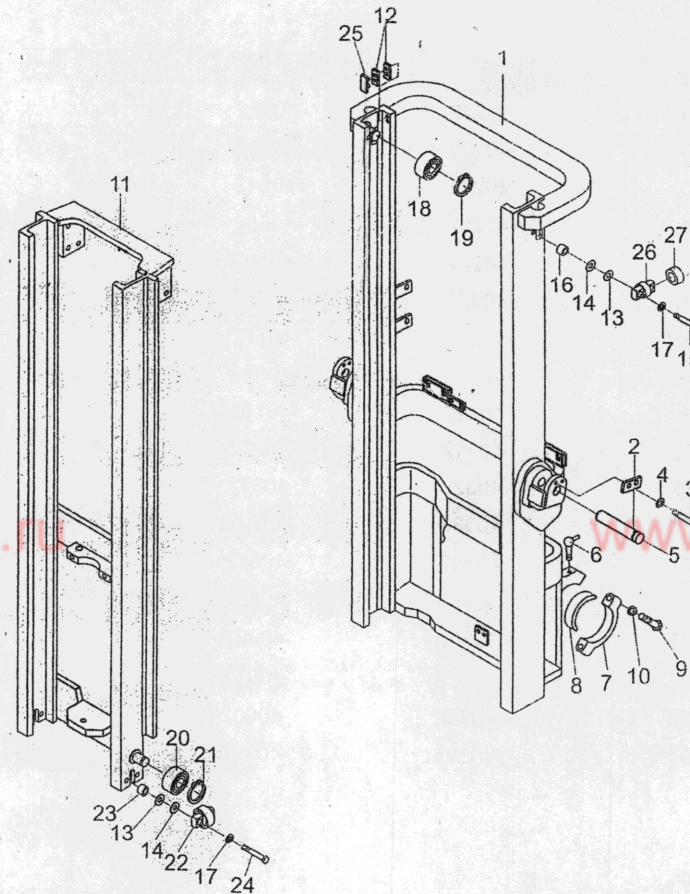

门架选用件表 MAST OPTIONAL PARTS

CPC, CPCD35

起升高度 LIFTING HEIGHT	外门架总成 OUTER MAST	内门架总成 INNER MAST	备注 REMARK
KM200	HRD30K0402A D30K0-30212	HRD30K0403A D30K0-30412	
250	-30222	-30422	
270	-30232	-30432	
300	-30202	-30402	标准 (STD)
330	-30242	-30442	
350	-30252	-30452	
370	-30262	-30462	
400	-30272	-30472	
425	-30282	-30482	
450	-30292	-30492	
475	-30312	-30512	
500	-30322	-30522	
550	-30332	-30532	
600	-30342	-30542	

