

驱动桥 Drive axle

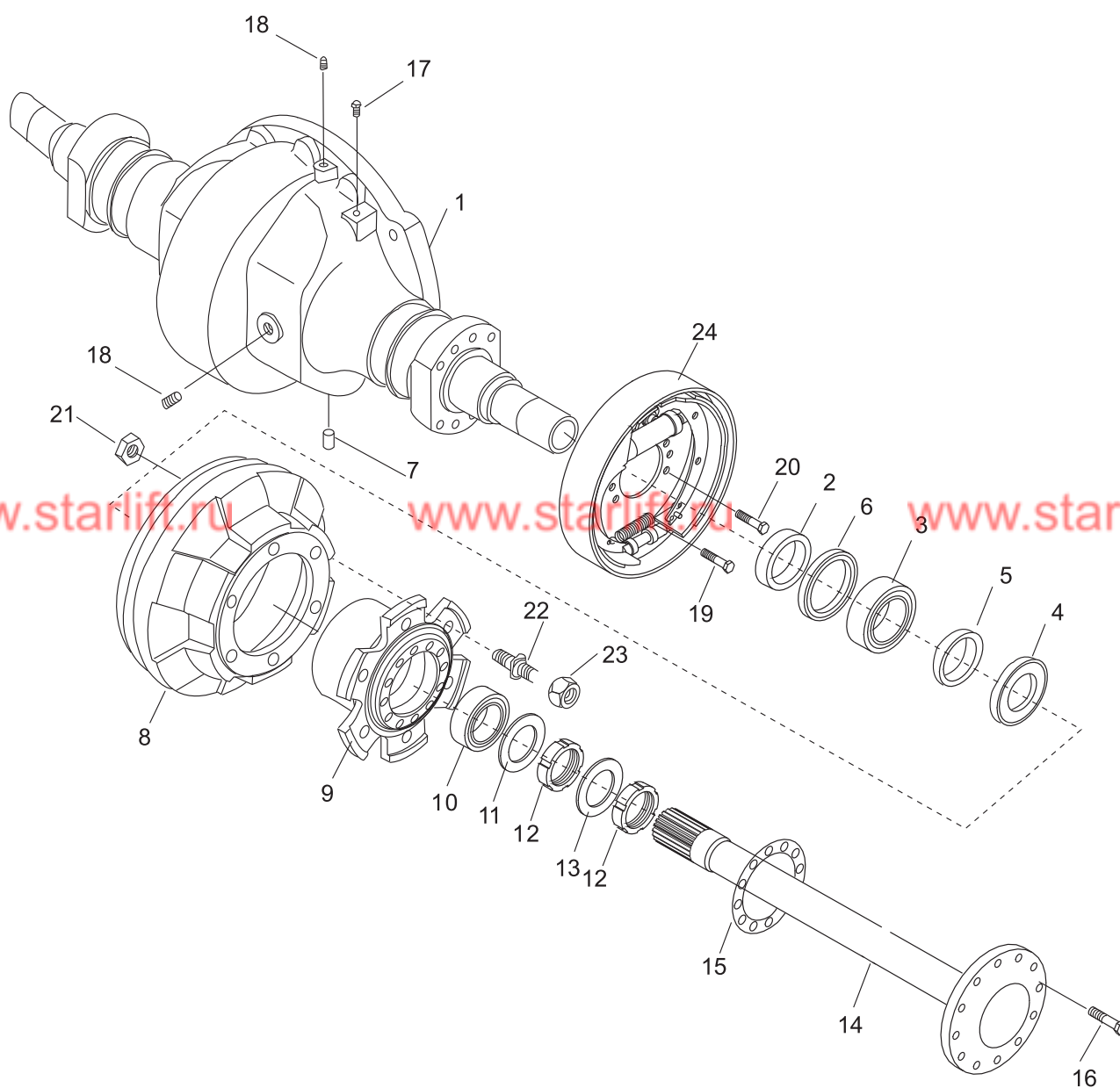

驱动桥

Drive axle

序号 Item	零件号 Part No	零部件名称 Description	数量 Q'ty	备注 Remark
1	A30A5-02112	桥壳 Housing, axle	1	3t
	A20A5-02112	桥壳 Housing, axle	1	2-2.5t
	A35A5-02101	桥壳 Housing, axle	1	3.5t
2	A30A5-02111	油封挡圈 Retainer, oil seal	2	
3	GB9877.1-88	油封 Sd100×125×12 Seal, oil	2	
4	A30A5-02119	挡油圈 Retainer	2	
5	A30A5-02120	备用垫 Washer	2	
6	A30A5-02117	轴承7214E Bearing	2	
7	GB/T119-2000	销 D10×30 Pin	1	
8	A30A5-02101	制动毂 Drum, brake	2	3t
	A20A5-02101	制动毂 Drum, brake	2	2-2.5t
	A35A5-02102	制动毂 Drum, brake	2	3.5t
9	A30A5-02102	轮毂 Hub, front	2	3t
	A20A5-02102	轮毂 Hub, front	2	2-2.5t
	A35A5-02103	轮毂 Hub, front	2	3.5t
10	A30A5-02103	轴承油封总成 Seal, oil ass'y	2	
11	A30A5-02105	垫 Packing	2	
12	GB/T810-88	螺母M60×2 Nut	4	
13	GB/T858-88	垫圈60 Washer	2	
14	A30A5-02106	半轴 Shaft, drive	2	3t
	A20A5-02106	半轴 Shaft, drive	2	2-2.5t
	A35A5-02104	半轴 Shaft, drive	2	3.5t

驱动桥 Drive axle

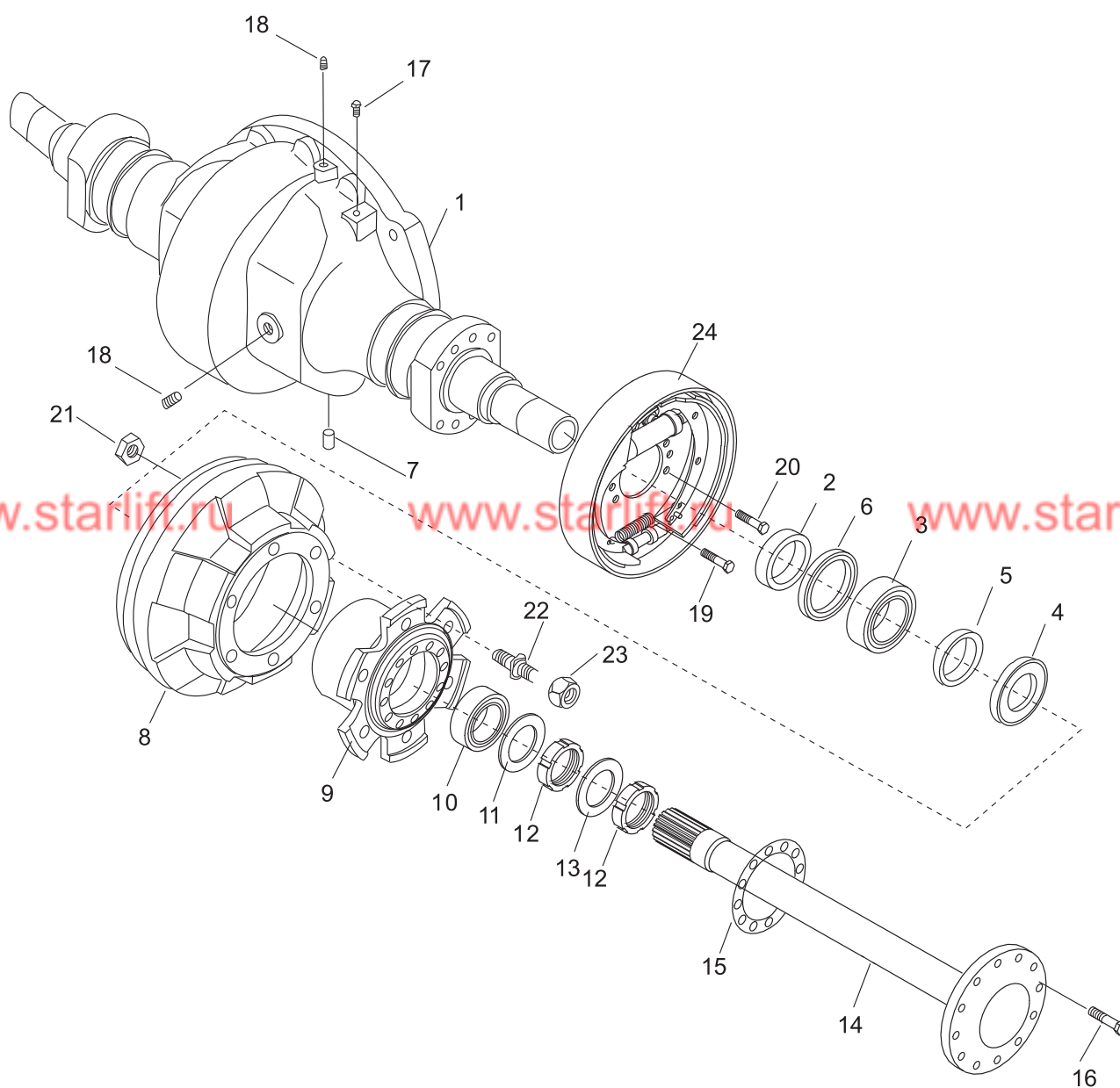

驱动桥

Drive axle

序号 Item	零件号 Part No	零部件名称 Description	数量 Q'ty	备注 Remark
15	A30A5-02107	半轴垫 Packing	2	
16	A30A5-02104	螺栓 Bolt	24	
17	A30A5-02113	通气塞总成 Breather, air	1	
18	A30A5-02114	堵塞 Plug	3	
19	A30A5-02115	螺栓 Bolt	12	
20	A30A5-02116	螺栓 Bolt	4	
21	GB/T6171-2000	螺母M20×1.5 Nut	12	
22	A30A5-02108	螺栓柱 Bolt	12	3t
	A20A5-02108	螺栓柱 Bolt	12	2-2.5t
	A35A5-02105	螺栓柱 Bolt	12	3.5t
23	A30A5-02109	球螺母 Nut	12	3t
	A20A5-02109	球螺母 Nut	12	2-2.5t
	A35A5-02106	球螺母 Nut	12	3.5t
24	A30A5-02800	制动器总成 Wheel brake	1	3t
	A20A5-02800	制动器总成 Wheel brake	1	2-2.5t
	A35A5-02200	制动器总成 Wheel brake	1	3.5t

驱动轮总成
Driving wheel assembly

2-2.5T

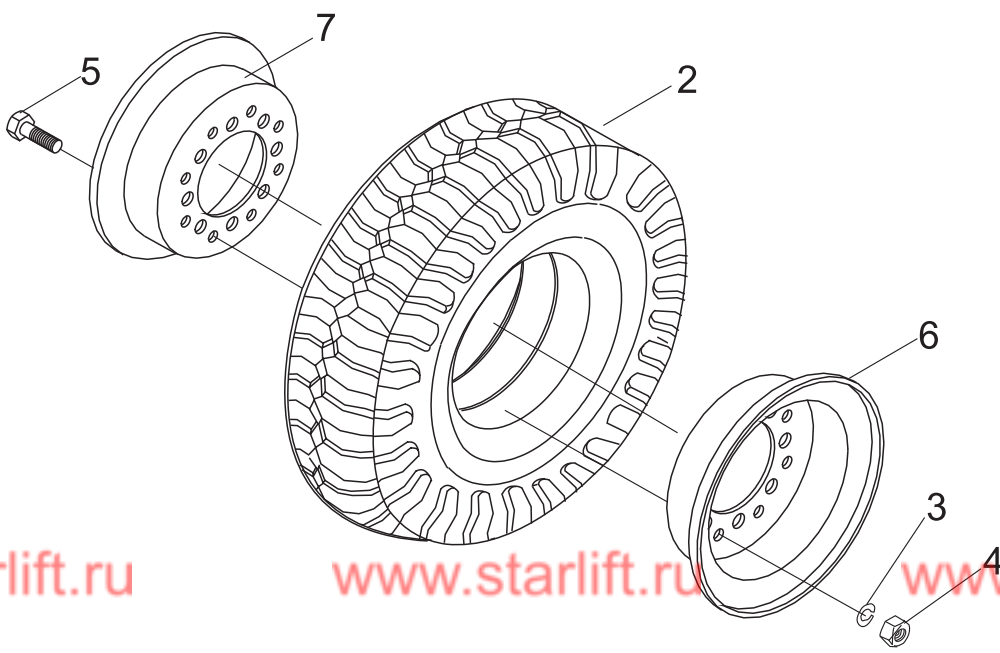

3-3.5T

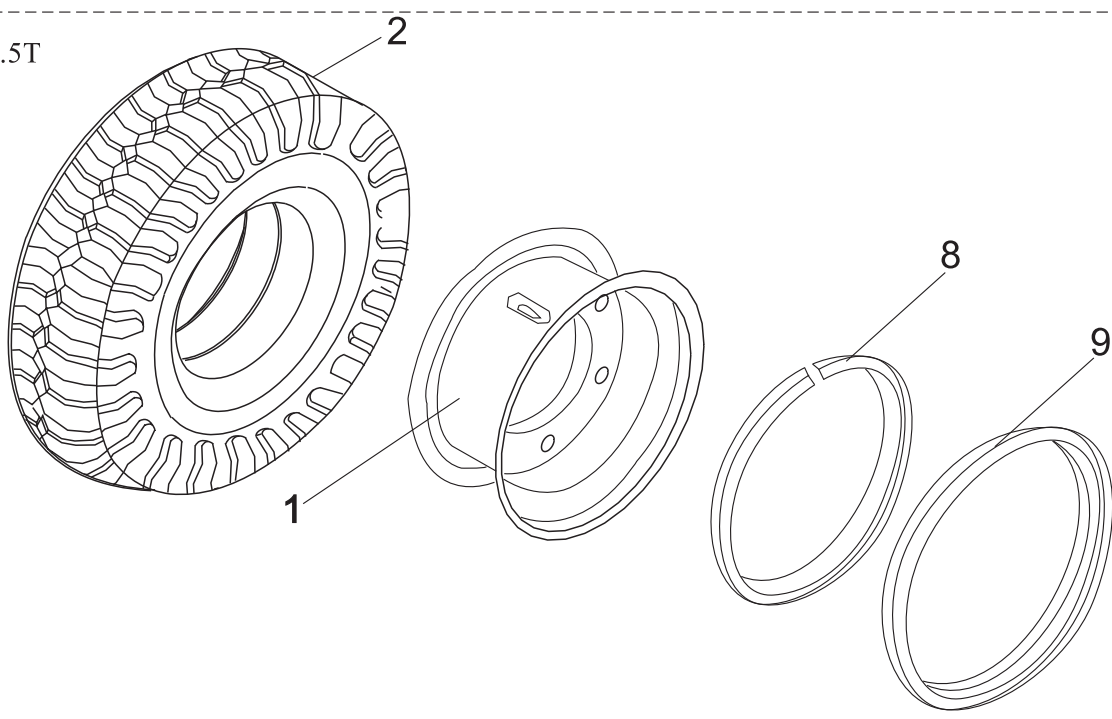

驱动轮总成

Driving wheel assembly

序号 Item	零件号 Part No	零部件名称 Description	数量 Q'ty	备注 Remark
1	A30A5-01000	轮辋总成(包含8,9) Rim ass'y(Inc.8,9)	2	3-3.5t
2	GB2982-82	轮胎28×9-15-12PR Tyre	2	3-3.5t
	GB2982-82	轮胎7.00-12-12PR Tyre	2	2-2.5t
3	GB/T93-1987	弹垫16 Washer,lock	12	2-2.5t
4	GB/T6170-2000	螺母M16 Nut	12	2-2.5t
5	A20C5-00001	轮辋螺栓 Bolt	12	2-2.5t
6	A20A5-01001	外轮辋 Rim outside	2	2-2.5t
7	A20A5-01002	内轮辋 Rim inside	2	2-2.5t
8	A30A5-01001	锁圈 Lock ring	2	3-3.5t
9	A30A5-01002	挡圈 Snap ring	2	3-3.5t