

01-02-01

转向桥 (2C) STEERING WHEEL (2C)

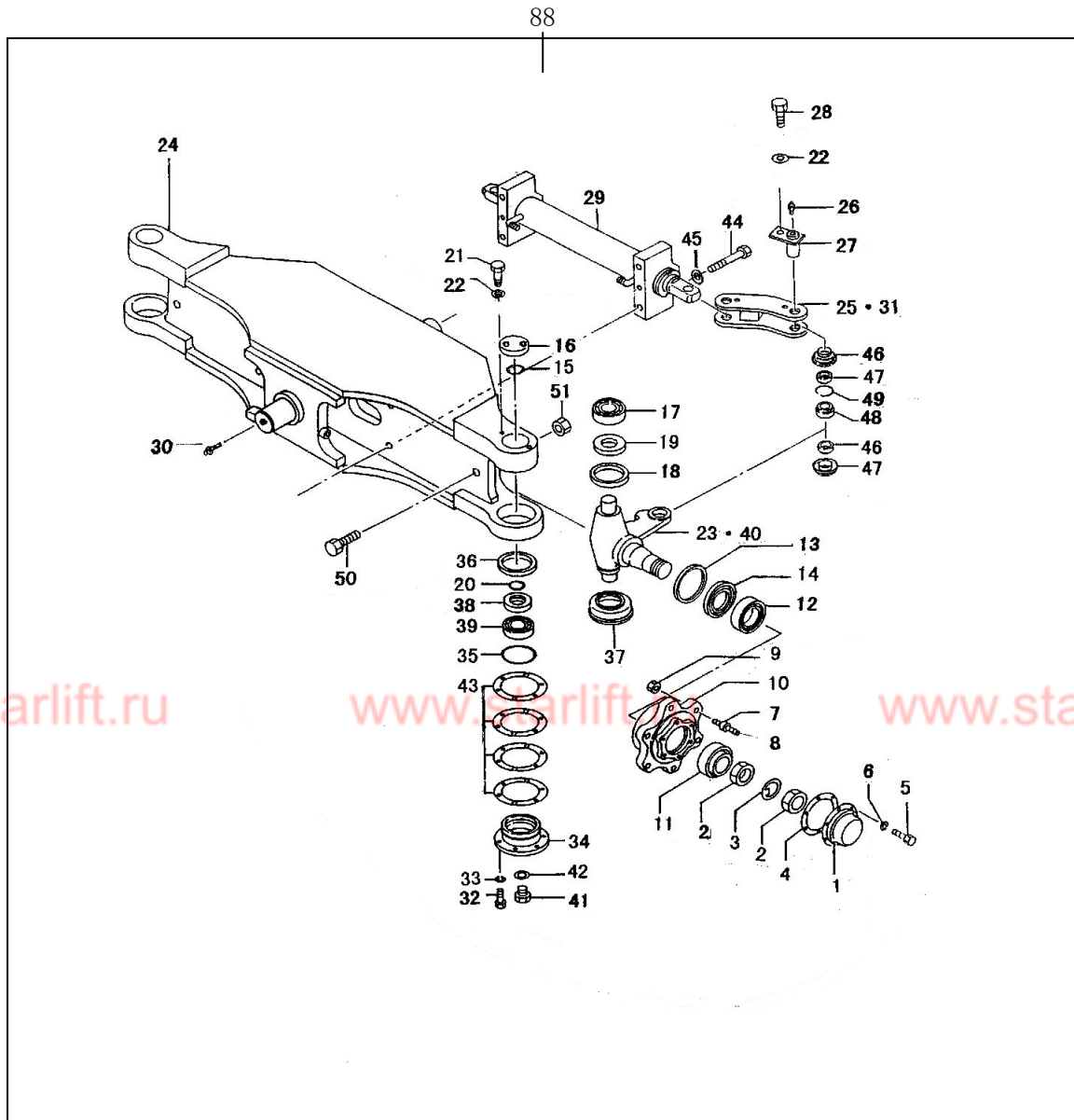

01-02-01

转向桥 STEERING AXLE

- 01: CPCD50 (CD-AA)
- 04: GPCD50 (CD-FA)
- 02: CPCD60 (CD-AA)
- 05: GPCD60 (CD-FA)
- 03: CPCD70 (CD-AA)
- 06: GPCD70 (CD-FA)

序号 ITEM NO	零件编号 PART NO.	零件名称及规格 PART NAME & DESCRIPTION	数量 Q' TY						备注 REMARK
			适用车型 APPLICABLE SERIAL NO						
			01	02	03	04	05	06	
1	A847.2-1	轴头盖 CAP	2	2	2	2	2	2	
2	A847.2-2	螺母 NUT	4	4	4	4	4	4	
3	A847.2-3	制动垫圈 LOCK WASHER	2	2	2	2	2	2	
4	A847.2-19	垫 GASKET	2	2	2	2	2	2	
5	GB5781	螺栓 M8×16 BOLT M8×16	12	12	12	12	12	12	
6	GB93	垫圈 8 LOCK WASHER	12	12	12	12	12	12	
7	A847.2-4	轮毂螺母 WHEEL HUB NUT	12	12	12	12	12	12	
8	A847.2-6	轮毂螺柱 WHEEL HUB STUD	12	12	12	12	12	12	
9	A847.2-7	轮毂螺帽 WHEEL HUB NUT	12	12	12	12	12	12	
10	A847.2-8	轮毂 WHEEL HUB	2	2	2	2	2	2	
11	GB/T 297-1994	滚动轴承 BEARING	2	2	2	2	2	2	
12	GB/T 297-1994	滚动轴承 BEARING	2	2	2	2	2	2	
13	120-31040206	油封 $\phi 93 \times \phi 139 \times 16.5$ OIL SEAL	2	2	2	2	2	2	
14	A847.2C-1	挡环 SNAP RING	2	2	2	2	2	2	
15	GB1235-1976	O型密封圈 90×3.1 O-RING	2	2	2	2	2	2	
16	A847.2C-2	盖 COVER	2	2	2	2	2	2	
17	GB/T 297-1994	滚动轴承 31309 BEARING	2	2	2	2	2	2	
18	GB9788.1-1988	油封 B100×125×12 OIL SEAL	2	2	2	2	2	2	
19	A847.2C-3	油封挡环 STOPPER RING	2	2	2	2	2	2	
20	GB1235-1976	O型密封圈 50×3.1 O-RING	4	4	4	4	4	4	
21	GB5783	螺栓 M6×16 BOLT M6×16	12	12	12	12	12	12	
22	GB93	垫圈 6 WASHER 6	24	24	24	24	24	24	
23	A847.2C.1	转向节(左) LEFT STEERING KNUCKLE	1	1	1	1	1	1	
24	A847.2C.2	后桥体 STEERING AXLE	1	1	1	1	1	1	
25	A847.2C-4	联接座(左) LEFT COUPLING SEAT	1	1	1	1	1	1	
26	GB1153-1989	油杯 45° M10×1 GASKET NIPPLE	4	4	4	4	4	4	
27	A847.2B.4	轴 SHAFT	4	4	4	4	4	4	
28	GB5783	螺栓 M6×12 BOLT M6×12	12	12	12	12	12	12	
29	A847.19C.1	转向油缸 STEERING CYLINDER	1	1	1	1	1	1	
30	GB1152-1989	油杯 M10×1 GASKET NIPPLE	2	2	2	2	2	2	
31	A847.2C-9	联接座(右) RIGHT COUPLING SEAT	1	1	1	1	1	1	
32	GB5786	螺栓 M10×1.25×30 BOLT	16	16	16	16	16	16	
33	GB93	垫圈 10 WASHER	16	16	16	16	16	16	
34	A847.2C-5	盖 COVER	2	2	2	2	2	2	
35	GB1235-1976	O型密封圈 O-RING	2	2	2	2	2	2	
36	GB9877.1-1988	油封 B80×100×10 OIL SEAL	2	2	2	2	2	2	
37	A847.2C-6	下防尘罩 DUST COVER	2	2	2	2	2	2	
38	A847.2C-7	油封挡环 STOPPER RING	2	2	2	2	2	2	
39	GB/T 297-1994	滚动轴承 32209 BEARING	1	1	1	1	1	1	
40	A847.2C.3	转向节(右) RIGHT STEERING KNUCKLE							

41	JB1000-1977	螺塞 16×1.5 BOLT 16×1.5	2	2	2	2	2	2	
42	JB1002-1977	垫圈 16 LOCK WASHER 16	2	2	2	2	2	2	
43	A847.2C-10	调整垫片 SHIM	4组	4组	4组	4组	4组	4组	
44	GB27	螺栓 M16×1.5×70 BOLT M16×1.5×70	4	4	4	4	4	4	
45	GB93	垫圈 18 WASHER18							
46	A847.2C-8	防尘罩 DUST COVER	8	8	8	8	8	8	
47	A847.2B-6	隔套 SPACER	8	8	8	8	8	8	
48	GB9163-1990	关节轴承 GE25ES-2RS SPHERICAL PLAIN BEARINGS	4	4	4	4	4	4	
49	GB893.1	挡圈 42 SNAP RING 42	4	4	4	4	4	4	
50	A847.2-17	螺钉 SCREW	2	2	2	2	2	2	

01-02-01

转向桥 (2B)
STEERING WHEEL (2B)

89

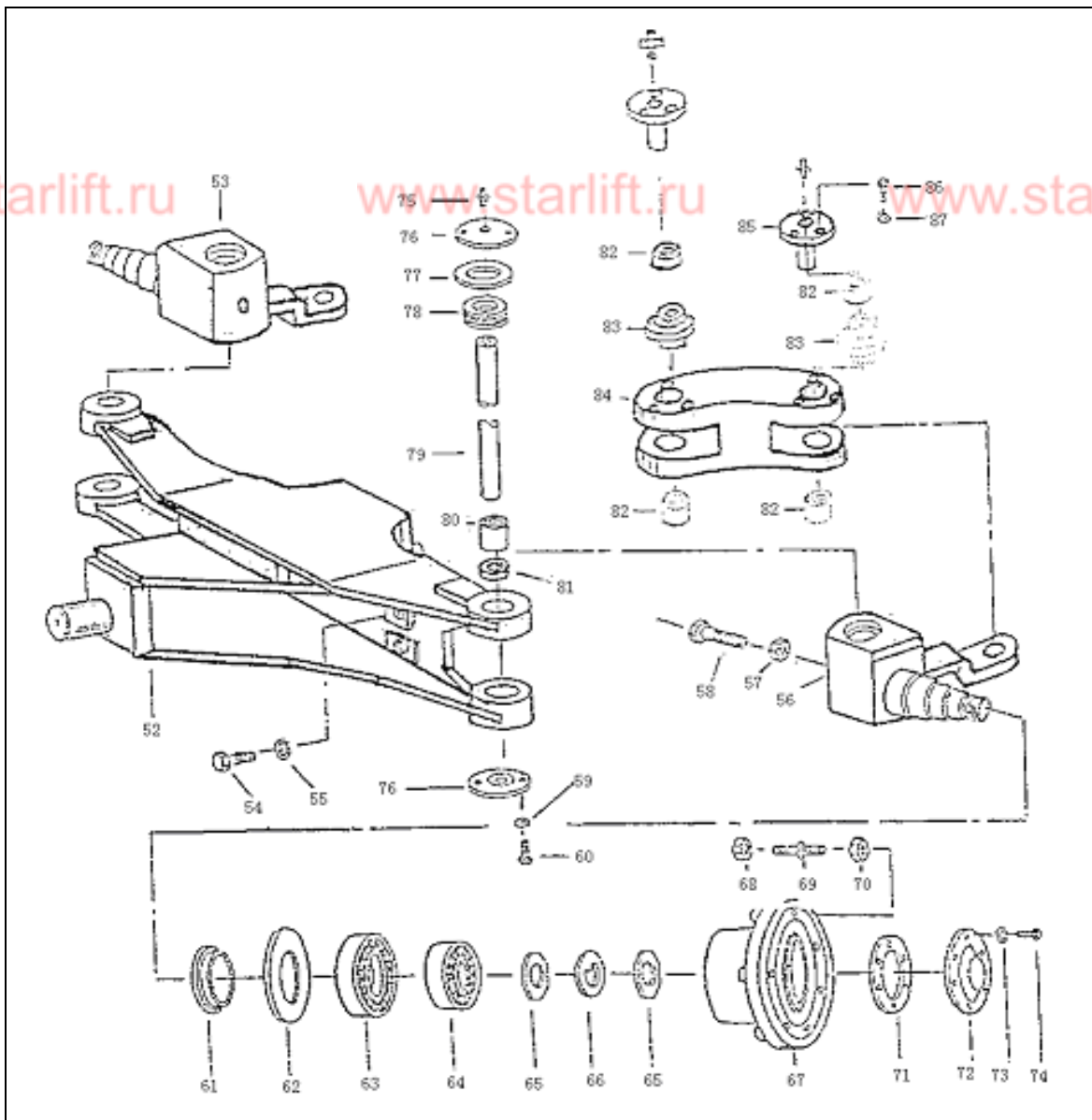

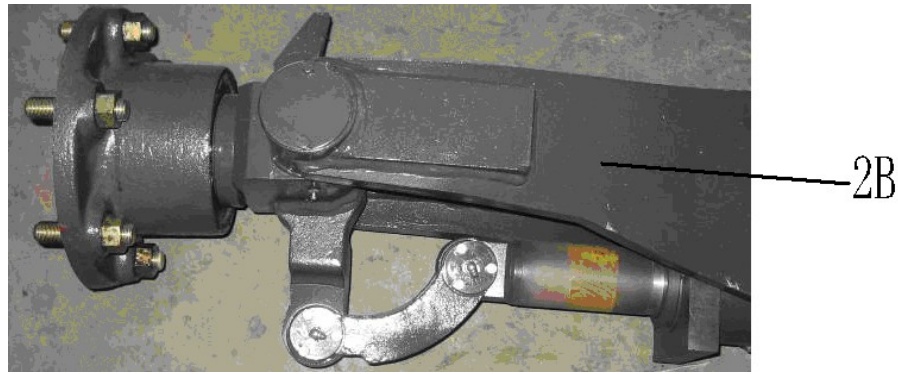

01-02-01

转向桥 STEERING WHEEL

01: CPCD50A (CD-AA) 04: CPCD50A (CD-FA)
 02: CPCD60A (CD-AA) 05: CPCD60A (CD-FA)
 03: CPCD70C (CD-AA) 06: CPCD70C (CD-FA)

序号 ITEM NO	零件编号 PART NO.	零件名称及规格 PART NAME & DESCRIPTION	数量 Q' TY						备注 REMARK
			适用车型 APPLICABLE SERIAL NO						
			01	02	03	04	05	06	
51	GB6173	螺母 M16X1.5 NUT M16X1.5	2	2	2	2	2	2	
52	A847.2B.2	后桥体 STEERING AXLE	1	1	1	1	1	1	
53	A8472B.3	转向节 (右) RIGHT STEERING KNUCKLE	1	1	1	1	1	1	
54	A847.2B-2	螺栓 BOLT	4	4	4	4	4	4	
55	GB93	垫圈 WASHER	4	4	4	4	4	4	
56	A847.2B.1	转向节 (左) LEFT STEERING KNUCKLE	1	1	1	1	1	1	
57	GB6173	螺母 M12×1.5 NUT M12×1.5	2	2	2	2	2	2	
58	A847.2B-9	螺栓 BOLT	2	2	2	2	2	2	
59	GB93	垫圈 6 WASHER 6	8	8	8	8	8	8	
60	GB5781	螺栓 M6×12 BOLT M6×12	8	8	8	8	8	8	
61	A847.2-5	挡环 STOPPER RING	2	2	2	2	2	2	
62	120-3104020	油封 OIL SEAL	2	2	2	2	2	2	
63	GB/T 297-1994	滚动轴承 BEARING	2	2	2	2	2	2	
64	GB/T 297-1994	滚动轴承 BEARING	2	2	2	2	2	2	
65	A847.2-2	螺母 NUT	4	4	4	4	4	4	
66	A847.2-3	制动垫片 SAFETY WASHER	2	2	2	2	2	2	
67	A847.2-8	轮毂 WHEEL HUB	2	2	2	2	2	2	
68	A847.2-7	轮毂螺帽 WHEEL HUB NUT	12	12	12	12	12	12	
69	A847.2-6	轮毂螺柱 WHEEL HUB STUD	12	12	12	12	12	12	
70	A847.12.1-3	轮毂螺母 WHEEL HUB NUT	12	12	12	12	12	12	
71	A847.2-19	垫 GASKET	2	2	2	2	2	2	
72	A847.2-1	轴头盖 CAP	2	2	2	2	2	2	
73	GB93	垫圈 8 LOCK WASHER 8	12	12	12	12	12	12	
74	GB5780	螺栓 M8×16 BOLT M8×16	12	12	12	12	12	12	
75	GB1152-1989	油杯 M10×1 GASKET NIPPLE	4	4	4	4	4	4	
76	A847.2-9	盖板 CAP	4	4	4	4	4	4	

77	A847.2-13	垫片 GASKET	2	2	2	2	2	2	
78	GB301-1964	轴承 8208 BEARING	2	2	2	2	2	2	
79	A847.2-12	转向节轴 KINNG PIN	2	2	2	2	2	2	
80	GB290-1982	滚动轴承 BEARING	8	8	8	8	8	8	
81	A847.2B-11	隔套 SPASER	4	4	4	4	4	4	
82	A847.2B-6	隔套 SPASER	8	8	8	8	8	8	
83	GB9163-1990	关节轴承 GE25ES-2RS SPHERICAL PLAIN BEARINGS	4	4	4	4	4	4	
84	A847.2B-3	连接座 COUPLING SEAT	2	2	2	2	2	2	
85	A847.2B.4	轴 SHAFT	4	4	4	4	4	4	
86	GB5781	螺栓 M6×12 BOLT M6×12	12	12	12	12	12	12	
87	GB93	垫圈 6 LOCK WASHER 6	12	12	12	12	12	12	
88	A847.2B.00	转向桥 STEERING WHEEL	1	1	1	1	1	1	
89	A847.2C.00	转向桥 STEERING WHEEL	1	1	1	1	1	1	

说明：整机可装配的转向桥总成有两种：一种为转向桥总成（2B）；一种为转向桥总成（2C）。您在查阅这部分的零件目录时，请先确认您的叉车上安装的是哪一种。主机基本配置为转向桥总成（2B），而转向桥总成（2C）为选配。对应的转向桥总成零件目录共分两部分，请注意确认。为保证准确请您在选择备件时一定要提供整机出厂编号。由此造成的不便请您见谅！

SPECIFICATION: In this chapter, you can see two kinds of STEERING AXLE ASS' Y ,STEERING AXLE ASS' Y (2B) and STEERING AXLE ASS' Y (2C) .You need to know the type of the drive axle on your forklift truck, before reading this chapter. The host is basic to install to for STEERING AXLE ASS' Y (2 B), and STEERING AXLE ASS' Y (2 C) for choose kit. Right should of STEERING AXLE ASS'Y the spare parts catalogue totally is divided into two part,please watch for the confirmation.To avoid mistake, when ordering parts, give the DALIAN forklift trucks dealer or distributor the serial number of the forklift truck .Beg your pardon for the discomfort with it !