

图 12/FIG12

传动装置安装/DRIVE UNIT MOUNT

B3

序号 Item No	图号 Part No	零部件名称 Description	件数 Q'ty	备注 Remark
01	GB5785-86	Bolt 螺栓M10×1.25×45	13	
02	GB93-87	Washer 垫圈10	23	
03	GB5782-86	Bolt 螺栓M10×20	10	
04	124U2-50001A	Drive unit sub ass'y A 变速箱部件A	1	
05	124U2-50001B	Drive unit sub ass'y B 变速箱部件B	1	
06	GB5785-86	Bolt 螺栓M12×1.25×35	12	
07	GB93-87	Washer 垫圈12	12	
08	GB3452.1-92	O-ring O形圈400×5.3	1	
09	124T3-50001	Reduction & Differential 差速箱总成	1	
10	GB119-86	Pin 圆柱销10×20	35	
11	A32C3-80301	Oil elements 油路原理图	1	

CPCD40,45,50-L  
CPCD40,45,50-LF

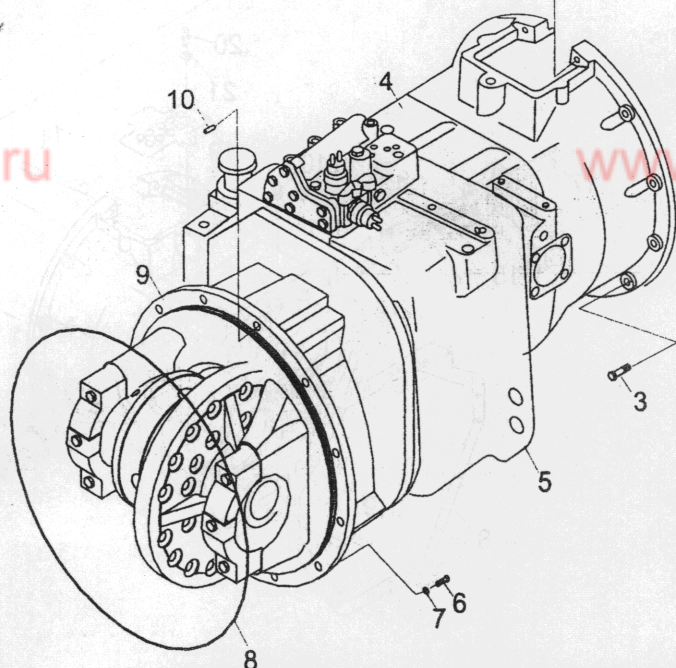
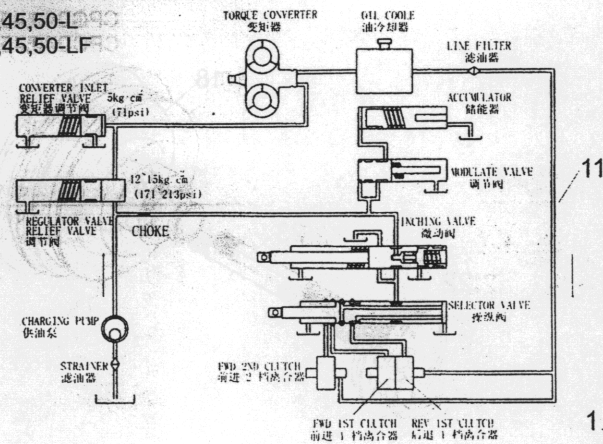

B4

变速箱 A / TRANSMISSION A

图13/FIG13

CPCD40,45,50-L  
CPCD40,45,50-LF

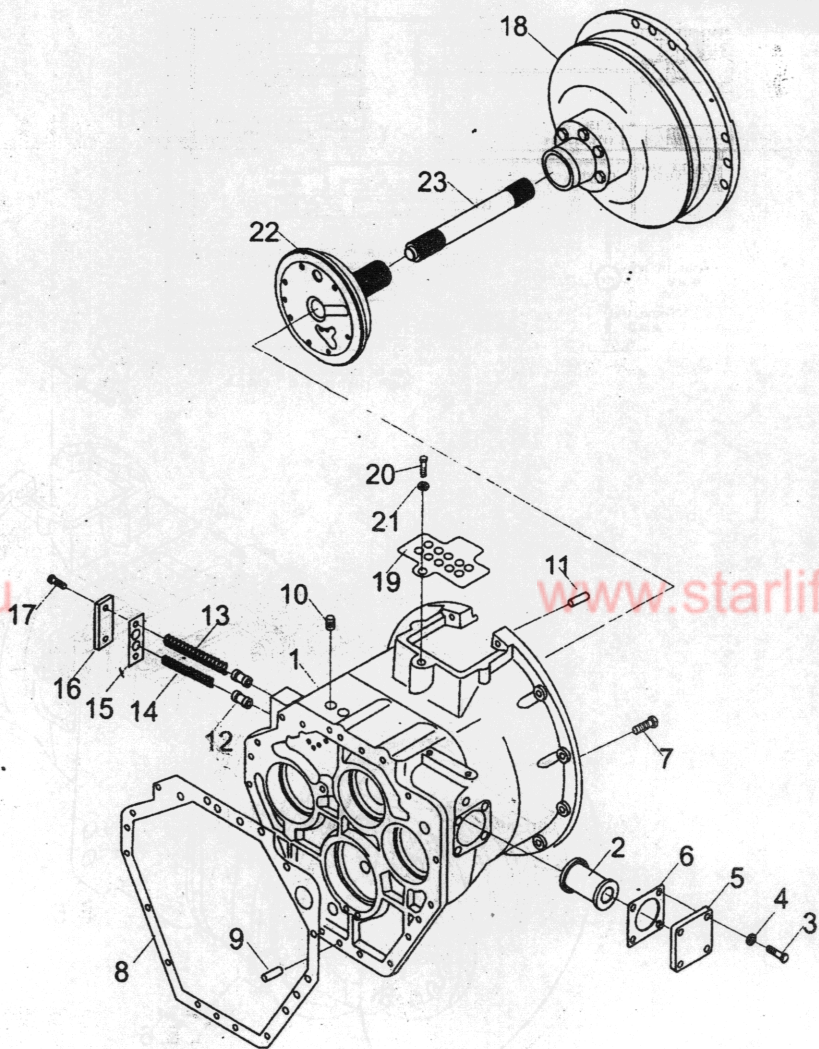

序号 Item No	图号 Part No	零部件名称 Description	件数 Q'ty	备注 Remark
A	124U2-50001A	Drive unit sub ass'y A	1	变速箱部件A
01	128E3-82001	Case,tor-con	1	4.5t变矩器壳体
02	124U3-82521	Oil filter	1	滤油器
03	GB5785-86	Bolt	4	螺栓M10×1.25×20
04	GB93-87	Washer	21	垫圈10
05	124U3-82081	Cover	2	盖板
06	124U3-82091	Shim	2	石棉垫
07	GB5895-86	Bolt	3	螺栓M10×1.25×95
-	GB5785-86	Bolt	10	螺栓M10×1.25×30
-	GB5785-86	Bolt	2	螺栓M10×1.25×70
08	124U3-82101	Shim	1	垫片
09	GB119-86	Pin	2	圆柱销B10×20
10	24329-45541	Plug	2	螺塞(3/8")
11	124U3-82431	Pin	2	圆柱销
12	15943-82271	Piston	2	活塞
13	12943-82281	Spring	1	弹簧
14	12943-82291	Spring	1	弹簧
15	12943-82311	Shim	1	垫片
16	12943-82301	Cover	1	盖板
17	GB5785-86	Bolt	2	螺栓M10×1.25×25
18	124U3-80211	Clutch,hydraulic	1	液力变矩器
19	124U3-82311	Cover	1	盖板
20	GB5781-86	Bolt	1	螺栓M16×25
21	GB93-87	Washer	1	垫圈16
22	124U3-80221	Charging pump	1	供油泵
23	124U3-82041	Shaft,turbo	1	涡轮轴



图14/FIG14

## 变速箱B / TRANSMISSION B

B5

序号 Item No	图号 Part No	零部件名称 Description	件数 Q'ty	备注 Remark
A	124U2-50001B	Drive unit sub ass'y 变速箱部件B	1	
01	YDS45.001	Case,transmission 4.5t变速箱箱体	1	
02	YQX100.045	Plug 螺塞(3/4")	2	
03	23870-52781	Plug 螺塞(1/8")	12	
04	GB93-87-8	Washer 垫圈B	8	
05	GB5782-86	Bolt 螺栓M8×65	4	
06	YDS45.903	Control valve,ass'y 控制阀总成	1	
07	GB5782-86	Bolt 螺栓M8×80	1	
08	GB5782-86	Bolt 螺栓M8×55	3	
09	YQX100.011	Plug 阻尼螺塞(1/8")	1	
10	YDS30.102	Plug 螺塞(3/8")	4	
11	YDS30.909	Dipstick 油标	1	
12	YDS45.073	Pipe,oil fil 加油管	1	
13	YDS45.078	Shim 垫片	1	
14	YDS45.901	Clutch 离合器I	1	
15	YDS45.807	Pipe 吸油管总成	1	
16	GB3452.1-92	O-ring seal O型圈37×3.1	1	
17	GB3452.1-92	O-ring seal O型圈30×3.1	1	
18	GB894.1-86	Snap ring 挡圈35	1	
19	YDS45.902	Clutch 离合器II	1	
20	YDS45.063	Clip 固定卡板	1	
21	GB5782-86	Bolt 螺栓M10×10	1	
22	GB93-87	Washer 垫圈10	1	
23	YDS45.077	Plate 挡板	1	
24	GB93-87	Washer 垫圈8	2	
25	GB5783-86	Bolt 螺栓M8×1.25×16	2	
26	GB/T276-94	Bearing 轴承6214	2	
27	YDS45.903	Gear 大齿轮	1	
28	GB894.1-86	Snap ring 挡圈70	1	
29	GB/T276-94	Bearing 轴承6308	1	

CPCD40,45,50-L  
CPCD40,45,50-LF



图15/FIG15

## 液力离合器1/HYDRAULIC CLUTCH 1

B6

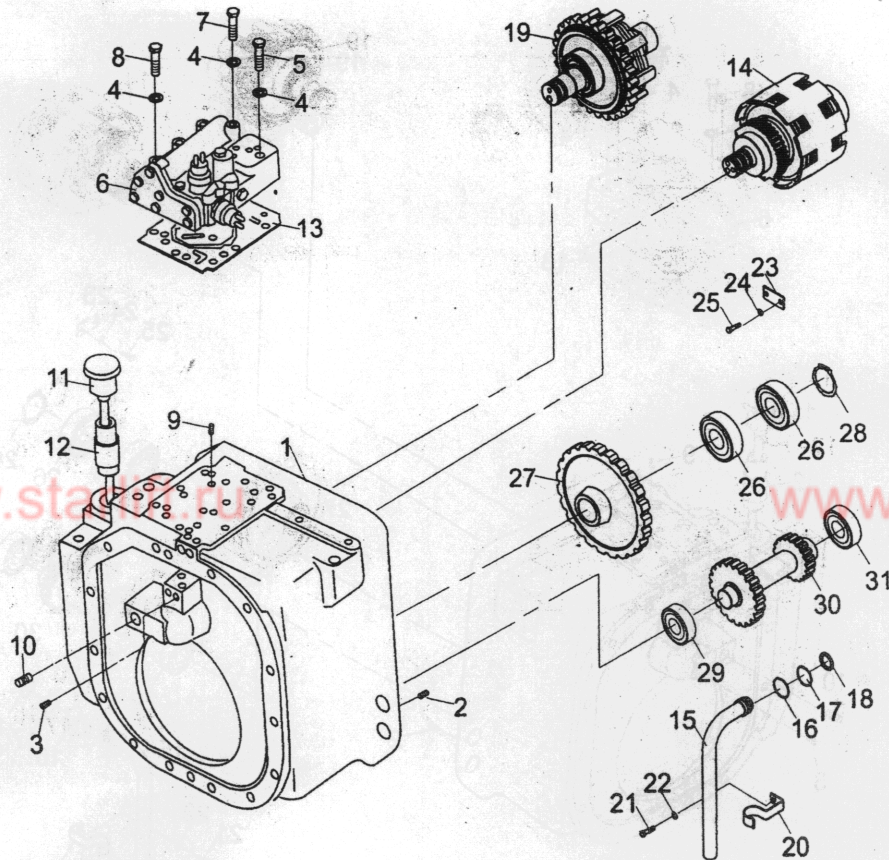
序号 Item No	图号 Part No	零部件名称 Description	件数 Q'ty	备注 Remark
A	128E3-80231	Clutch	离合器1	1
01	YDS45.805	Shaft ass'y	轴总成	1
02	YDS45.043	Ring, seal	密封圈	3
03	GB894.1-86	Snap, ring	挡圈40	1
04	YDS45.038	Bearing	轴承308(90×40×23)	1 GB276-82
05	YQX100.059	Ring, thrust	止推环	1
06	YDS45.036	Gear, reverse	后退齿轮	1
07	GB894.1-86	Ring, thrust	止推环	2
08	GB894.1-86	Snap, ring	挡圈50	4
09	YQX100.063	Seat, spring	弹簧座	2
10	YDS45.038	Spring	弹簧	2
11	YQX100.073	Ring, seal	密封环	2
12	YDS45.635	Piston	活塞	2
13	YDS45.040	Plate, separator	隔片	12
14	YQX100.068	Ring, seal	密封环	2
15	YDS45.041	Plate, friction ass'y	摩擦片总成	12
16	YDS45.042	Plate, separator	隔板	2
17	YQX100.070	Ring, snap	卡环	2
18	YDS45.037	Gear, forward	前进齿轮1	1
19	YQX100.062	Ring, thrust	止推环	1
20	GB276-82	Bearing	轴承310(110×50×27)	1
21	124U3-82261	Ring	支撑环	1
22	GB5846-86	Needle, bearing	滚针轴承	2
23	YDS30.102	Plug	螺塞	2
24	YDS30.006	Plug	塞	2
25	GB308-89	Body	钢球1/8"	2

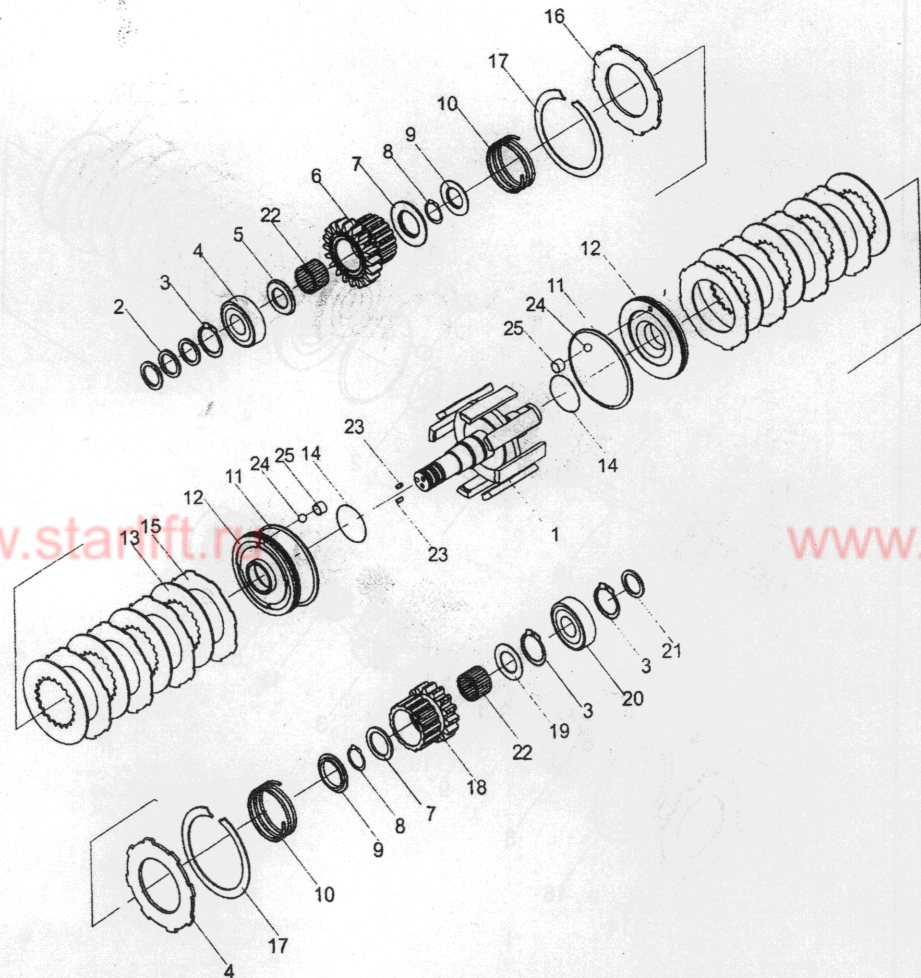
CPCD40,45,50-L  
CPCD40,45,50-LF

B7

液力离合器2/HYDRAULIC CLUTCH 2

图16/FIG16

CPCD40,45,50-L  
CPCD40,45,50-LF

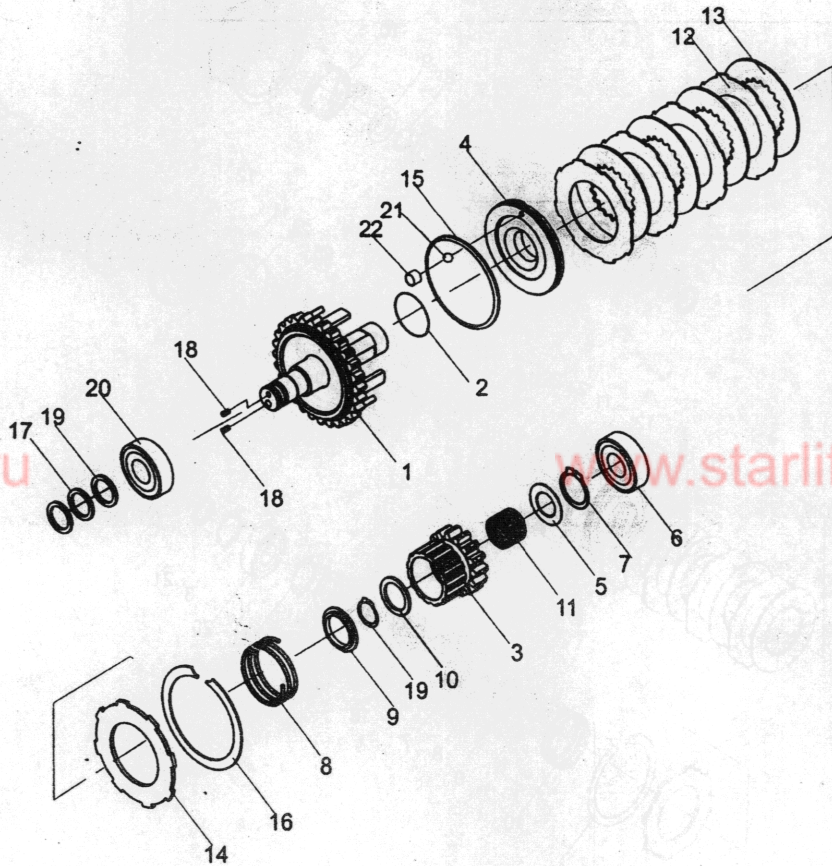

序号 Item No	图号 Part No	零部件名称 Description	件数 Q'ty	备注 Remark
A	128E3-80251	Clutch	离合器II	1
01	128E3-80261	Shaft ass'y	轴总成	1
02	15943-82481	Ring,seal	密封环	1
03	128E3-82101	Gear,forward	前进齿轮	1
04	15943-82851	Piston	活塞	1
05	15943-82421	Ring,thrust	半推环	1
06	GB276-82	Bearing	轴承310(110×50×27)	1
07	GB894.1-86	Snap,ring	挡圈50	2
08	15943-82391	Spring	弹簧	1
09	15943-82401	Seat,spring	弹簧座	1
10	15943-82411	Ring,thrust	止推环	1
11	124U3-82251	Needle,bearing	滚针轴承	1
12	124U3-82351	Plate,separator	摩擦片总成	6
13	124U3-82361	Plate,end	隔片	6
14	15943-82471	Ring,seal	端板	1
15	15943-82491	Snap,ring	密封环	1
16	15943-82511	Ring,seal	卡环	1
17	15943-82501	Ring,seal	密封环	2
18	23870-52871	Plug	螺塞	1
19	GB894.1-86	Snap ring	挡圈40	1
20	GB276-82	Bearing	轴承308(90×40×23)	1
21	11243-82121	Plug	塞	1
22	GB37-77	Body	钢球1/8"	1

图 17/FIG17

## 控制阀/CONTROL VALVE

B8

序号 Item No	图号 Part No	零部件名称 Description	件数 Q'ty	备注 Remark
A	128E3-80271	Control valve, ass'y	控制阀总成	1
01	YDS45.056	Cover, valve	阀端盖	11
02	YDS45.057	Gasket	端盖垫片	1
03	YDS45.049	Body, valve	阀体	1
04	YDS30.055	Plug	螺塞	1
05	Q/301B202	Washer	垫圈	1
06	YQX100.088	Spring	弹簧	1
07	GB308-89	Ball, steel	钢球 13/32'	4
08	23870-52871 (REF341231)	Plug	螺塞	7
09	GB5783-86	Bolt	螺栓 M8 × 25	7
10	GB93-87	Washer, lock	弹簧垫圈 8	1
11	YQX100.095	Piston	活塞	1
12	YBS5.308	Spring	弹簧	1
13	YBS5.307	Spring	弹簧	1
14	YQX100.097	Stopper	止动杆	1
15	YBS5.306	Spring	弹簧	1
16	YBS5.312	Spring	弹簧	1
17	YBS5.311	Spring	弹簧	1
18	YDS30.044	Spring	弹簧	1
19	YDS45.050	Selector	滑阀	1
20	YDS45.054	Washer	垫圈	1
21	YDS45.051	Plunger	阀杆	1
22	DS45.006	Spring	弹簧	1
23	YQX100.096	Plunger	调节阀杆	1
24	GB97.1-85	Washer	垫圈	1
25	GB893.1-86	Snap, ring	挡圈 30	1
26	HG4-692-67	Seal, oil	油封 SG14 × 30 × 10	2
-	15943-82661	Seal, oil	油封 SG14 × 30 × 10	2
27	GB119-86	Plug	闷塞	1
28	JK611B	Reverse lamp switch	后退灯开关	2

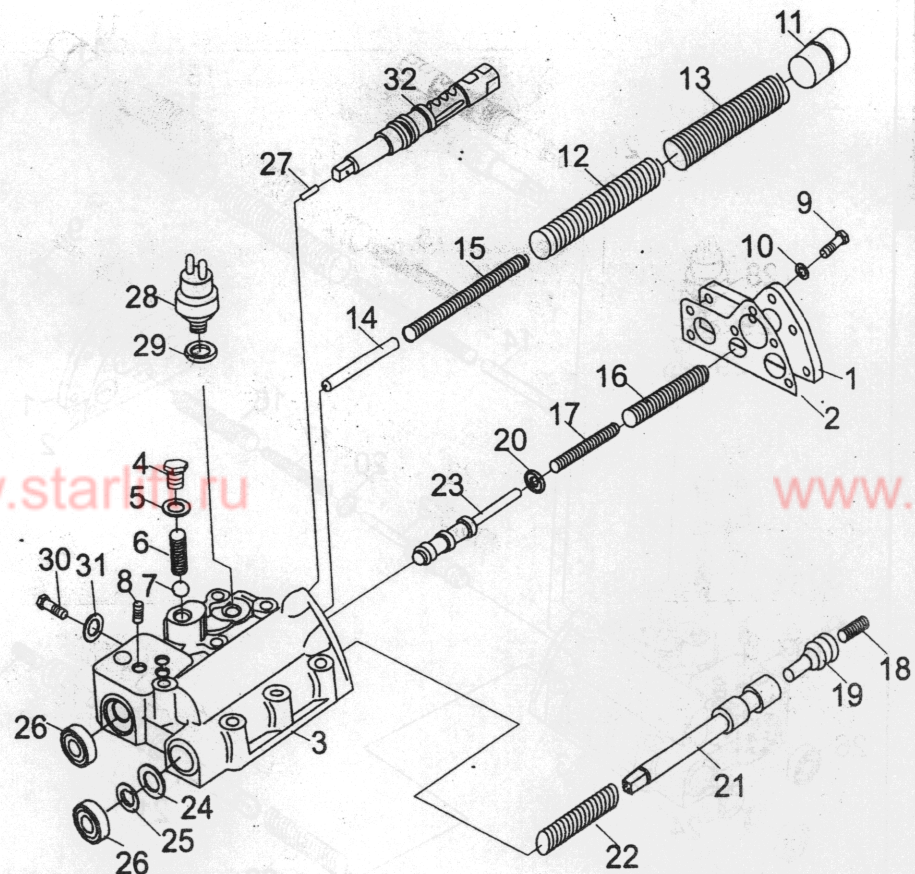
CPCD40,45,50-L  
CPCD40,45,50-LF

21





图18/FIG18

减速器和差速器/REDUCTION & DIFFERENTIAL

B9

序号 Item No	图号 Part No	零部件名称 Description	件数 Qty	备注 Remark
A	124T3-50001	Differential, ass'y	1	差速器总成
01	YDS45.003	Case, differential	1	主减速器壳体
02	YDS45.007	Case, cross L.H	1	差速器左壳体
03	GB6171-86	Nut	12	螺母M14×1.5
04	YDS45.010	Bolt	12	螺栓
05	TDS45.018	Bolt	2	螺栓10×1.25
06	GB93-87-10	Washer	2	垫圈10
07		Iron, silk	2	铁丝1.0×100
08	YDS45.017	Plate, lock	2	锁片
09	YDS45.016	Nut	2	调整螺母
10	GB/T297-74	Bearing, taper roller	2	圆锥滚子轴承200716
11	YDS45.015	Shim	1	垫圈
12	YDS45.012	Gear, pinion	2	半轴齿轮
13	YDS45.013	Shaft, cross	1	十字轴
14	YDS45.019	Gear, spiral beve	1	螺旋伞齿轮
15	YDS45.014	Ring, thrus	4	止推垫圈
16	GB/T283-94	Bearing, taper roller	1	圆柱滚子轴承32306
17	GB5785-86	Bolt	16	螺栓M14×1.5×50
18	GB6173-86	Nut	1	螺母M27×2
19	YDS45.021	Shim, lock	1	双耳止动垫圈
20	YD45.020	Shaft	1	螺柱
21	YDS45.022	Plate	1	滑块
22	YDS45.025	Shim	1	调整垫片
23	GB576-86	Bolt	6	螺栓M14×1.5×40
24	GB93-87	Washer	6	垫圈14
25	YDS45.026	Shim	1	调整垫片
26	GB/T297-94	Bearing, taper roller	1	圆锥滚子轴承7311E
27	YDS45.028	Nut, lock	1	锁紧螺母
28	YDS45.023	Gear, output	1	主动螺旋伞齿轮
29	YDS45.027	Plate	1	隔套

CPCD40,45,50-L  
CPCD40,45,50-LF

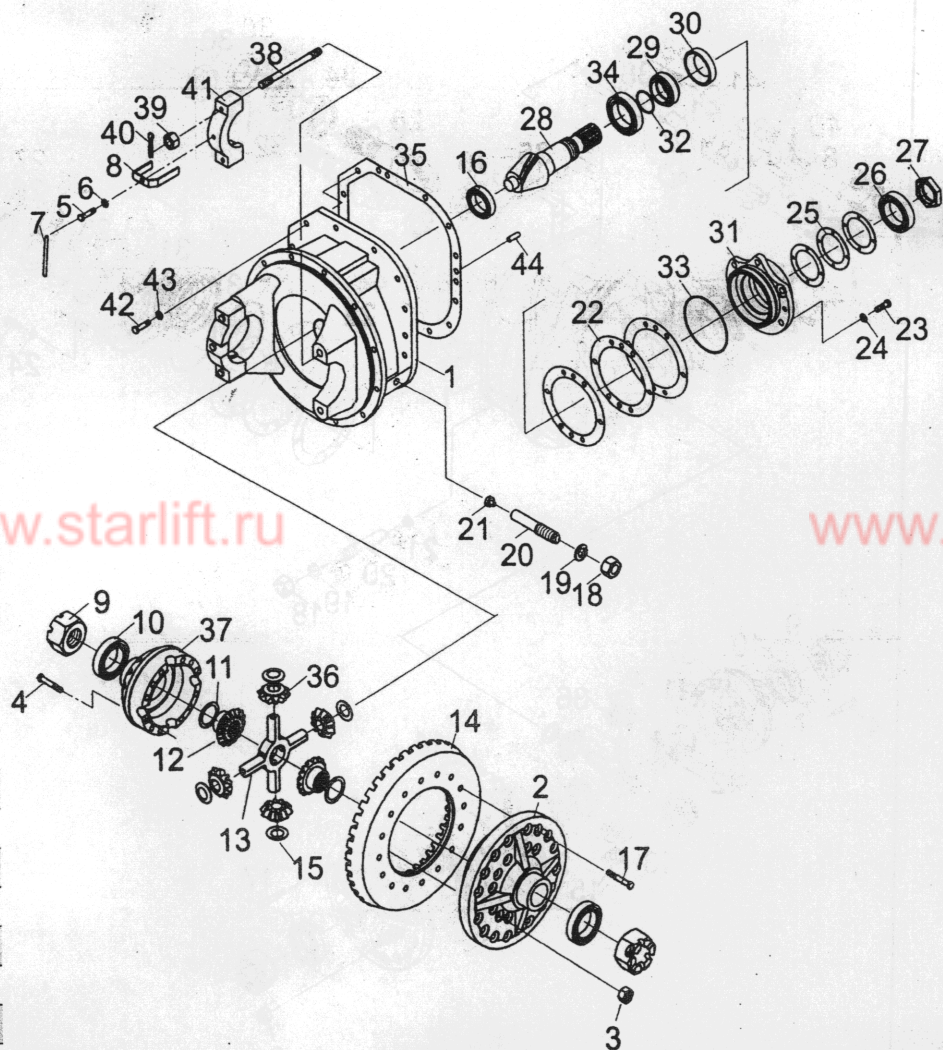

B9

减速器和差速器/REDUCTION & DIFFERENTIAL

图18/FIG18

CPCD40,45,50-L  
CPCD40,45,50-LF

序号 Item No	图号 Part No	零部件名称 Description	件数 Qty	备注 Remark
30	YDS45.029	Seal,oil 油封PD80×105×12	1	
31	YDS45.024	Seat,bearing 轴承座	1	
32	GB1235-76	O-ring O型圈60×3.1	1	
33	GB1235-76	O-ring O型圈150×3.1	1	
34	GB/T297-94	Bearing,taper roller 圆锥滚子轴承31312	1	
35	YDS45.072	Shim 密封垫	1	
36	YDS45.011	Gear,pinion 行星齿轮	4	
37	YDS45.008	Case,cross R.H 差速器右壳体	1	
38	YDS45.004	Bolt 盖用双头螺栓	4	
39	GB9457-88	Nut 螺母	4	
40	GB9-86	Pin 开口销4×36	4	
41	YDS45.004	Cover,bearing 轴承盖	2	
42	GB5786-86	Bolt 螺栓M12×1.25	14	
43	GB93-87-12	Washer 垫圈12	14	
44	GB119-86	Pin 销10×25	2	



图19/FIG19

## 供油泵 / CHARGING PUMP

B10

序号 Item No	图号 Part No	零部件名称 Description	件数 Q'ty	备注 Remark
A	124U3-80221	Charging Pump ass'y	1	供油泵总成
01	YDS45.070	Support, starter	1	定子
02	GB9877.1-88	Snap	1	骨架密封FB75×100×12
03	YDS45.066	Snap	1	矩形密封圈
04	YDS45.064	Case, pump	1	供油泵泵体
05	YDS45.067	Snap O-ring	1	O型密封圈195×3.55
06	YDS45.069	Gear, driven	1	供油泵被动齿轮
07	YDS45.810	Gear, drive	1	供油泵主动齿轮组件
08	124U3-82181	Bushing	1	衬套
09	YDS45.009	Bolt	7	螺栓M10×1.25×35
10	10JB987-77	Washing	9	垫圈
11	YDS45.053	Bolt	2	螺栓M10×1.25×35
12	GB119-86	Pin	2	圆柱销E10×26
13	Q/ZB285-77	Plug	1	螺塞ZG1/8"
14	6TY10-00-41	Decal	1	供油泵铭牌
15	GB827-86	Bolt	2	铆钉E2×4

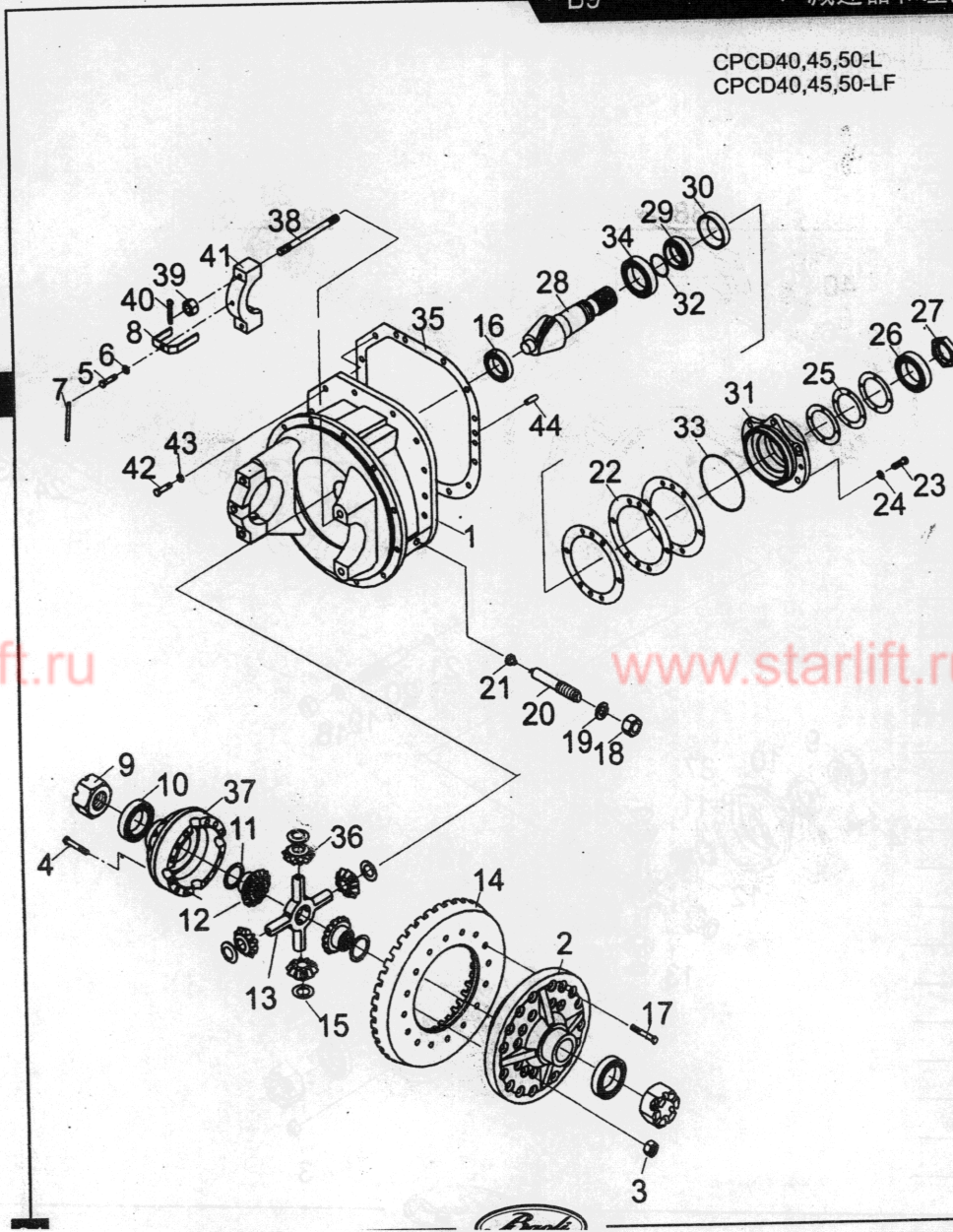
CPCD40,45,50-L  
CPCD40,45,50-LF