

15. 喷油器总成 INJECTOR ASSEMBLY

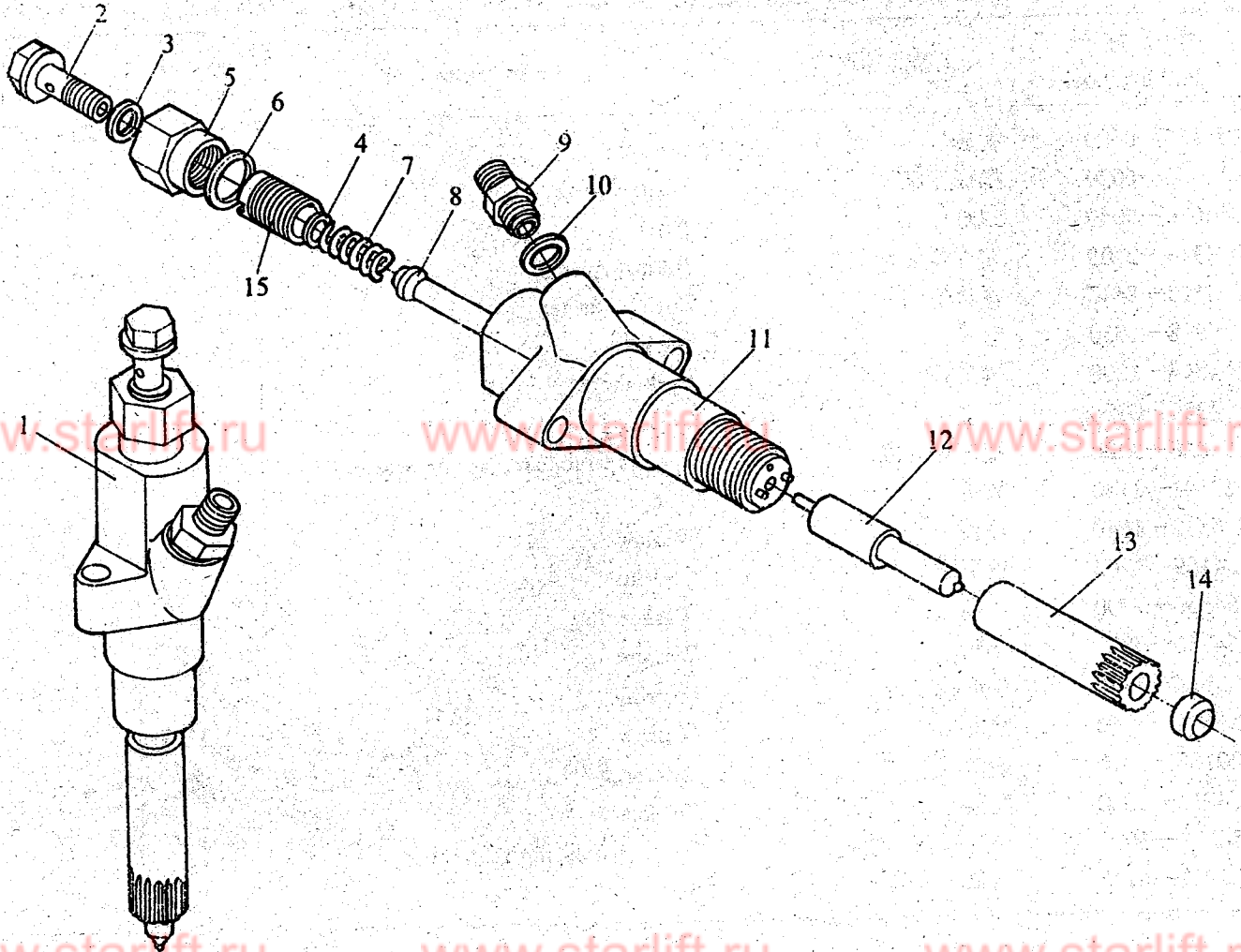

15. 喷油器总成 INJECTOR ASSEMBLY

| 序号<br>No. | 零部件号<br>Part Number | 零部件名称  | Part Name                 | 数量<br>Quantity | 备注<br>Remark |
|-----------|---------------------|--------|---------------------------|----------------|--------------|
|           |                     |        |                           | 6              |              |
| 1         | PQ6102 00           | 喷油器总成  | Injector assembly         | 1×6            |              |
| 2         | PQ6102 01           | 溢油接头螺钉 | Pipe joint bolt           | 2×6            |              |
| 3         | PQ6102 02           | 垫片     | Gasket                    | 1×6            |              |
| 4         | PQ6102 12           | 弹簧上垫   | Upper gasket              | 1×6            |              |
| 5         | PQ6102 03           | 螺帽     | Cap nut                   | 1×6            |              |
| 6         | PQ6102 11           | 垫片     | Gasket                    | 1×6            |              |
| 7         | PQ6102 05           | 调压弹簧   | Pressure adjusting spring | 1×6            |              |
| 8         | PQ6102 10           | 顶杆总成   | Push rod                  | 1×6            |              |
| 9         | PQ6102 09           | 进油管接头  | Connector                 | 1×6            |              |
| 10        | PQ6102 08           | 垫片     | Gasket                    | 1×6            |              |
| 11        | PQ6102 20           | 喷油器体总成 | Injector holder           | 1×6            |              |
| 12        | PQ6102 30—1         | 喷油嘴偶件  | Nozzle pair               | 1×6            |              |
| 13        | PQ6102 06           | 喷油器螺帽  | Injector nut              | 1×6            |              |
| 14        | PQ6102 07           | 锥形垫圈   | Cone washer               | 1×6            |              |
| 15        | PQ6102 04           | 调压螺钉   | Pressure apjusting screw  | 1×6            |              |